

SH 161: FROM IH 20 TO US 183
CSJs:
2964-01-013 (ENVIRONMENTAL)
2964-01-036 (ELECTRONIC TOLL COLLECTION)

PROJECT LENGTH= 10.8 MILES

DESIGN SPEED

MAIN LANES - 70 MPH - BASED ON URBAN INTERSTATE FREEWAY
RAMPS - 50 MPH - BASED ON MID RANGE
DIRECT CONNECTORS - 50 MPH - BASED ON MID RANGE
FRONTAGE ROADS - 45 MPH
CROSS STREETS - 45 MPH (30 MPH WHERE NOTED)

HIGHWAY CLASSIFICATION
URBAN FREEWAY

PROJECT LOCATION
FROM IH 20 TO US 183
CSJ: 2964-01-013
2964-01-036

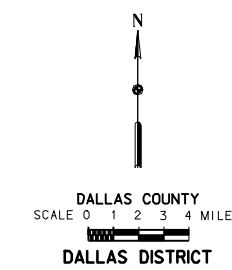
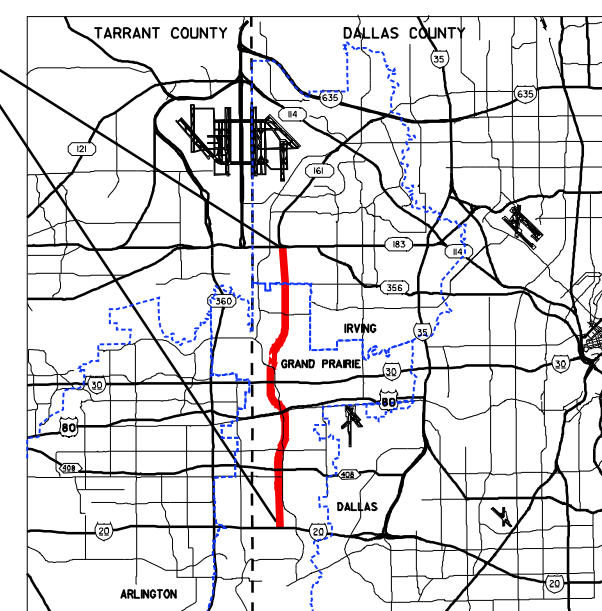

NAME SERIAL NO. XXXXX DATE: _____

REVIEWED BY HNTB:
ELIZABETH METTING, P.E.

SERIAL NO. 72425
DATE: _____

DATE APPROVED _____

NOT INTENDED FOR
CONSTRUCTION, BIDDING
OR PERMIT PURPOSES.

DATE SUBMITTED _____

DATE REVISED _____

TABLE OF CONTENTS:
PLANPROFILE ROLL
1-7

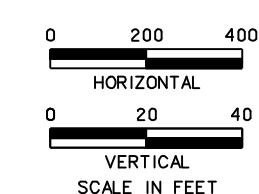

SEPTEMBER 2006

ROLL 6 OF 7

CONCEPTUAL TOLL PLAN SH 161 - FROM IH 20 TO SH 183

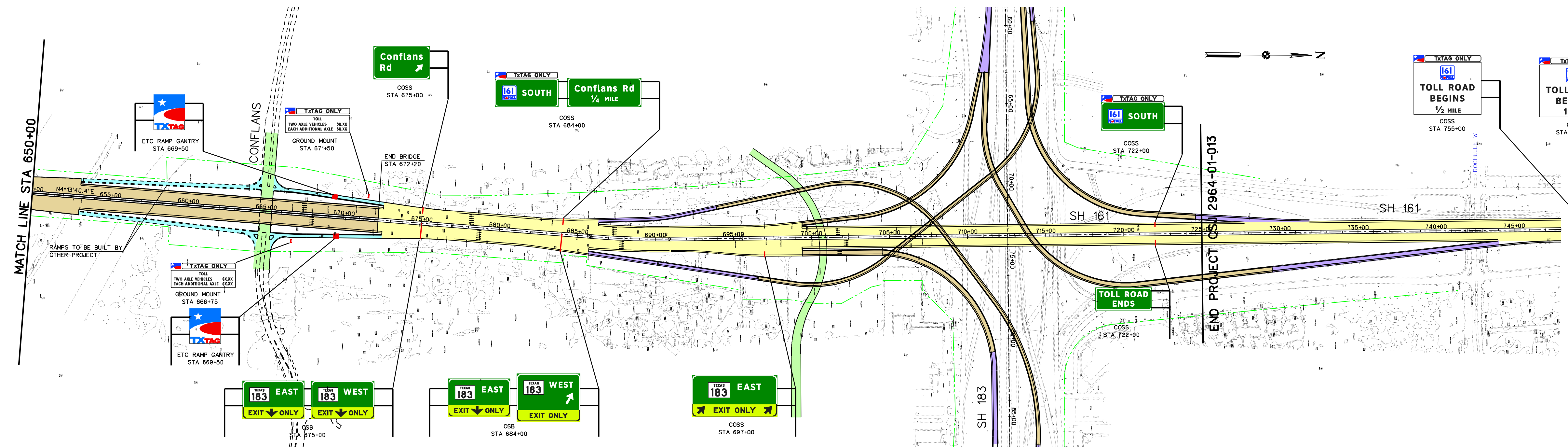

THESE ARE PRELIMINARY DESIGN CONCEPTS
Subject to change based on further developments
resulting from public input and technical review.

- NOTES:
- PROPOSED IMPROVEMENTS BASED ON MAIN LANE GEOMETRY FROM 1994 TxDOT APPROVED SCHEMATIC. FRONTAGE ROAD IMPROVEMENTS BASED ON CAD FILES SUPPLIED BY TxDOT FINAL DESIGN PLANS.
 - GANTRY LOCATIONS BASED ON TOLL TRAFFIC AND REVENUE STUDY BY WILBUR SMITH ASSOCIATES.
 - TRAFFIC PROJECTIONS SUPPLIED BY NORTH CENTRAL TEXAS COUNCIL OF GOVERNMENTS MOBILITY 2025, 2004 UPDATE, TRAFFIC MODEL USING TOLL SCENARIO.

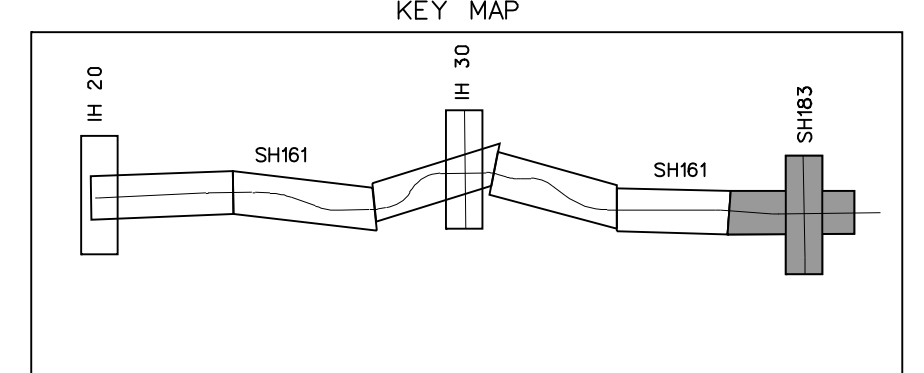
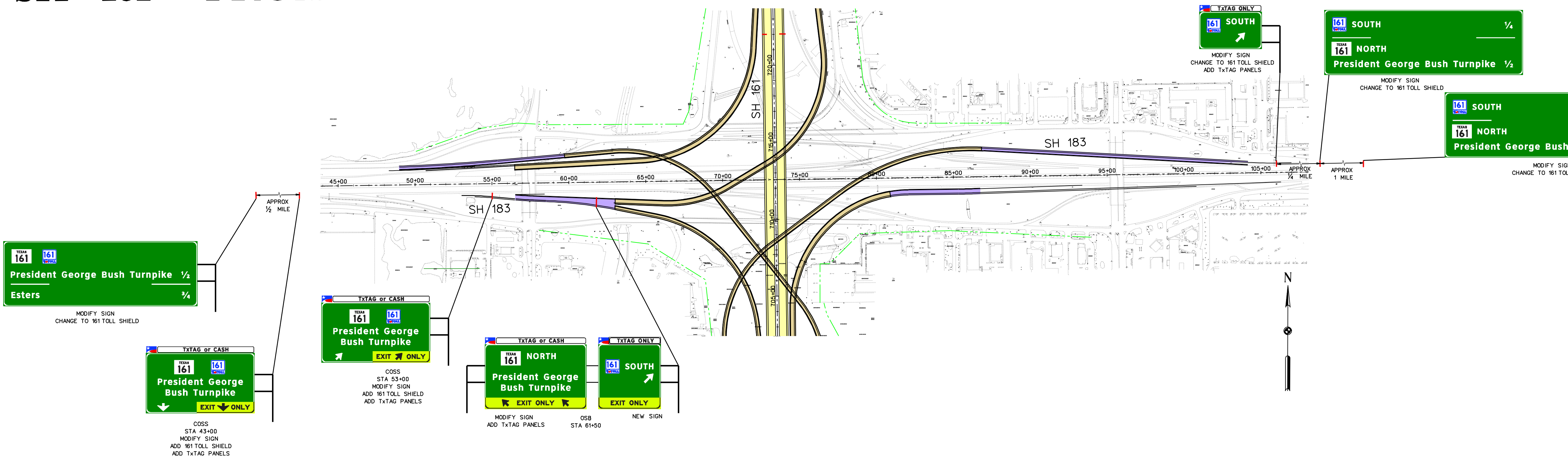
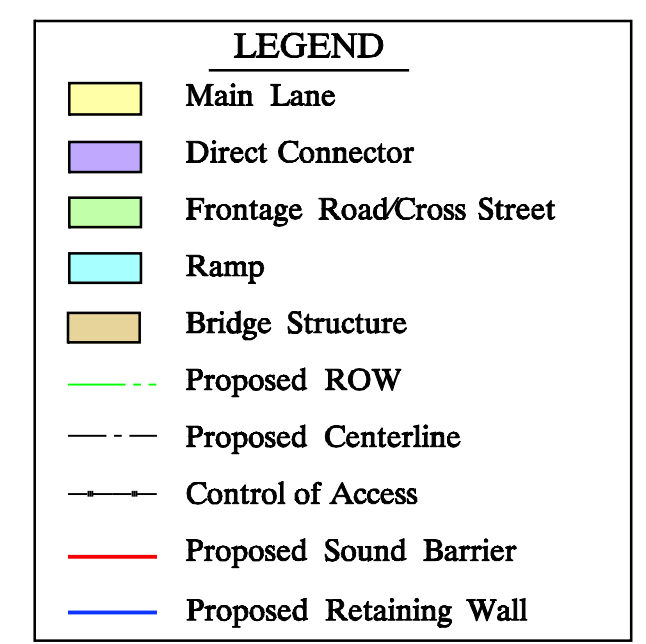

SH 161: FROM IH 20 TO US 183
CSJs:
2964-01-013 (ENVIRONMENTAL)
2964-01-036 (ELECTRONIC TOLL COLLECTION)

PROJECT LENGTH= 10.8 MILES

DESIGN SPEED

MAIN LANES - 70 MPH - BASED ON URBAN INTERSTATE FREEWAY
RAMPS - 50 MPH - BASED ON MID RANGE
DIRECT CONNECTORS - 50 MPH - BASED ON MID RANGE
FRONTAGE ROADS - 45 MPH
CROSS STREETS - 45 MPH (30 MPH WHERE NOTED)

HIGHWAY CLASSIFICATION
URBAN FREEWAY

PROJECT LOCATION
FROM IH 20 TO US 183
CSJ: 2964-01-013
2964-01-036

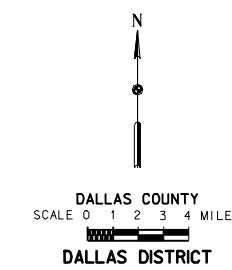
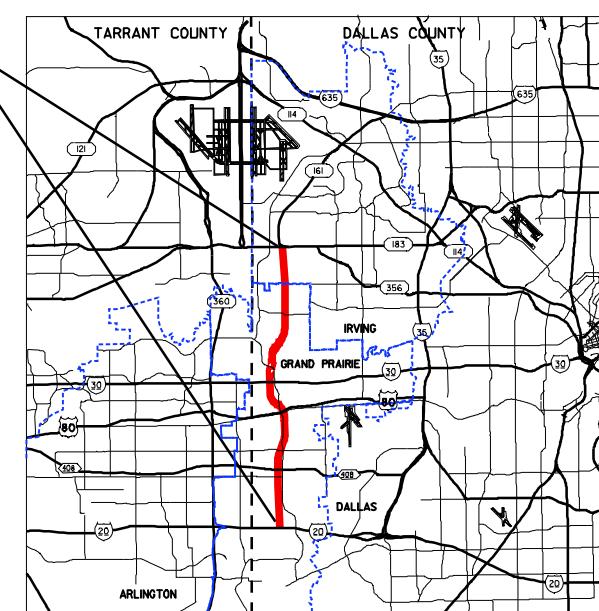

NAME SERIAL NO. XXXXX DATE: _____

REVIEWED BY HNTB:
ELIZABETH METTING, P.E.

SERIAL NO. 72425
DATE: _____

DATE APPROVED _____

NOT INTENDED FOR
CONSTRUCTION, BIDDING
OR PERMIT PURPOSES.

DATE SUBMITTED _____

DATE REVISED _____

TABLE OF CONTENTS:
PLANPROFILE ROLL
1-7

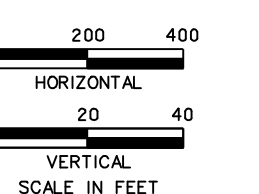

SEPTEMBER 2006

ROLL 6 OF 7