

SH 161: FROM IH 20 TO US 183  
 CSJs:  
 2964-01-013 (ENVIRONMENTAL)  
 2964-01-036 (ELECTRONIC TOLL COLLECTION)

PROJECT LENGTH= 10.8 MILES

**DESIGN SPEED**  
 MAIN LANES - 70 MPH - BASED ON URBAN INTERSTATE FREEWAY  
 RAMPS - 50 MPH - BASED ON MID RANGE  
 DIRECT CONNECTORS - 50 MPH - BASED ON MID RANGE  
 FRONTAGE ROADS - 45 MPH  
 CROSS STREETS - 45 MPH (30 MPH WHERE NOTED)

**HIGHWAY CLASSIFICATION**  
 URBAN FREEWAY

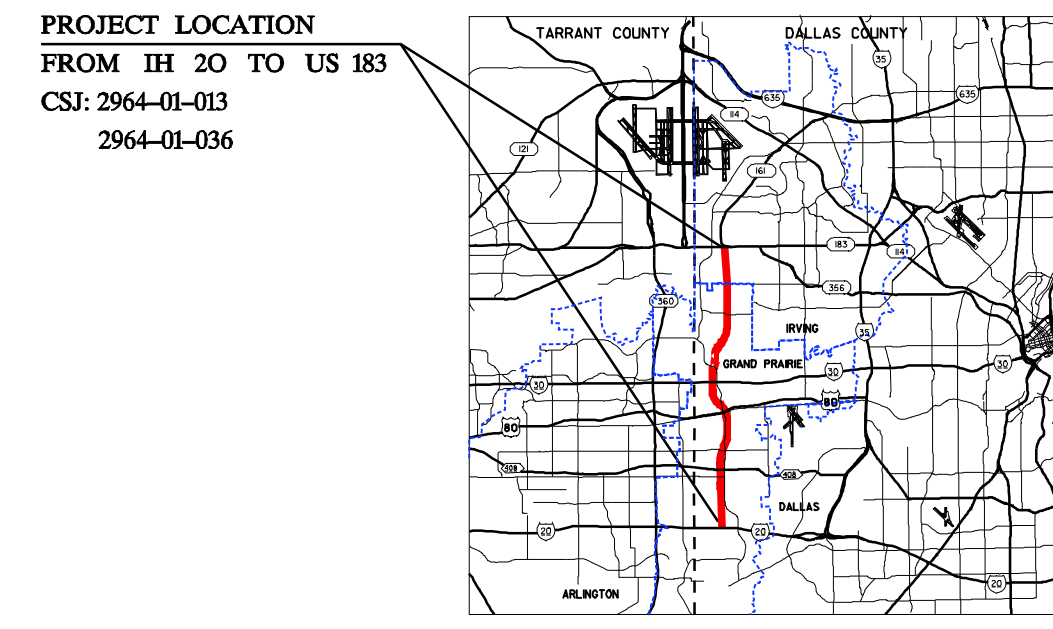

NAME	NAME
SERIAL NO. XXXXX DATE:	SERIAL NO. XXXXX DATE:
REVIEWED BY HNTB: ELIZABETH METTING, P.E.	REVIEWED BY HNTB: ELIZABETH METTING, P.E.
SERIAL NO. 72425 DATE:	SERIAL NO. 72425 DATE:
DATE APPROVED	DATE SUBMITTED
NOT INTENDED FOR CONSTRUCTION, BIDDING OR PERMIT PURPOSES.	NOT INTENDED FOR CONSTRUCTION, BIDDING OR PERMIT PURPOSES.
DATE REVISSED	DATE REVISSED
TABLE OF CONTENTS: PLAN/PROFILE ROLL 1-7	TABLE OF CONTENTS: PLAN/PROFILE ROLL 1-7
0 200 400 HORIZONTAL 0 20 40 VERTICAL SCALE IN FEET	0 200 400 HORIZONTAL 0 20 40 VERTICAL SCALE IN FEET
SEPTEMBER 2006	SEPTEMBER 2006
ROLL 7 OF 7	ROLL 7 OF 7

# CONCEPTUAL TOLL PLAN SH 161 - FROM IH 20 TO SH 183

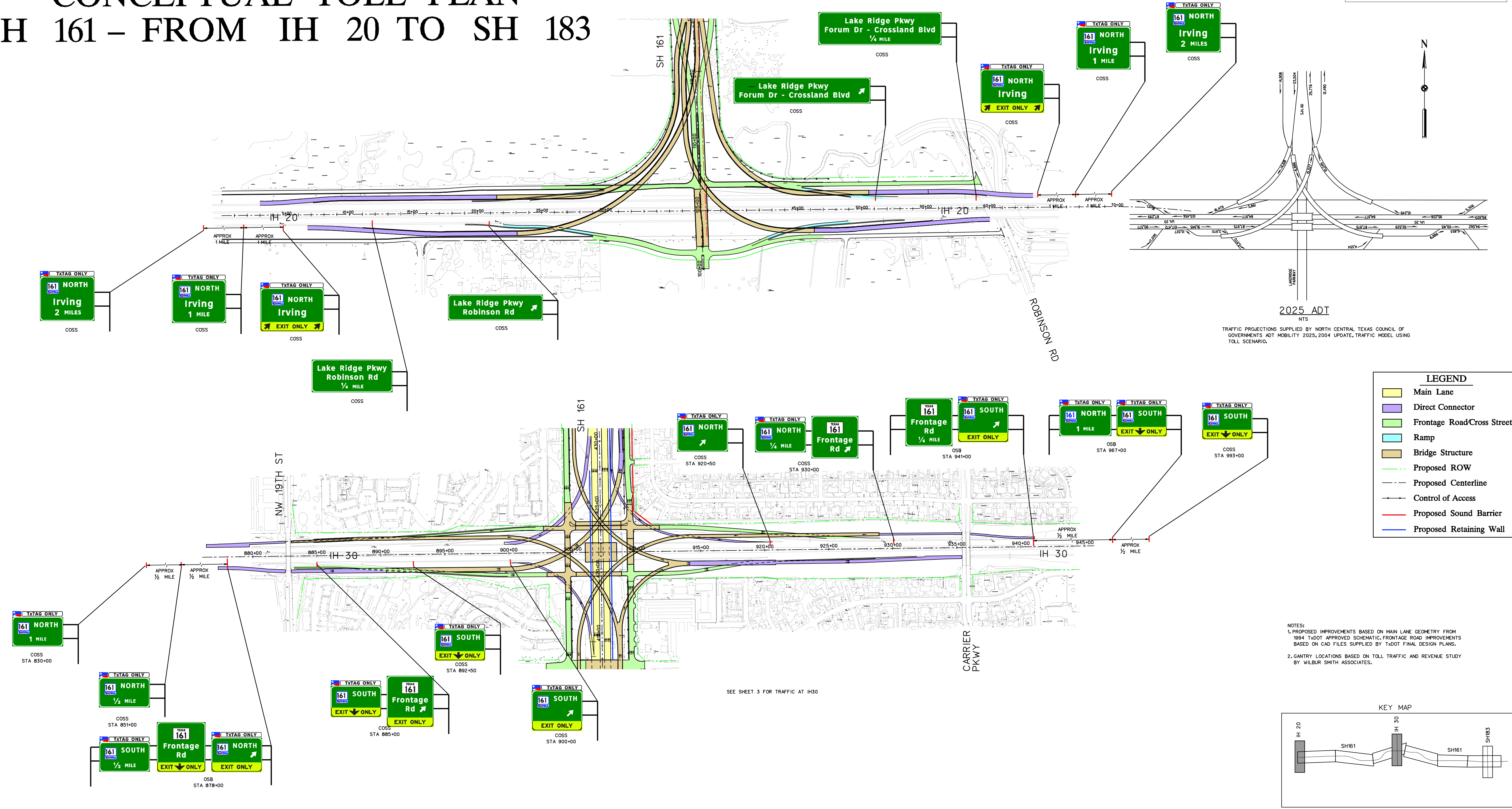

THESE ARE PRELIMINARY DESIGN CONCEPTS  
 Subject to change based on further developments  
 resulting from public input and technical review.

SH 161: FROM IH 20 TO US 183  
 CSJs:  
 2964-01-013 (ENVIRONMENTAL)  
 2964-01-036 (ELECTRONIC TOLL COLLECTION)

PROJECT LENGTH= 10.8 MILES

**DESIGN SPEED**  
 MAIN LANES - 70 MPH - BASED ON URBAN INTERSTATE FREEWAY  
 RAMPS - 50 MPH - BASED ON MID RANGE  
 DIRECT CONNECTORS - 50 MPH - BASED ON MID RANGE  
 FRONTAGE ROADS - 45 MPH  
 CROSS STREETS - 45 MPH (30 MPH WHERE NOTED)

**HIGHWAY CLASSIFICATION**  
 URBAN FREEWAY

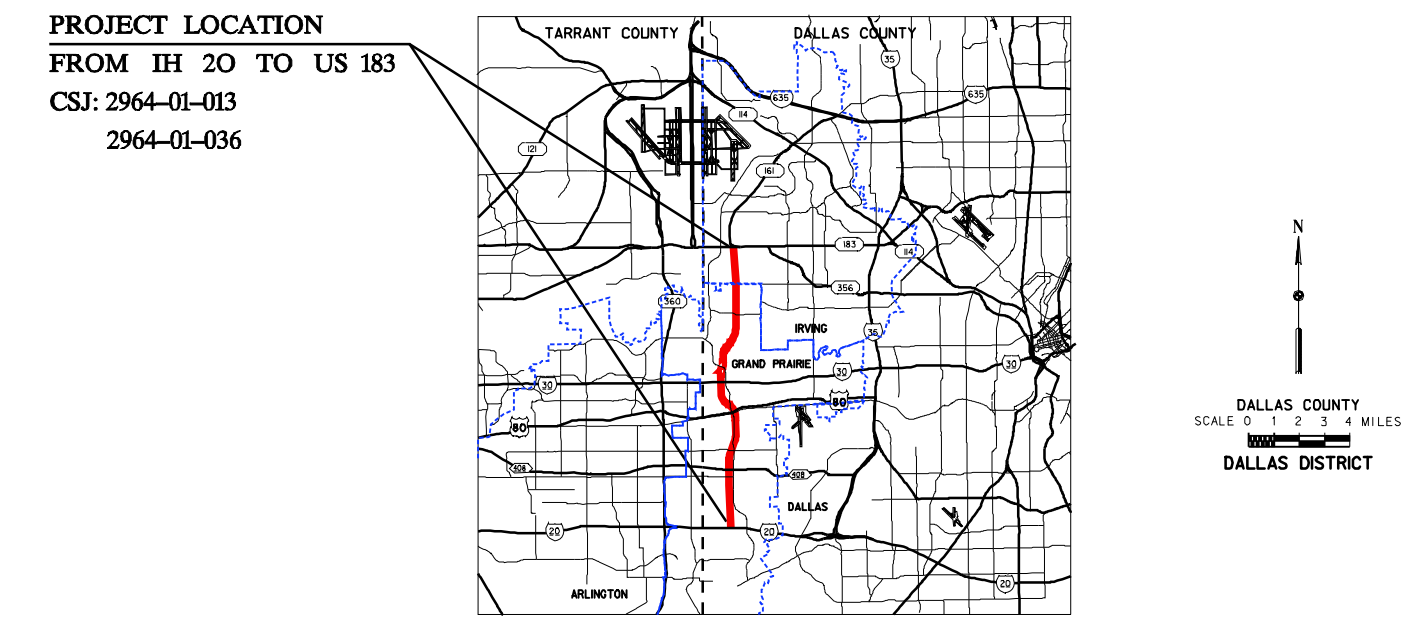

NAME	NAME
SERIAL NO. XXXXX DATE:	SERIAL NO. XXXXX DATE:
REVIEWED BY HNTB: ELIZABETH METTING, P.E.	REVIEWED BY HNTB: ELIZABETH METTING, P.E.
SERIAL NO. 72425 DATE:	SERIAL NO. 72425 DATE:
DATE APPROVED	DATE SUBMITTED
NOT INTENDED FOR CONSTRUCTION, BIDDING OR PERMIT PURPOSES.	NOT INTENDED FOR CONSTRUCTION, BIDDING OR PERMIT PURPOSES.
DATE REVISSED	DATE REVISSED
TABLE OF CONTENTS: PLAN/PROFILE ROLL 1-7	TABLE OF CONTENTS: PLAN/PROFILE ROLL 1-7
0 200 400 HORIZONTAL 0 20 40 VERTICAL SCALE IN FEET	0 200 400 HORIZONTAL 0 20 40 VERTICAL SCALE IN FEET
SEPTEMBER 2006	SEPTEMBER 2006
ROLL 7 OF 7	ROLL 7 OF 7