

**APPENDIX B: PROPOSED SCHEMATIC AND TYPICAL  
SECTIONS**



MATCH LINE STA 118+00

PROPOSED SB FRONTAGE ROAD

PROPOSED NB FRONTAGE ROAD

PROPOSED SH 161

WATER 1

ROW

ROW

BELT LINE ROAD

60+00

55+00

50+00

45+00

40+00

35+00

30+00

25+00

20+00

15+00

10+00

5+00

0+00

VINEYARD STREET

ROW

MATTHEW ROAD

CL IH 20

BEGIN PROJECT

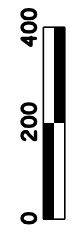

**LEGEND**

- ROW
- AIR RECEIVER LOCATION
- HISTORIC SITE
- HAZARDOUS MATERIAL SITE
- OBSERVATION POINT
- WETLAND AREA
- WATER AREA

Texas Department of Transportation

SH 161: FROM IH 20  
TO SH 183  
PROPOSED SCHEMATIC

CSJ: 2964-01-013  
County: Dallas  
State: Texas  
Application By: Texas Department of Transportation



MATCH LINE STA 175+00

Q PROPOSED SH 161

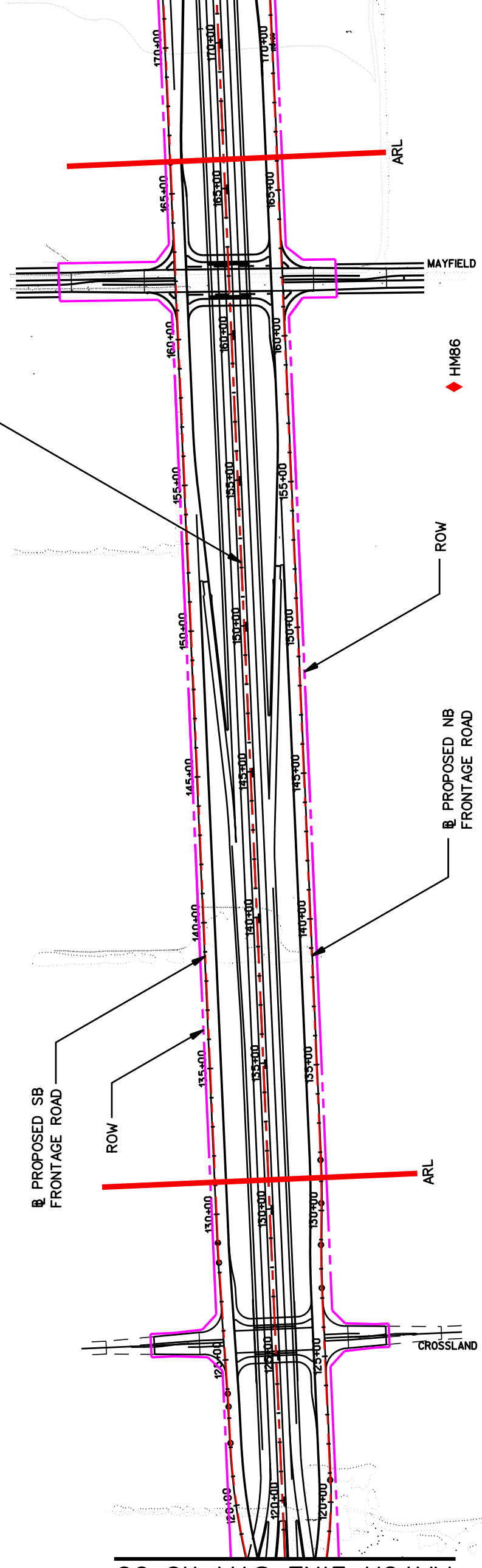

MATCH LINE STA 118+00



LEGEND	
	ROW
	AIR RECEIVER LOCATION
	HISTORIC SITE
	HAZARDOUS MATERIAL SITE
	OBSERVATION POINT
	WETLAND AREA
	WATER AREA

© 2004 Texas Department of Transportation

SH 161: FROM IH 20 TO SH 183

PROPOSED SCHEMATIC

CSJ: 2964-01-013  
 County: Dallas  
 State: Texas  
 Application By: Texas Department of Transportation

Sheet 2 of 9

MATCH LINE STA 223+00

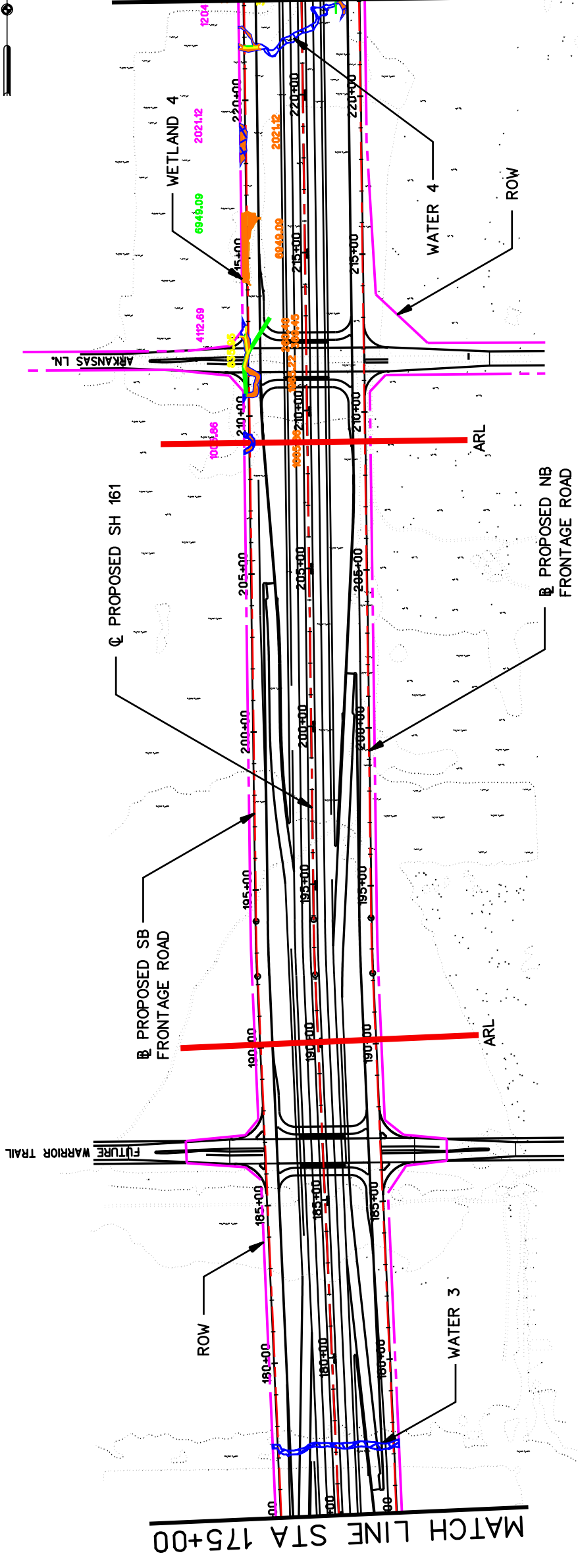

MATCH LINE STA 175+00

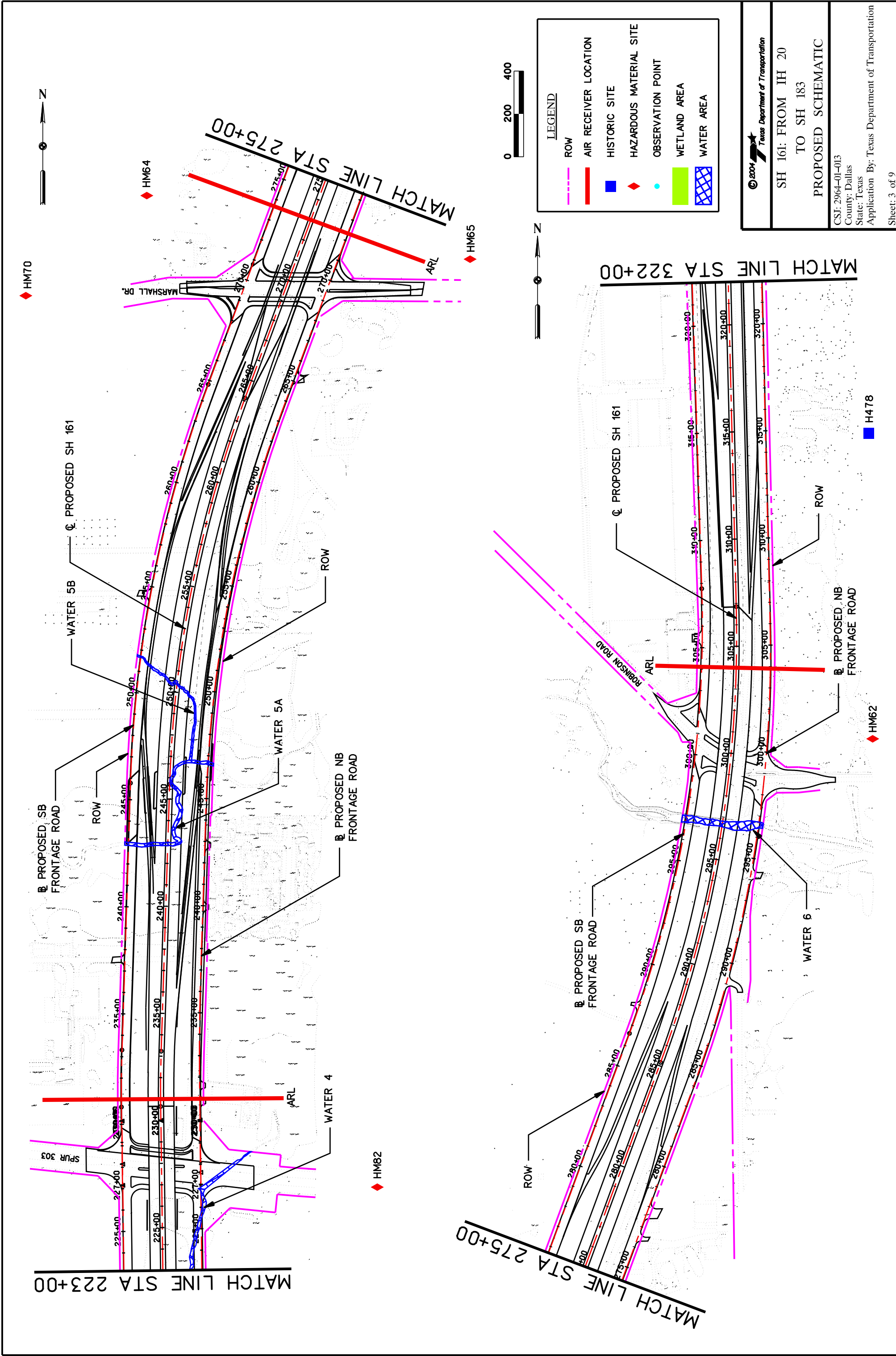

**LEGEND**

	ROW
	AIR RECEIVER LOCATION
	HISTORIC SITE
	HAZARDOUS MATERIAL SITE
	OBSERVATION POINT
	WETLAND AREA
	WATER AREA



© 2004 Texas Department of Transportation

SH 161: FROM IH 20  
TO SH 183  
PROPOSED SCHEMATIC

CSJ: 2964-01-013  
County: Dallas  
State: Texas  
Application By: Texas Department of Transportation

Sheet: 3 of 9

MATCH LINE STA 223+00

MATCH LINE STA 275+00

MATCH LINE STA 322+00

HM70

HM64

HM82

HM65

H478

HM62

PROPOSED SB FRONTAGE ROAD

PROPOSED NB FRONTAGE ROAD

PROPOSED SB FRONTAGE ROAD

PROPOSED NB FRONTAGE ROAD

WATER 5B

WATER 5A

WATER 4

WATER 6

MARSHALL DR.

ROBINSON ROAD

MATCH LINE STA 275+00

MATCH LINE STA 322+00

225+00

227+00

230+00

235+00

240+00

245+00

250+00

255+00

260+00

265+00

270+00

275+00

280+00

285+00

290+00

295+00

300+00

305+00

310+00

315+00

320+00

322+00

325+00

330+00

335+00

340+00

345+00

350+00

355+00

360+00

365+00

370+00

375+00

380+00

385+00

390+00

395+00

400+00

405+00

410+00

415+00

420+00

425+00

430+00

435+00

440+00

445+00

450+00

455+00

460+00

465+00

470+00

475+00

480+00

485+00

490+00

495+00

500+00

505+00

510+00

515+00

520+00

525+00

530+00

535+00

540+00

545+00

550+00

555+00

560+00

565+00

570+00

575+00

580+00

585+00

590+00

595+00

600+00

605+00

610+00

615+00

620+00

625+00

630+00

635+00

640+00

645+00

650+00

655+00

660+00

665+00

670+00

675+00

680+00

685+00

690+00

695+00

700+00

705+00

710+00

715+00

720+00

725+00

730+00

735+00

740+00

745+00

750+00

755+00

760+00

765+00

770+00

775+00

780+00

785+00

790+00

795+00

800+00

805+00

810+00

815+00

820+00

825+00

830+00

835+00

840+00

845+00

850+00

855+00

860+00

865+00

870+00

875+00

880+00

885+00

890+00

895+00

900+00

905+00

910+00

915+00

920+00

925+00

930+00

935+00

940+00

945+00

950+00

955+00

960+00

965+00

970+00

975+00

980+00

985+00

990+00

995+00

1000+00

1005+00

1010+00

1015+00

1020+00

1025+00

1030+00

1035+00

1040+00

1045+00

1050+00

1055+00

1060+00

1065+00

1070+00

1075+00

1080+00

1085+00

1090+00

1095+00

1100+00

1105+00

1110+00

1115+00

1120+00

1125+00

1130+00

1135+00

1140+00

1145+00

1150+00

1155+00

1160+00

1165+00

1170+00

1175+00

1180+00

1185+00

1190+00

1195+00

1200+00

1205+00

1210+00

1215+00

1220+00

1225+00

1230+00

1235+00

1240+00

1245+00

1250+00

1255+00

1260+00

1265+00

1270+00

1275+00

1280+00

1285+00

1290+00

1295+00

1300+00

1305+00

1310+00

1315+00

1320+00

1325+00

1330+00

1335+00

1340+00

1345+00

1350+00

1355+00

1360+00

1365+00

1370+00

1375+00

1380+00

1385+00

1390+00

1395+00

1400+00

1405+00

1410+00

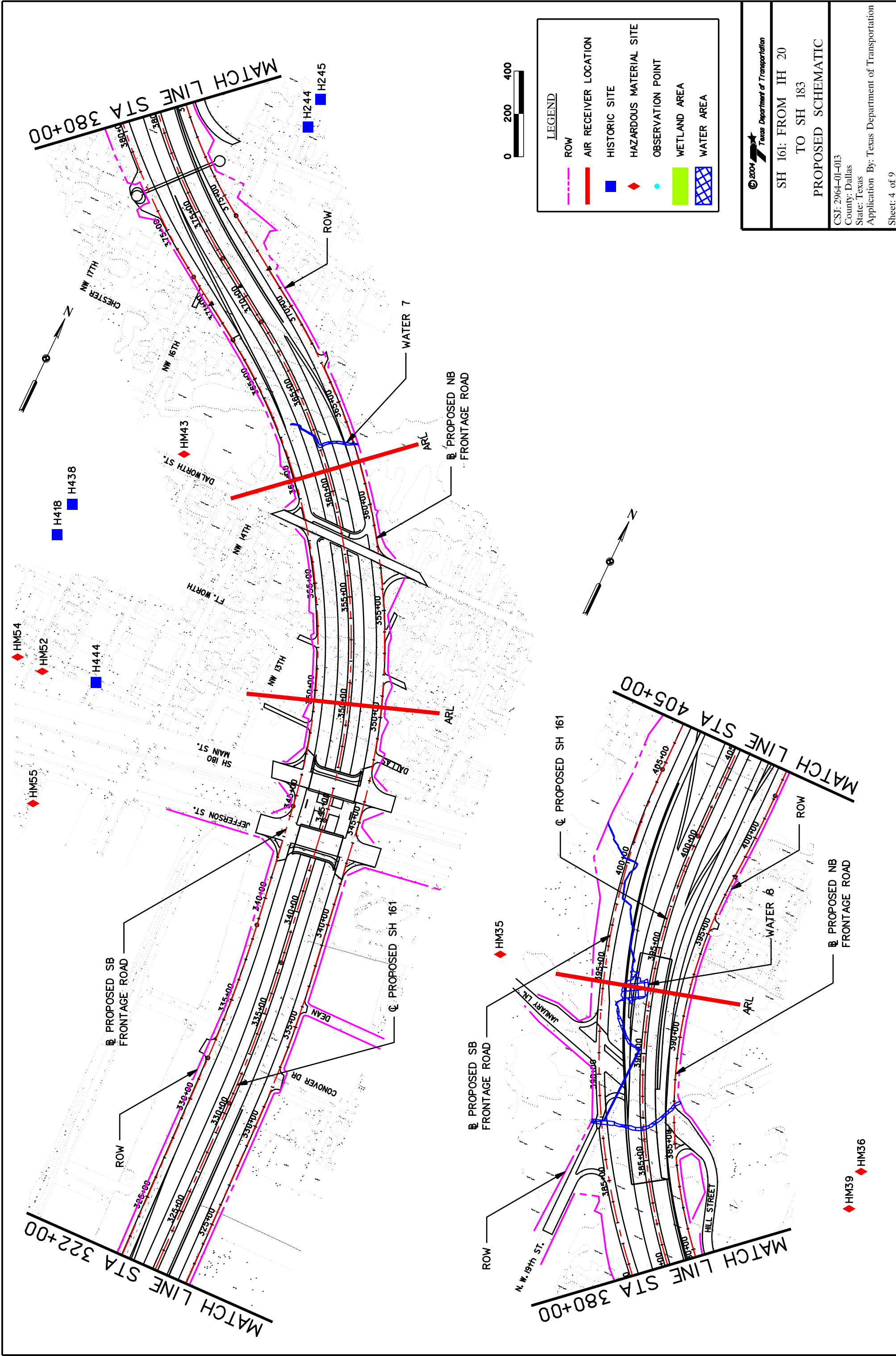

**LEGEND**

	ROW
	AIR RECEIVER LOCATION
	HISTORIC SITE
	HAZARDOUS MATERIAL SITE
	OBSERVATION POINT
	WETLAND AREA
	WATER AREA

© 2004 Texas Department of Transportation

SH 161: FROM IH 20  
TO SH 183  
PROPOSED SCHEMATIC

CSJ: 2964-01-013  
County: Dallas  
State: Texas  
Application By: Texas Department of Transportation  
Sheet: 4 of 9



MATCH LINE STA 432+00

MATCH LINE STA 405+00

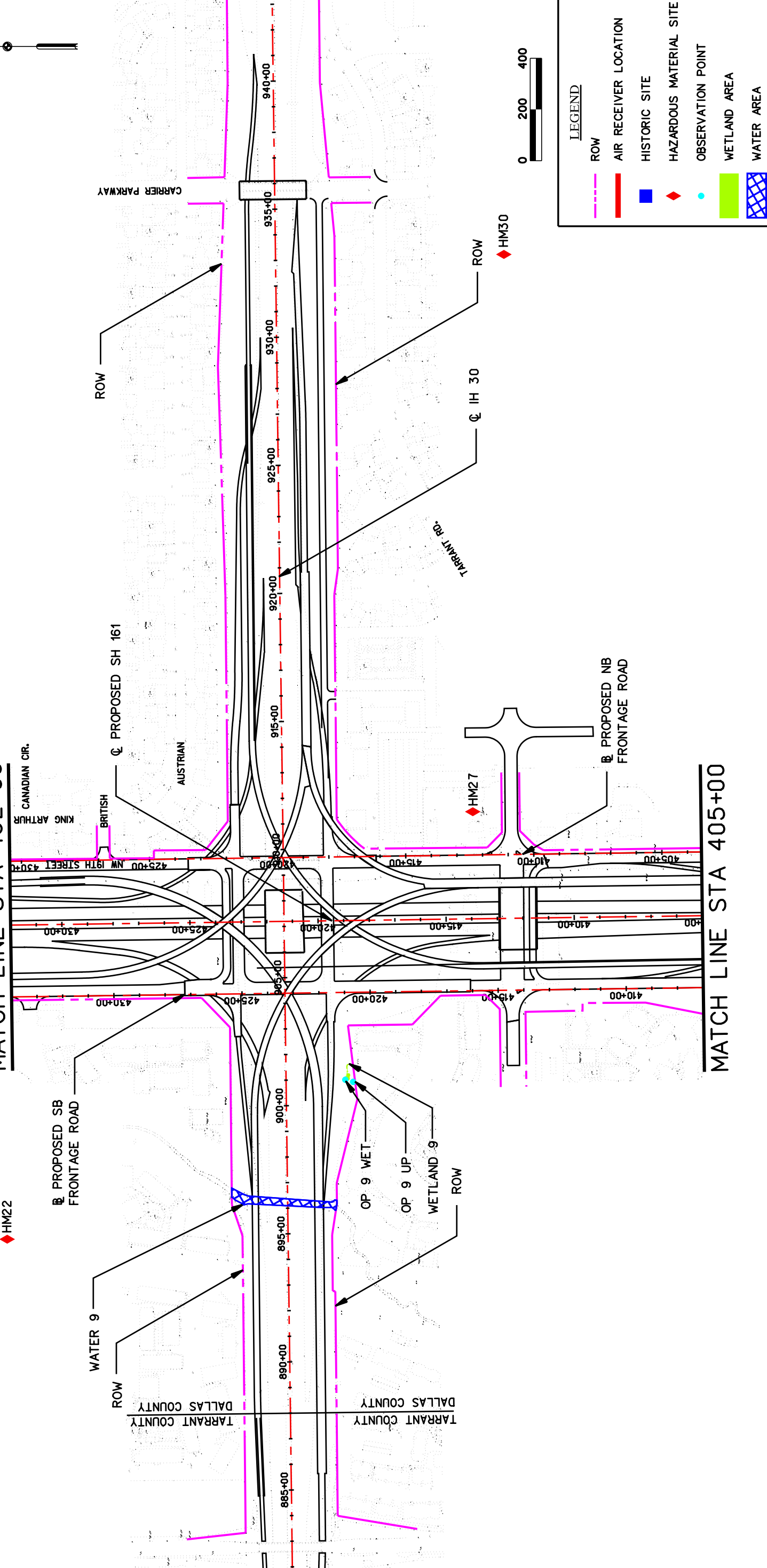

LEGEND	
	ROW
	AIR RECEIVER LOCATION
	HISTORIC SITE
	HAZARDOUS MATERIAL SITE
	OBSERVATION POINT
	WETLAND AREA
	WATER AREA

SH 161: FROM IH 20  
 TO SH 183  
 PROPOSED SCHEMATIC

---

CSJ: 2964-01-013  
 County: Dallas  
 State: Texas  
 Application By: Texas Department of Transportation

Sheet: 5 of 9

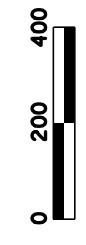
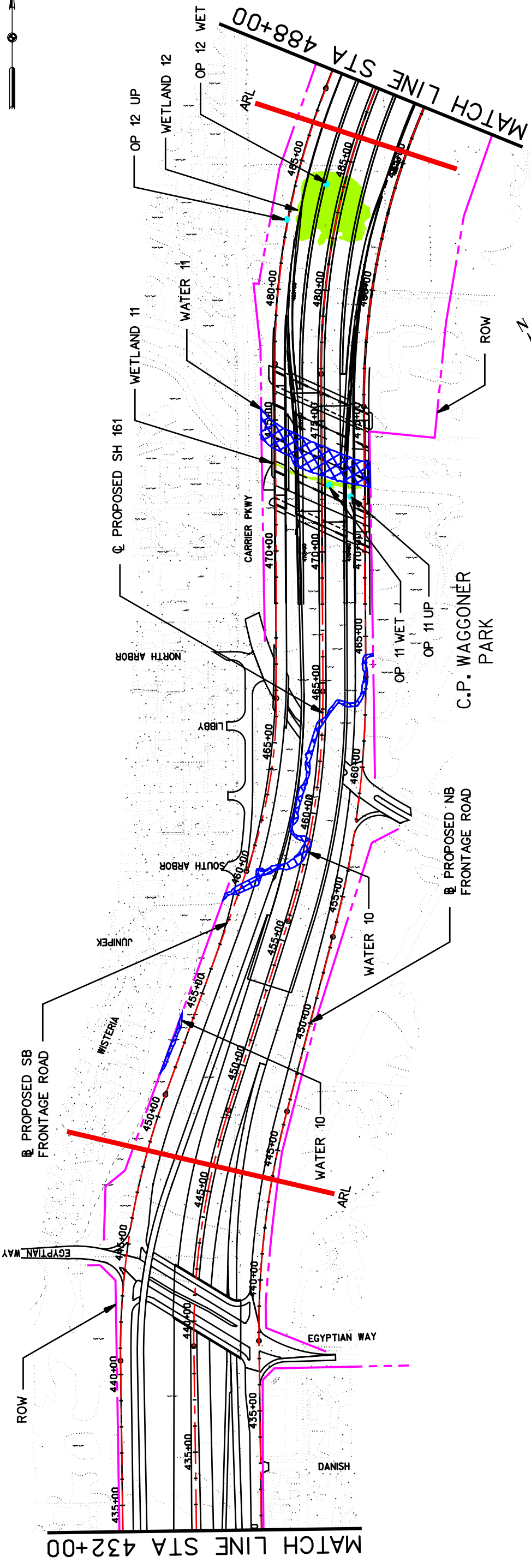

LEGEND	
	ROW
	AIR RECEIVER LOCATION
	HISTORIC SITE
	HAZARDOUS MATERIAL SITE
	OBSERVATION POINT
	WETLAND AREA
	WATER AREA

© 2004 Texas Department of Transportation

SH 161: FROM IH 20  
TO SH 183  
PROPOSED SCHEMATIC

CSJ: 2964-01-013  
County: Dallas  
State: Texas  
Application By: Texas Department of Transportation

Sheet: 6 of 9

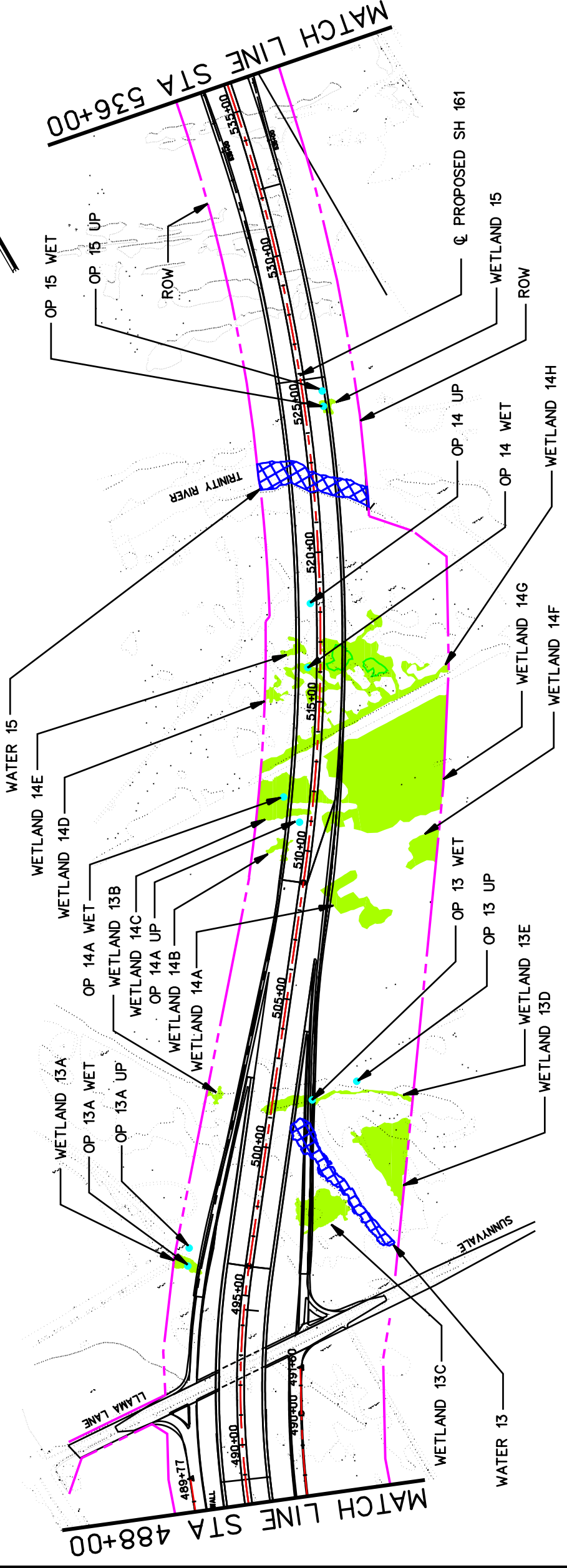
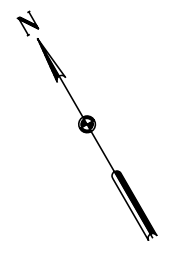

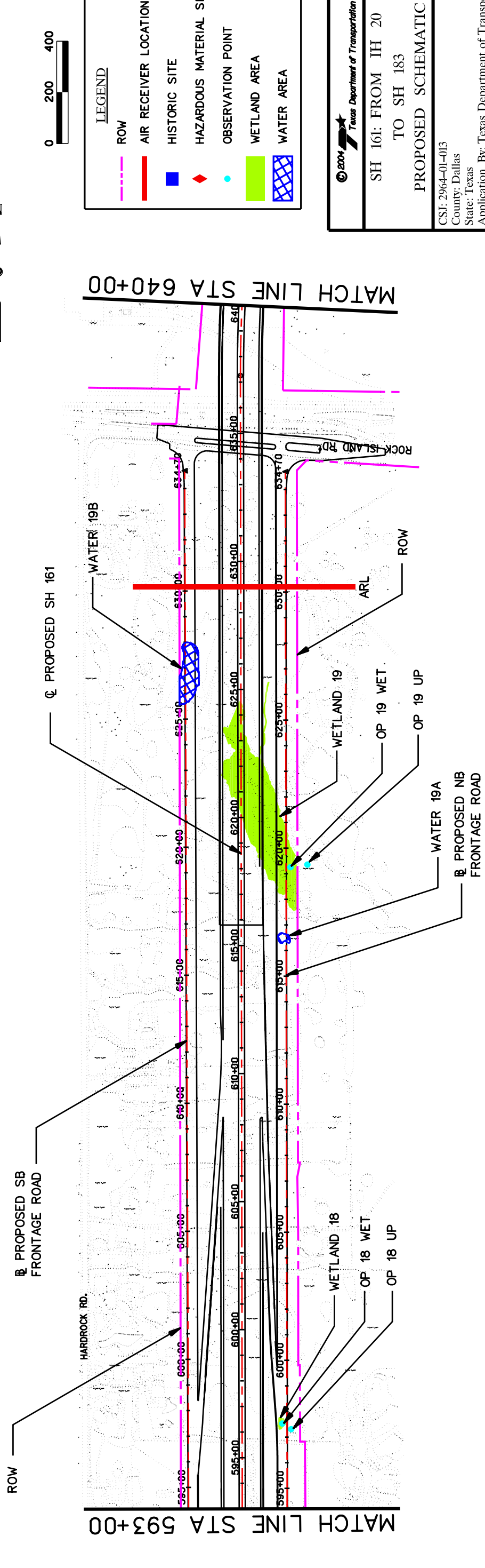
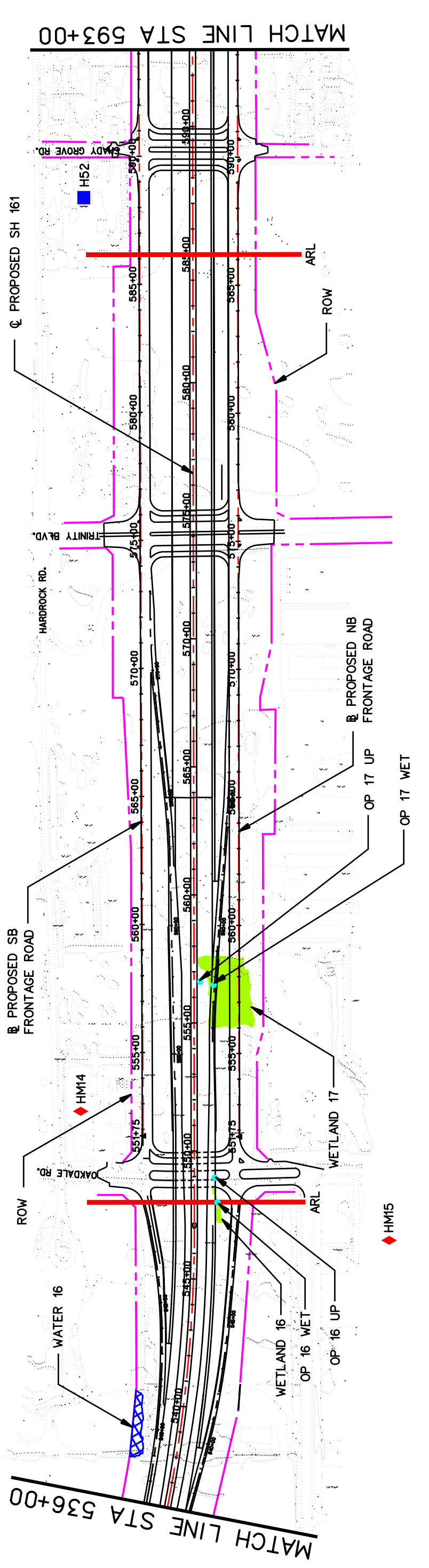

LEGEND	
	ROW
	AIR RECEIVER LOCATION
	HISTORIC SITE
	HAZARDOUS MATERIAL SITE
	OBSERVATION POINT
	WETLAND AREA
	WATER AREA

© 2004 Texas Department of Transportation

SH 161: FROM IH 20  
TO SH 183  
PROPOSED SCHEMATIC

CSJ: 2964-01-013  
County: Dallas  
State: Texas  
Application By: Texas Department of Transportation

Sheet: 7 of 9



MATCH LINE STA 640+00

MATCH LINE STA 695+00

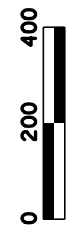
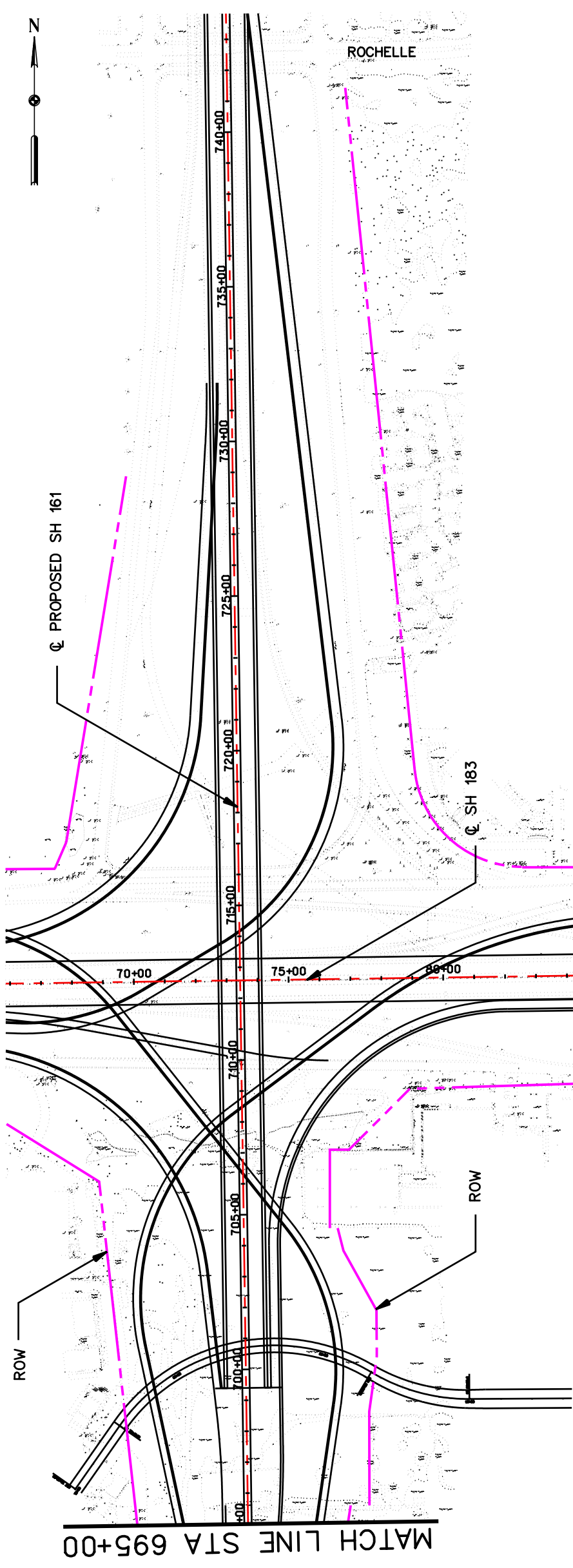
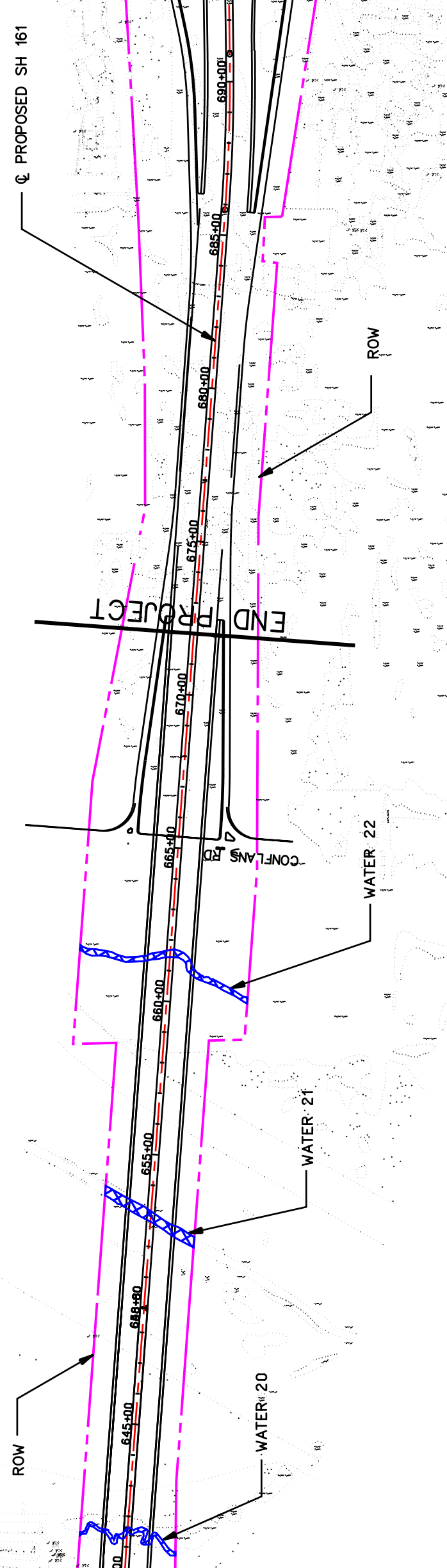

LEGEND	
	ROW
	AIR RECEIVER LOCATION
	HISTORIC SITE
	HAZARDOUS MATERIAL SITE
	OBSERVATION POINT
	WETLAND AREA
	WATER AREA

© 2004 Texas Department of Transportation

SH 161: FROM IH 20  
TO SH 183  
PROPOSED SCHEMATIC

CSJ: 2964-01-013  
County: Dallas  
State: Texas  
Application By: Texas Department of Transportation

Sheet: 8 of 9

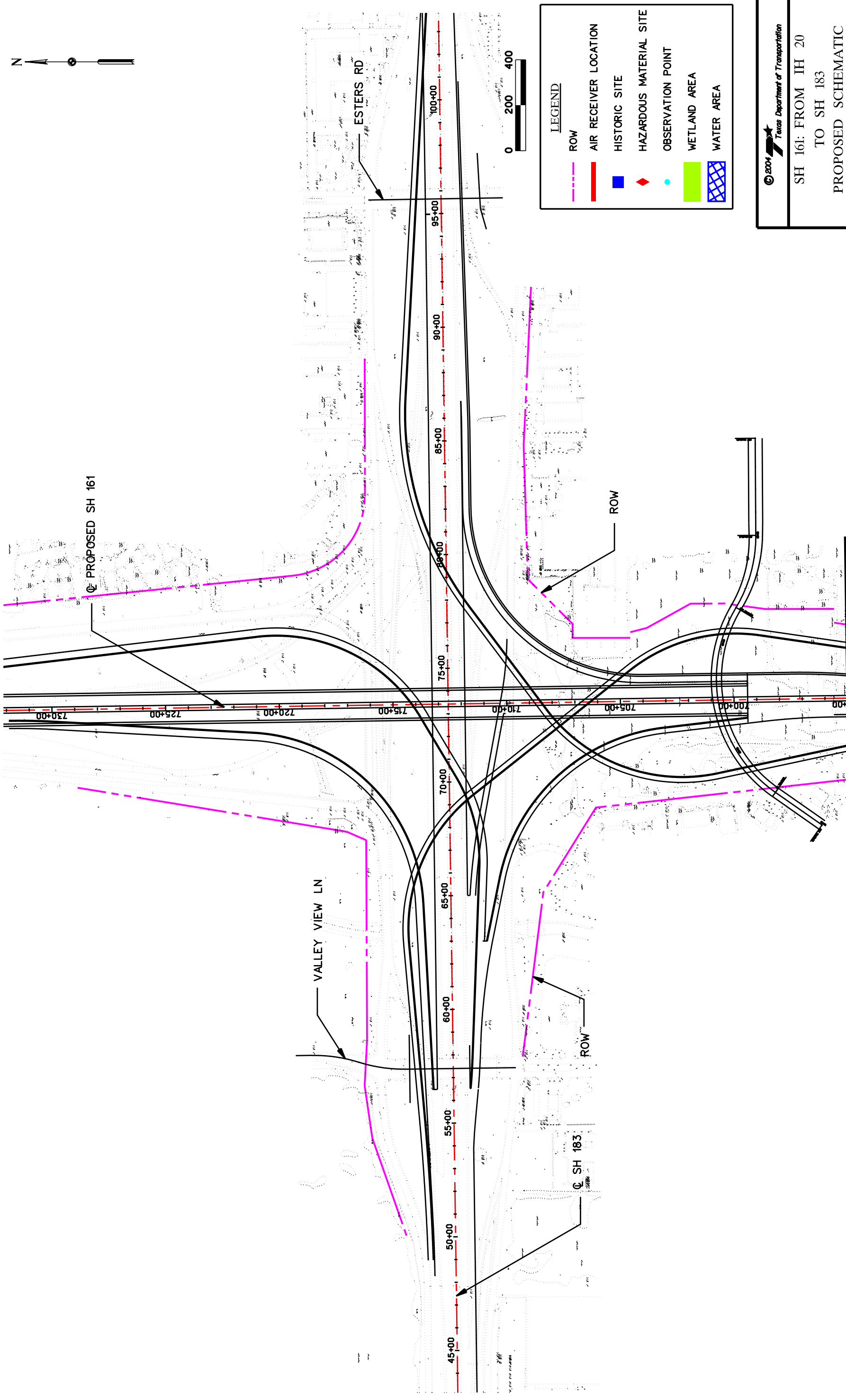

**LEGEND**

- ROW (Red dashed line)
- AIR RECEIVER LOCATION (Red solid line)
- HISTORIC SITE (Blue square)
- HAZARDOUS MATERIAL SITE (Red diamond)
- OBSERVATION POINT (Blue circle)
- WETLAND AREA (Green shaded area)
- WATER AREA (Blue hatched area)

© 2004 Texas Department of Transportation  
SH 161: FROM IH 20  
TO SH 183  
PROPOSED SCHEMATIC

CSJ: 2964-01-013  
County: Dallas  
State: Texas  
Application By: Texas Department of Transportation  
Sheet 9 of 9

MATCH LINE STA 695+00

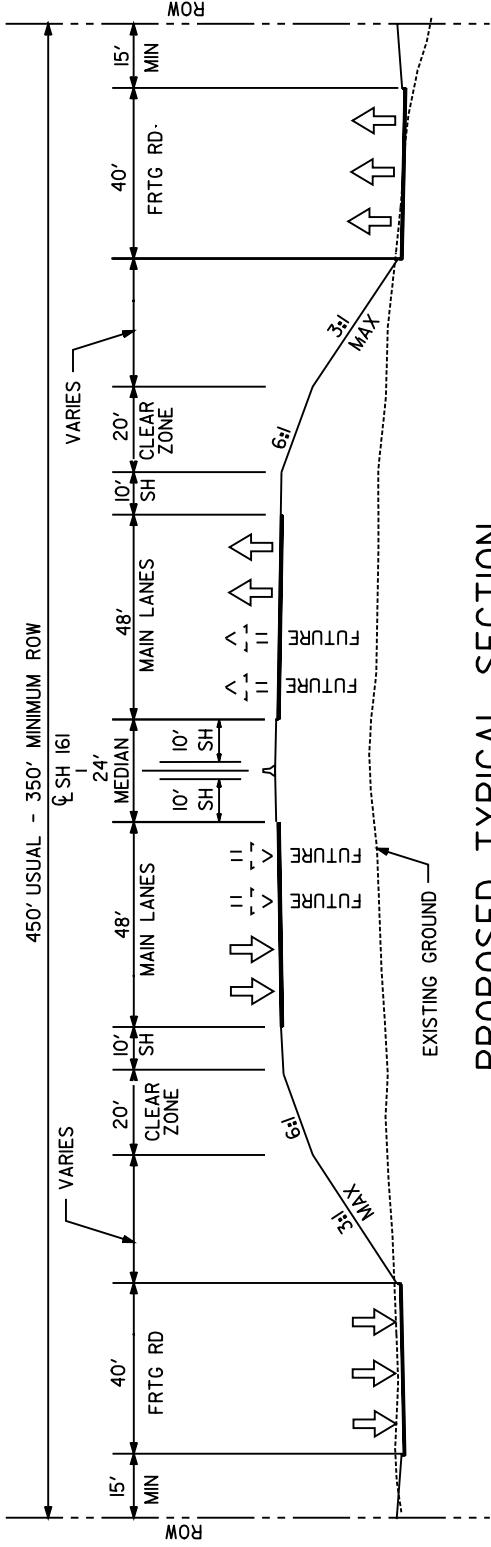

PROPOSED TYPICAL SECTION  
FROM IH 20 TO IH 30

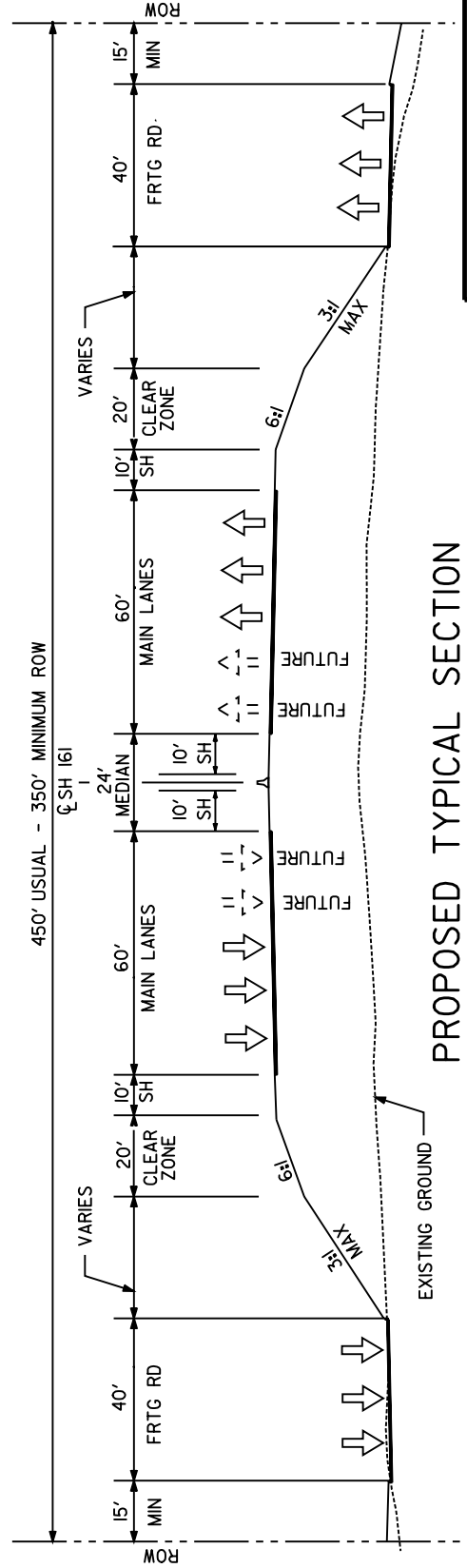

PROPOSED TYPICAL SECTION  
FROM IH 30 TO SH 183



SH 161: FROM IH 20 TO SH 183  
PROPOSED TYPICAL SECTION

County: Dallas  
State: Texas  
Application By: Texas Department of Transportation