

EXISTING
TYPICAL SECTION
W. LAWTHER
STA 1+50 TO STA 2+35

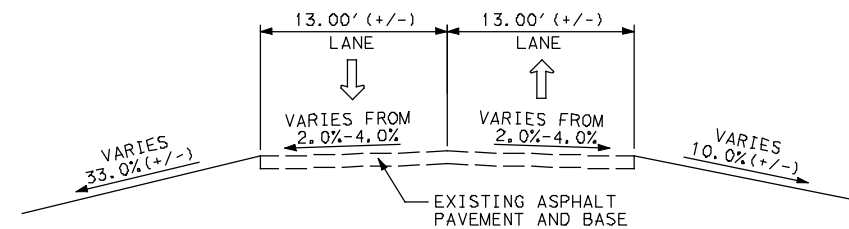

EXISTING
TYPICAL SECTION
W. LAWTHER
STA 3+95 TO STA 4+80

TYPICAL SECTION KEY:

- ① 8" CONC PVMT (CRCP)
- ② 8" LIME TRT (6%)
- ③ 4" THICK CONCRETE (MOW STRIP)

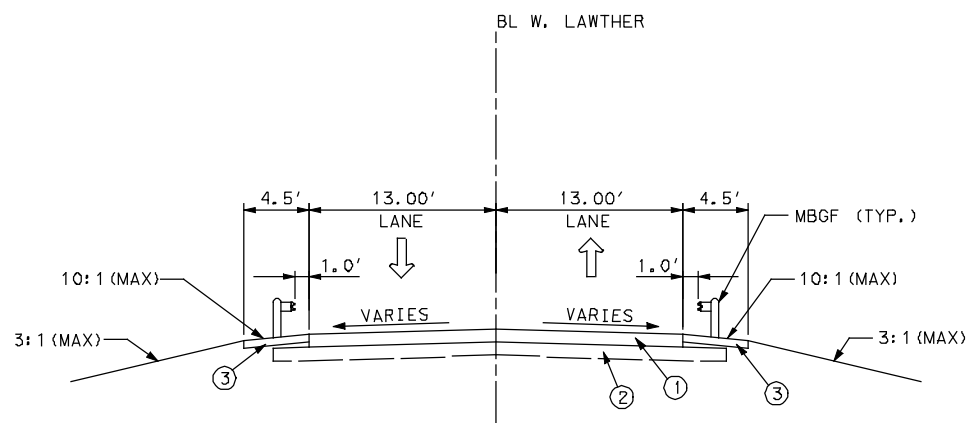

PROPOSED
TYPICAL SECTION
W. LAWTHER
STA 1+50 TO STA 2+35
STA 3+95 TO STA 4+80

HALFF ASSOCIATES, INC.
ENGINEERS • SURVEYORS • SCIENTISTS
PRELIMINARY - FOR INTERIM REVIEW ONLY
These documents are for Interim Review
and not intended for Construction, Bidding,
or Permit Purposes. They were prepared
by, or under the supervision of:
TODD A. WOODSON 88692 OCTOBER 03, 2008
PE# Date

NO.	REVISION	BY	DATE

Halff Associates

Texas Department of Transportation
© 2007

WEST LAWTHER DRIVE
TYPICAL SECTIONS

SCALE: . NTS		SHEET 1 OF 1	
FED. RD. DIV. NO. 6	FEDERAL AID PROJECT NO.	HIGHWAY NO.	
STATE TEXAS	DISTRICT 18	COUNTY DALLAS	SHEET NO.
CONTROL 0918	SECTION 45	JOB 760	

USER: ch1120

OFFICE: RCH

PROJECT # 24149

FILE: 24149WA11-PAVM-1.dgn

DATE: 10/3/2008

TIME: 9:24:58 AM

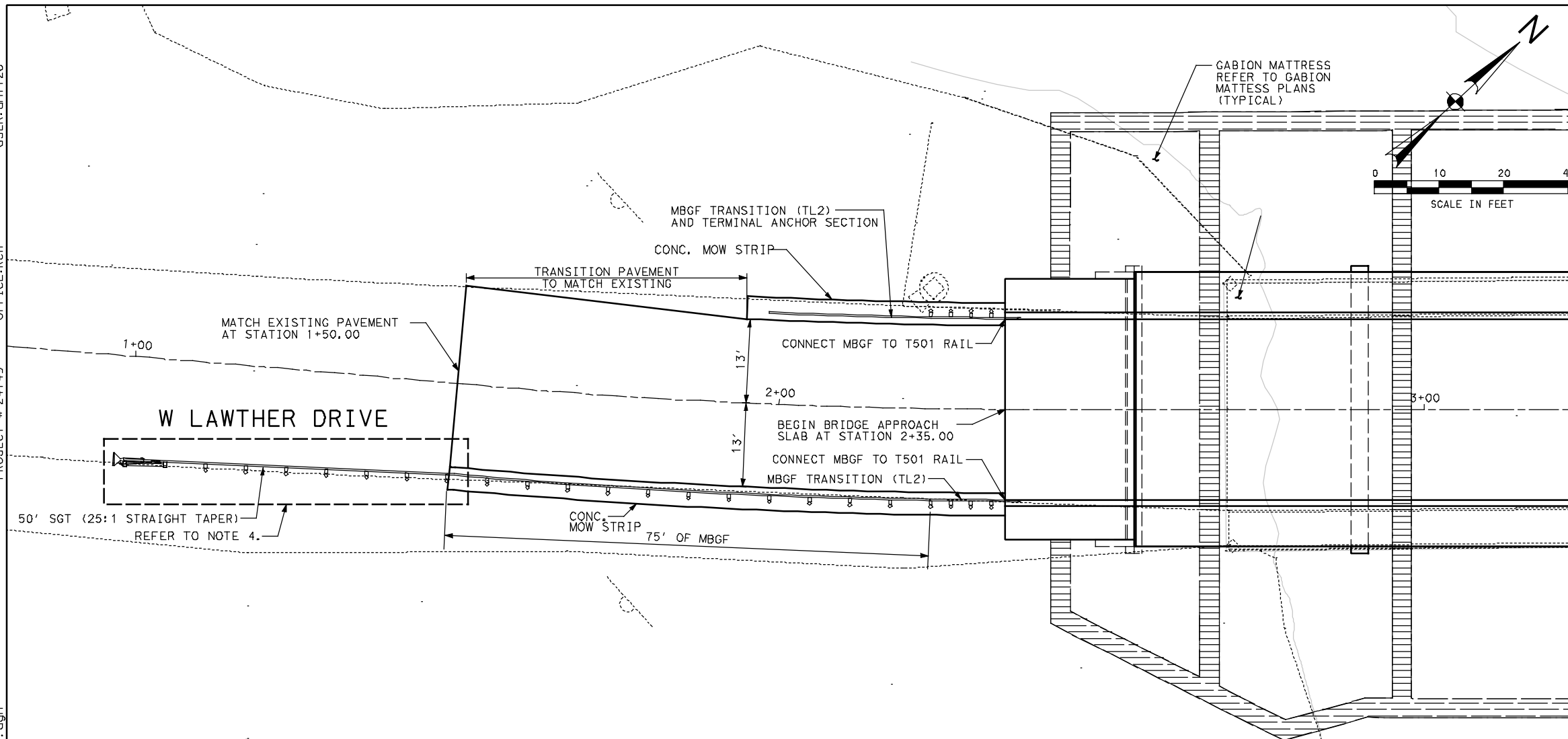

- NOTES:
1. INSTALL MBGF WITH WOOD BLOCKOUT AND ROUND POST PER TxDOT STANDARD MBGF-03A (TYP.)
 2. REFER TO TxDOT STANDARDS MBGF-03A, MBGF (TL2)-05 AND BED-03 FOR MORE INFORMATION ON METAL BEAM GUARD FENCE AND BRIDGE END DETAILS.
 3. REFER TO WEST LAWATHER DRIVE BRIDGE DRAWINGS FOR LAYOUT AND STRUCTURAL DETAILS.
 4. EXISTING SHOULDER MATERIAL IN THIS AREA IS CEMENT TREATED BASE. CORE DRILLING OR SIMILAR MEANS WILL BE REQUIRED FOR INSTALLING POSTS IN THIS AREA. NO ADDITIONAL PAYMENT WILL BE MADE FOR INSTALLING POSTS IN CEMENT TREATED BASE.
 5. ALL EXISTING DRAINAGE SYSTEMS SHALL REMAIN IN SERVICE OR HAVE SOME MEANS OF CONVEYANCE TO THE OUTFALL UNTIL THE PROPOSED SYSTEM IS CONSTRUCTED AND FULLY OPERATIONAL. THE CONTRACTOR SHALL BE LIABLE FOR DAMAGES TO PROPERTY CAUSED BY HIS FAILURE TO EFFECT THE ABOVE REQUIREMENT.
 6. THE LOCATIONS OF EXISTING UTILITIES SHOWN ON THESE PLANS WERE DEVELOPED FROM INFORMATION PROVIDED BY VARIOUS UTILITY COMPANIES, CITY OF DALLAS AND THE TEXAS DEPARTMENT OF TRANSPORTATION. WHERE KNOWN CONFLICTS EXISTED, EXISTING UTILITIES SHOULD HAVE BEEN RELOCATED OR ABANDONED IN PLACE UNDER SEPARATE CONTRACTS BY THE OWNERS OF THE VARIOUS UTILITIES. THE CONTRACTOR SHALL VERIFY THAT SUCH RELOCATIONS HAVE BEEN CONSTRUCTED. UTILITIES ARE SHOWN SCHEMATICALLY FOR CONTRACTOR'S GUIDANCE ONLY. ALL UTILITIES MAY NOT BE SHOWN. IT SHALL BE THE CONTRACTOR'S RESPONSIBILITY TO VERIFY AND LOCATE ALL UTILITIES WHICH MAY BE AFFECTED PRIOR TO CONSTRUCTION. THE CONTRACTOR SHALL CONTACT ALL UTILITY COMPANIES TO DETERMINE PRECISE LOCATIONS OF EXISTING UTILITIES PRIOR TO CONSTRUCTING THE PROPOSED IMPROVEMENTS. THE CONTRACTOR SHALL NOTIFY TxDOT OF ANY EXISTING FACILITIES CONFLICTING WITH THE PROPOSED CONSTRUCTION AND OBTAIN DIRECTION FOR THE PROPER DISPOSITION OF SAID CONFLICTING EXISTING FACILITIES FROM TxDOT AT LEAST 72 HOURS PRIOR TO CONSTRUCTION. THE CONTRACTOR SHALL TAKE ANY AND ALL NECESSARY MEASURES TO PROTECT ALL EXISTING STRUCTURES, IMPROVEMENTS, AND UTILITIES WHICH MAY BE ENCOUNTERED. THE CONTRACTOR WILL BE SOLELY RESPONSIBLE FOR DAMAGES TO EXISTING UTILITIES CAUSED BY HIS/HER CONSTRUCTION OPERATIONS.
 7. ALL PROPOSED STORM SEWER SHALL HAVE "CLASS B" BEDDING AS DESCRIBED IN ITEM 400 "EXCAVATION AND BACKFILL FOR STRUCTURES" UNLESS OTHERWISE NOTED ON THE PLANS.
 8. CONCRETE AND STONE RIPRAP SHALL BE AS DESCRIBED IN ITEM 432 "RIPRAP."

MATCHLINE STATION 3+25.00

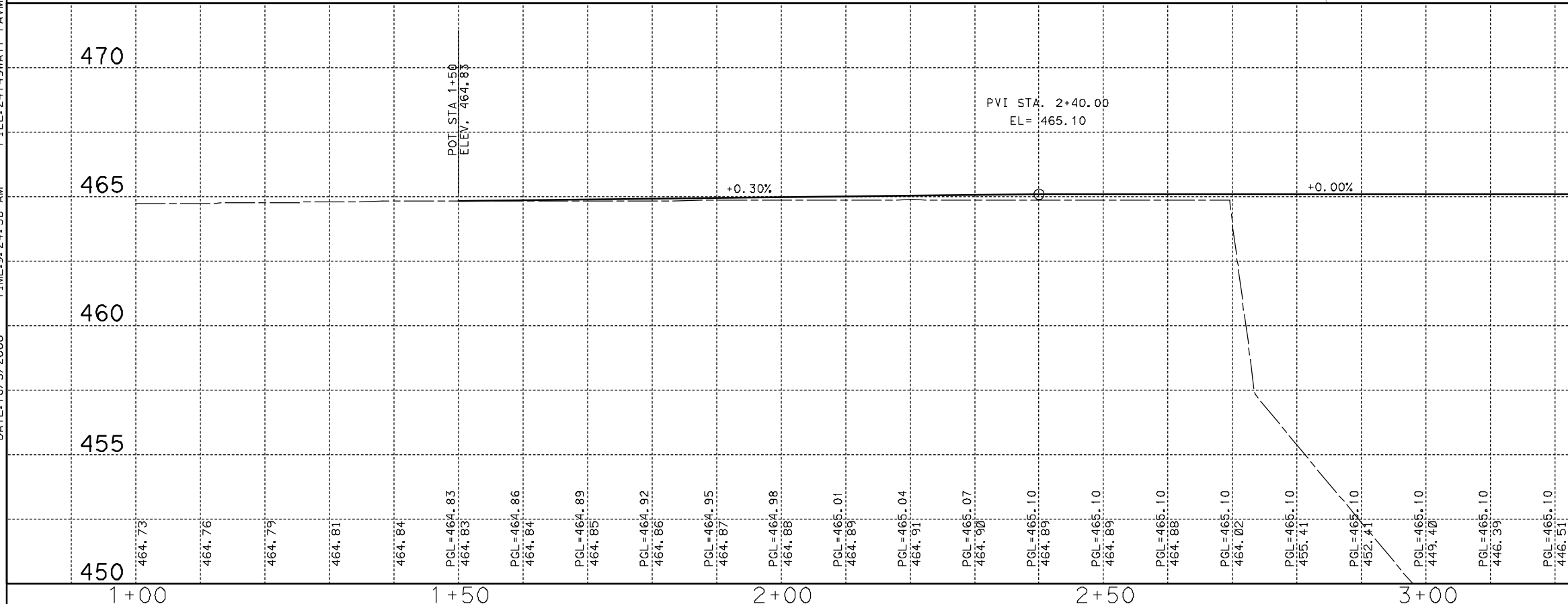

MATCHLINE STATION 3+25.00

HALFF ASSOCIATES, INC.
 ENGINEERS • SURVEYORS • SCIENTISTS
 PRELIMINARY - FOR INTERIM REVIEW ONLY
 These documents are for Interim Review and not intended for Construction, Bidding, or Permit Purposes. They were prepared by, or under the supervision of:
 TODD A. WOODSON PE# 88692 OCTOBER 03, 2008 Date

NO.	REVISION	BY	DATE



WEST LAWATHER DRIVE
 PAVING PLAN
 WEST LAWATHER DRIVE BRIDGE

SCALE: 1"=20'H, 1"5'V SHEET 1 OF 2

FED. RD. DIV. NO.	FEDERAL AID PROJECT NO.	HIGHWAY NO.
6		
STATE	DISTRICT	COUNTY
TEXAS	18	DALLAS
CONTROL	SECTION	JOB
0918	45	760

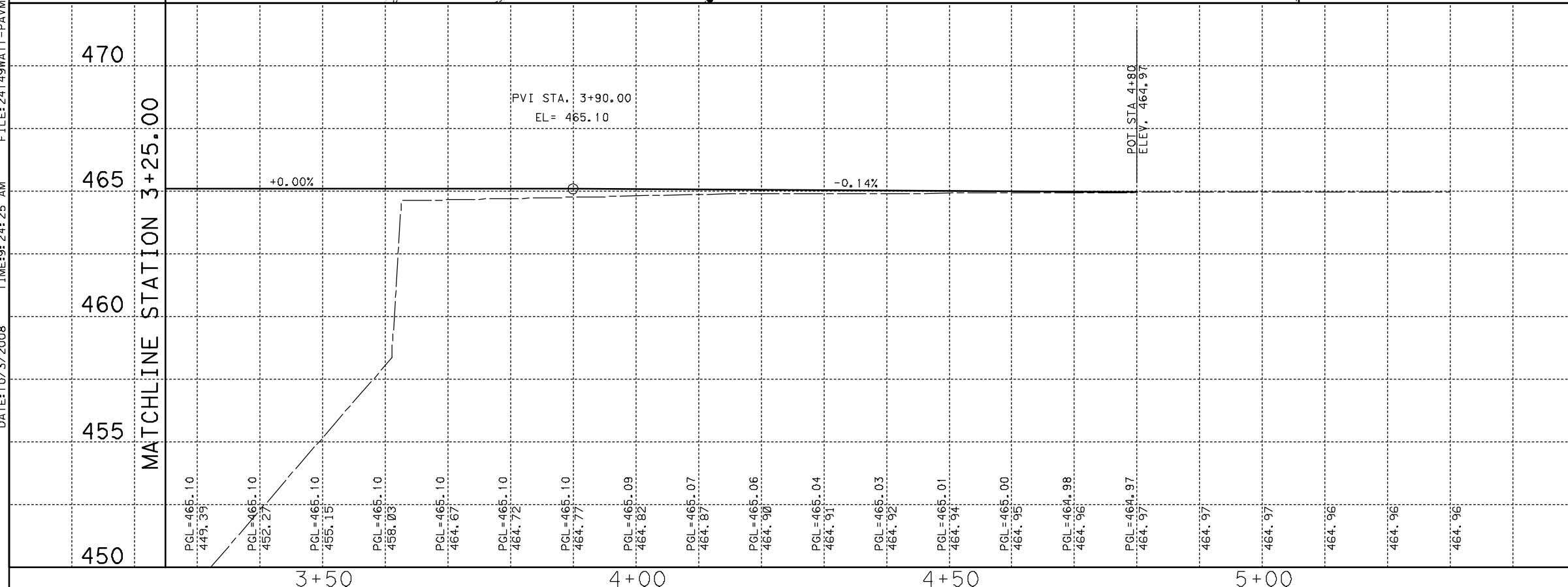
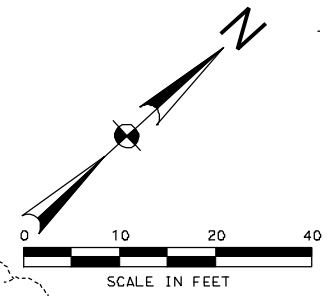
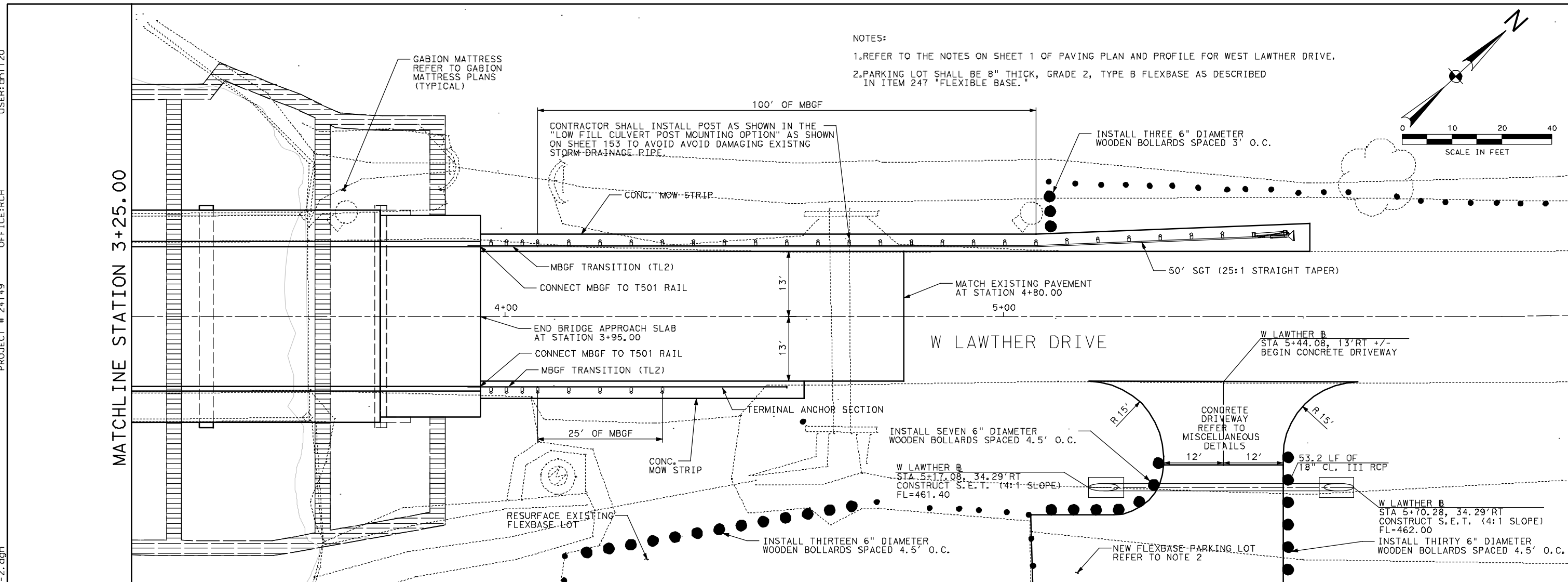

HALFF ASSOCIATES, INC.
ENGINEERS • SURVEYORS • SCIENTISTS

PRELIMINARY - FOR INTERIM REVIEW ONLY

These documents are for Interim Review and not intended for Construction, Bidding, or Permit Purposes. They were prepared by, or under the supervision of:

TODD A. WOODSON 88692 OCTOBER 03, 2008
PE# Date

NO.	REVISION	BY	DATE



WEST LAWATHER DRIVE
PAVING PLAN
WEST LAWATHER DRIVE BRIDGE

SCALE: 1"=20'H, 1"=5' V SHEET 2 OF 2

FED. RD. DIV. NO. 6	FEDERAL AID PROJECT NO.	HIGHWAY NO.
STATE TEXAS	DISTRICT 18	COUNTY DALLAS
CONTROL 0918	SECTION 45	JOB 760
SHEET NO.		

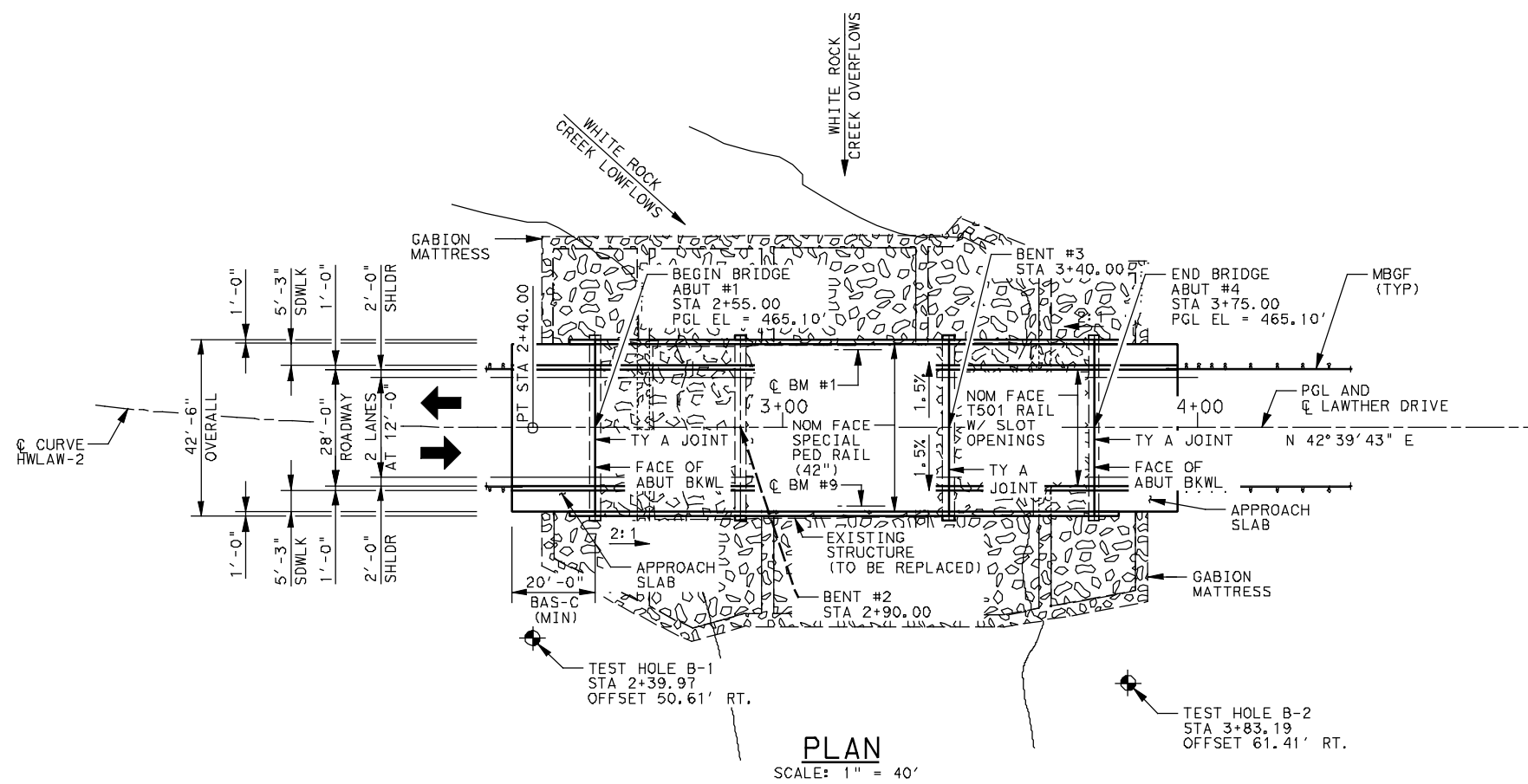

⊙ CURVE HWLAW-2 HORIZONTAL CURVE DATA

PI STA 1+95.46
Δ = 05° 06' 28.24" (LT)
D = 05° 43' 46.48"
V = 1,000.00'
T = 44.60'
L = 89.15'
PC STA 1+50.85
PT STA 2+40.00

ALL ABUTMENTS AND BENTS ARE ON BEARING S 47° 20' 17" E

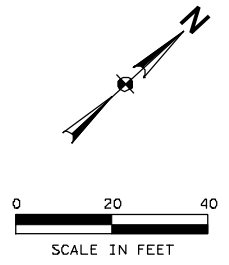

- DESIGN NOTES:**
- BRIDGE DESIGNED FOR HL93 LOADING AND 25 PSF FUTURE OVERLAY PER AASHTO LRFD BRIDGE DESIGN SPECIFICATIONS (2004) AND INTERIM SPECIFICATIONS THERETO.
 - DESIGN SPEED = 30 MPH.
 - FUNCTIONAL CLASSIFICATION = MINOR STREET (S-2-4).
 - ADT = 3,100 VPD (2005).
= 4,300 VPD (2025).
 - TEST HOLE DATA PROVIDED BY FUGRO CONSULTANTS, L.P., DATED JUNE 23, 2006.

- FOUNDATION NOTES:**
- ALL DRILLED SHAFTS AT ABUTMENTS AND BENTS ARE DESIGNED FOR COMBINED SKIN FRICTION AND POINT BEARING.
 - FOUND DRILLED SHAFTS AT THE ELEVATION SHOWN OR DEEPER AS NECESSARY TO PENETRATE UNWEATHERED LIMESTONE THE FOLLOWING MINIMUM DEPTHS:
ABUTMENTS - 6.00 FT.
BENTS - 7.50 FT.

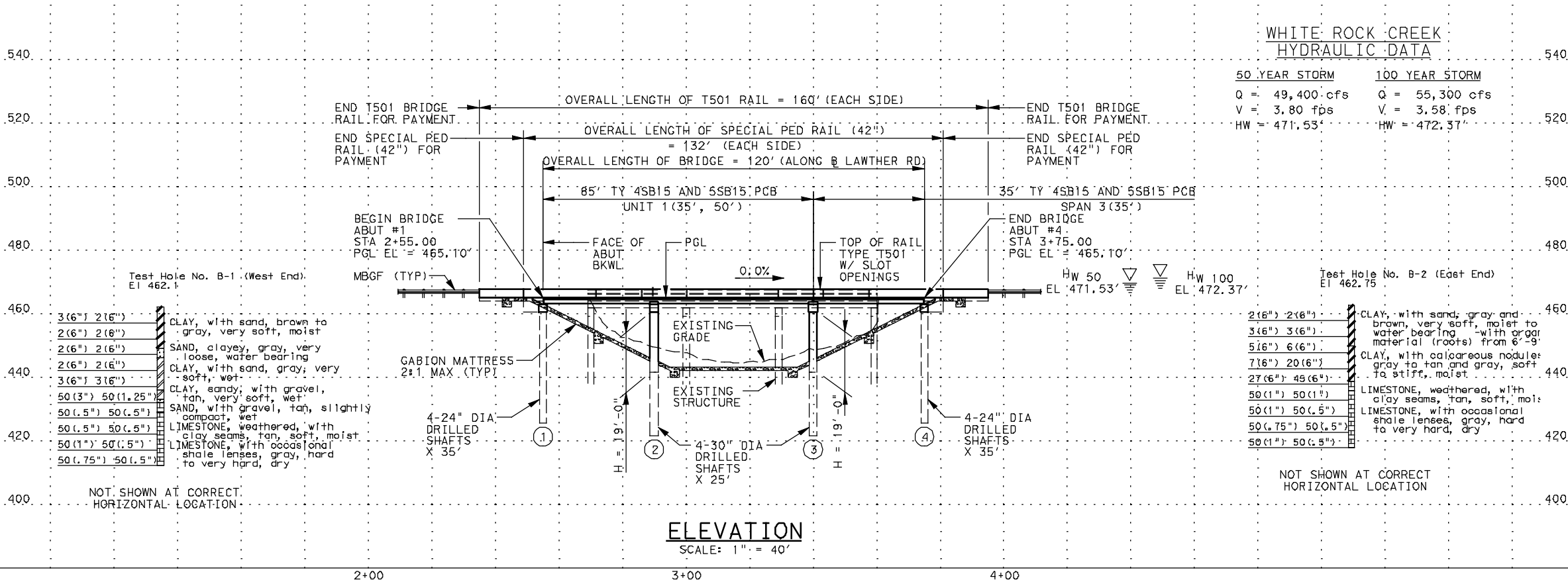

HALFF ASSOCIATES, INCORPORATED
ENGINEERS SURVEYORS SCIENTISTS
PRELIMINARY FOR INTERIM REVIEW ONLY

THESE DOCUMENTS ARE FOR INTERIM REVIEW AND NOT INTENDED FOR CONSTRUCTION, BIDDING OR PERMIT PURPOSES. THEY WERE PREPARED BY OR UNDER THE SUPERVISION OF:

CHONG KUK HONG 80621 10/03/2008
NAME P.E. NO. DATE

EXISTING NBI #1805709L3970001
NBI # HL93 LOADING

NO.	REVISION	BY	DATE

Halff Associates

Texas Department of Transportation
© 2007

WEST LAWATHER DRIVE
WHITE ROCK CREEK
BRIDGE LAYOUT

SHEET 1 OF 2

FED. RD. DIV. NO.	FEDERAL AID PROJECT NO.	HIGHWAY NO.	
6		LP12	
STATE	DISTRICT	COUNTY	SHEET NO.
TEXAS	DALLAS	DALLAS	
CONTROL	SECTION	JOB	
0918	45	760	

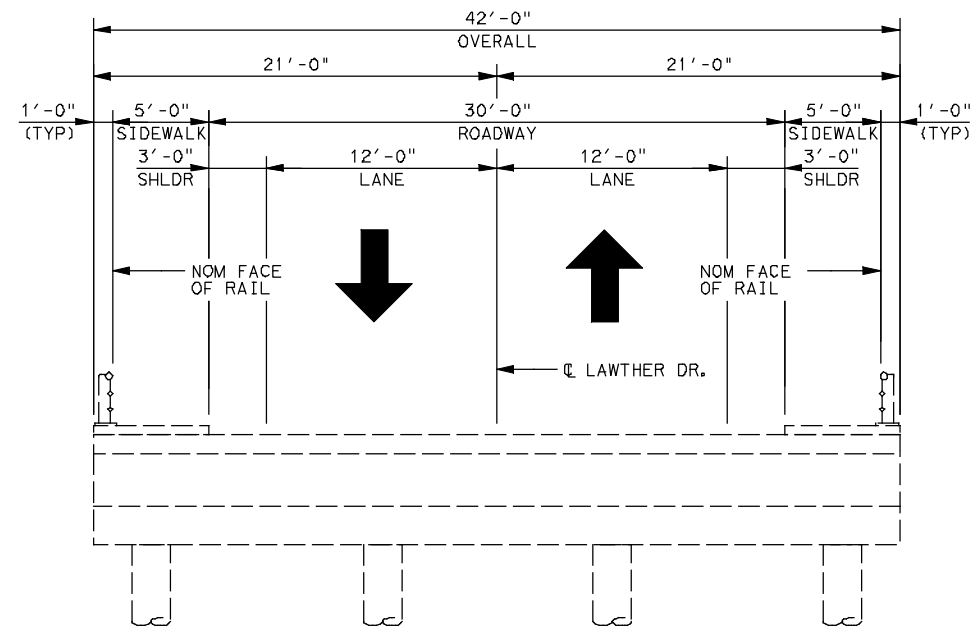

EXISTING SECTION
SCALE : 1"=10'-0"

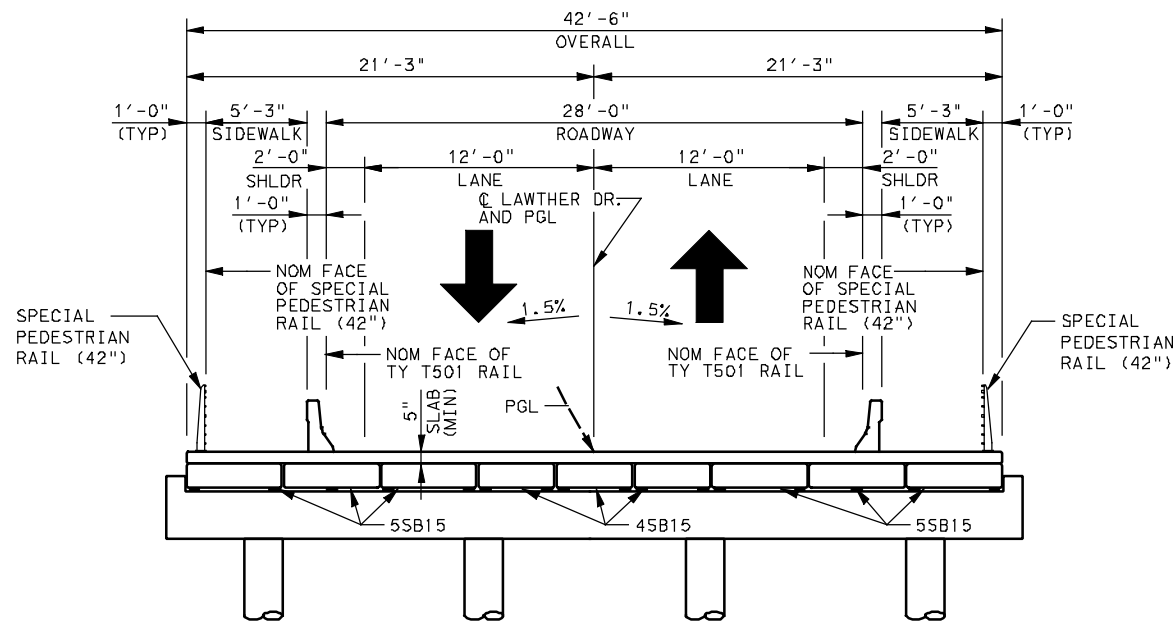

TYPICAL SECTION
SCALE : 1"=10'-0"

HALFF ASSOCIATES, INCORPORATED
ENGINEERS SURVEYORS SCIENTISTS
PRELIMINARY FOR INTERIM REVIEW ONLY

THESE DOCUMENTS ARE FOR INTERIM REVIEW AND NOT INTENDED FOR CONSTRUCTION, BIDDING OR PERMIT PURPOSES. THEY WERE PREPARED BY OR UNDER THE SUPERVISION OF:

CHONG KUK HONG 80621 10/03/2008
NAME P. E. NO. DATE

NO.	REVISION	BY	DATE

Halff Associates

Texas Department of Transportation
© 2007

WEST LAWTHER DRIVE

WHITE ROCK CREEK
TYPICAL SECTION

SHEET 2 OF 2

FED. RD. DIV. NO. 6	FEDERAL AID PROJECT NO.	HIGHWAY NO. LP12
STATE TEXAS	DISTRICT DALLAS	COUNTY DALLAS
CONTROL 0918	SECTION 45	JOB 760
SHEET NO.		