

FM 2514 Public Hearing

Thursday, January 11, 2018
6:00 p.m. to 8:00 p.m.

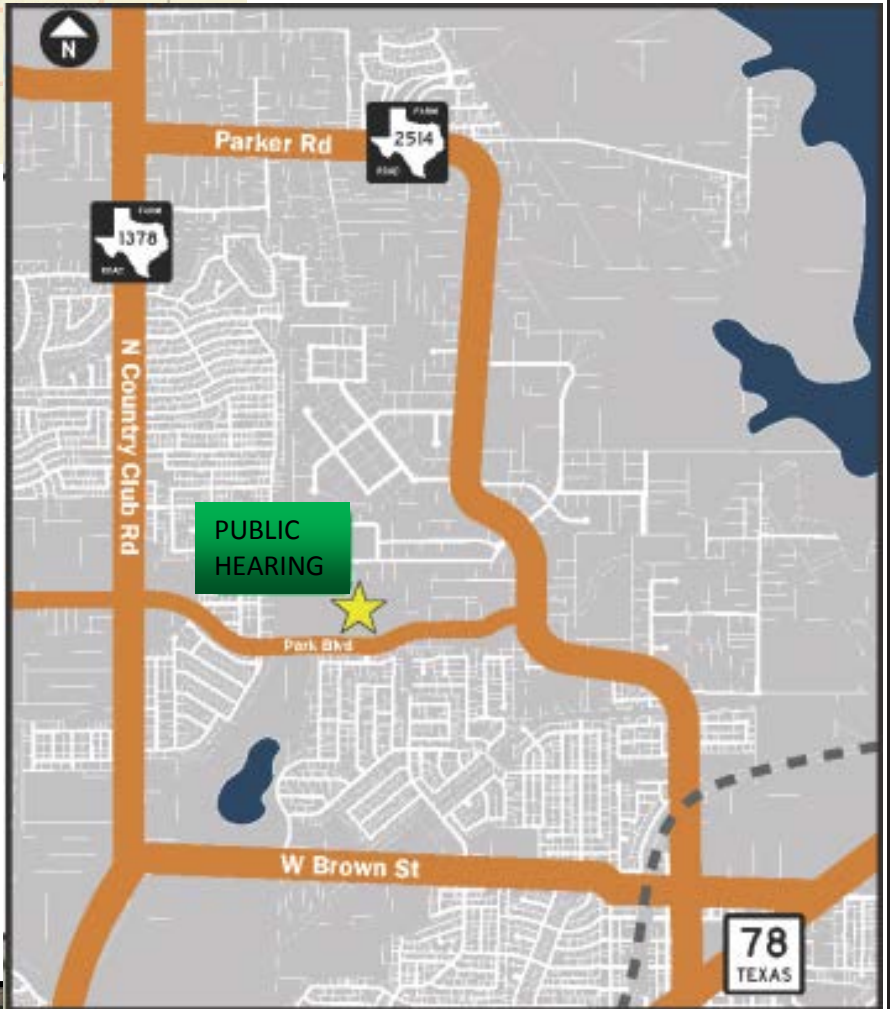
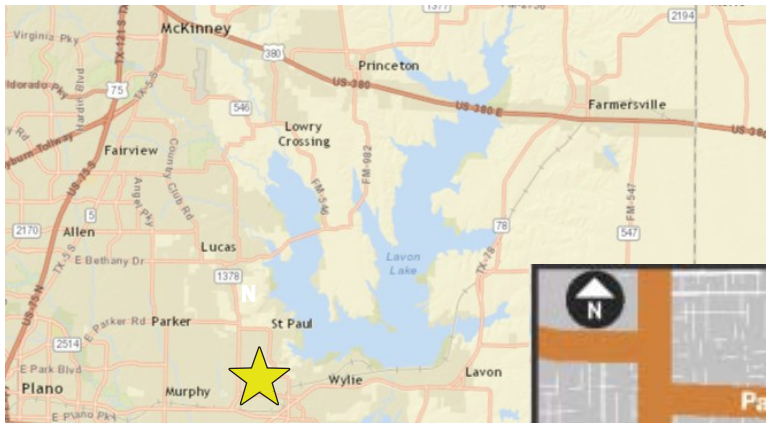

DIRECTIONS:

From Northbound or Southbound FM 1378 (Country Club Rd),

Turn east onto Park Blvd and continue for approximately 0.8 miles.

Frank McMillan Junior High School will be on your left (north side of Park Blvd).



Frank McMillan Junior High School Cafeteria

1050 Park Blvd

Wylie, TX 75098



Farm-to-Market (FM) 2514 (Parker Road) Public Hearing

Directional Parking Map