

## **APPENDIX C: EXHIBITS**

BEGIN PROJECT  
STA. 2177+00

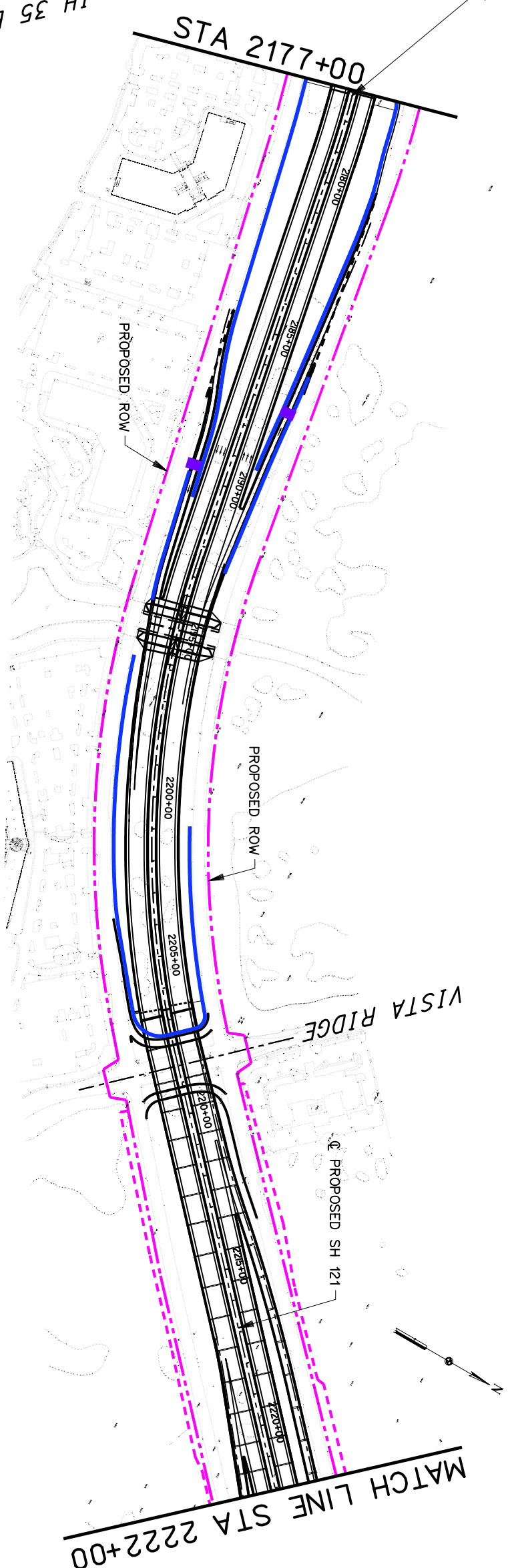

MATCH LINE STA 2222+00

MATCH LINE STA 2222+00

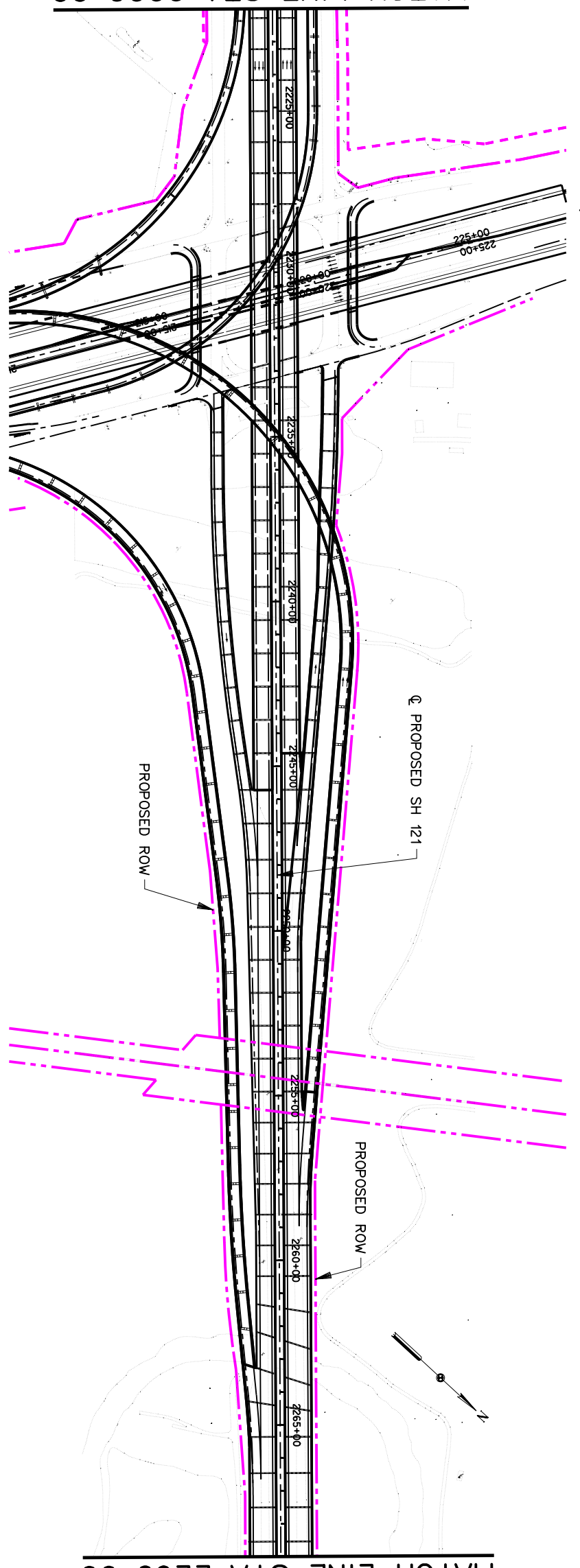

MATCH LINE STA 2269+00

\* SEE SHEET 8 OF 8 FOR IH 35 E DATA

LEGEND

	PROPOSED ROW
	RETAINING WALL
	PROPOSED ETC GANTRY
	AIR RECEIVER LOCATION
	EXISTING NOISE BARRIER
	PROPOSED NOISE BARRIER
	NOISE RECEIVER



© 2005 Texas Department of Transportation

SH 121: FROM EAST OF  
MACARTHUR BLVD.  
TO  
DALLAS NORTH TOLLWAY  
CONCEPTUAL TOLL PLAN

MATCH LINE STA 2269+00

MATCH LINE STA 2324+00

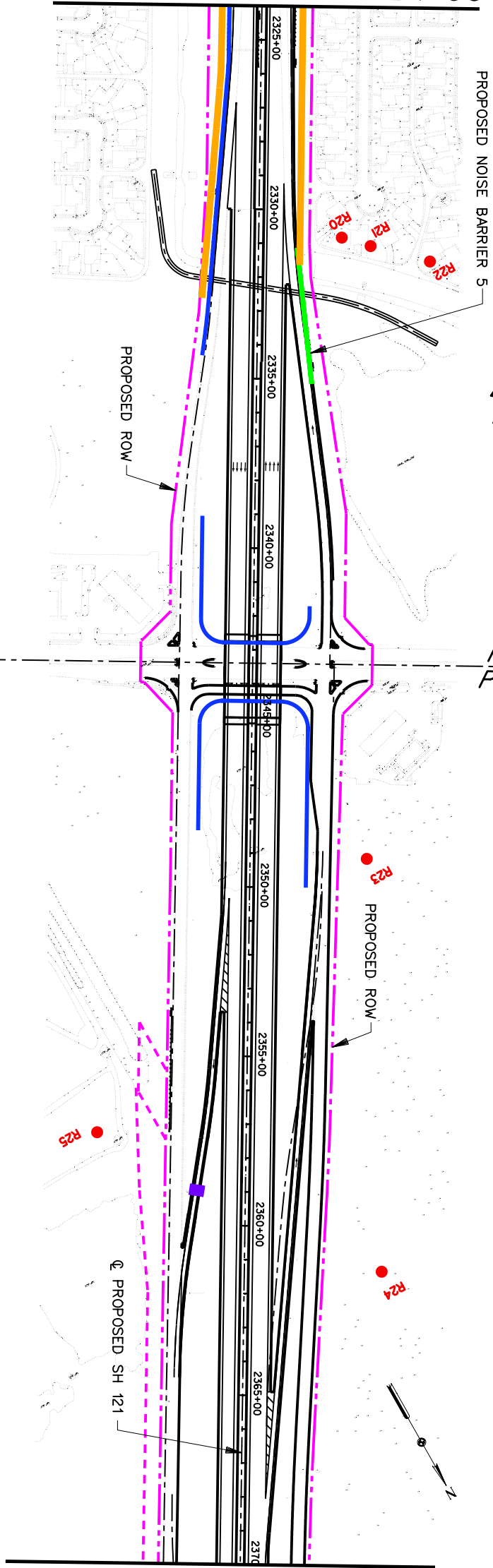
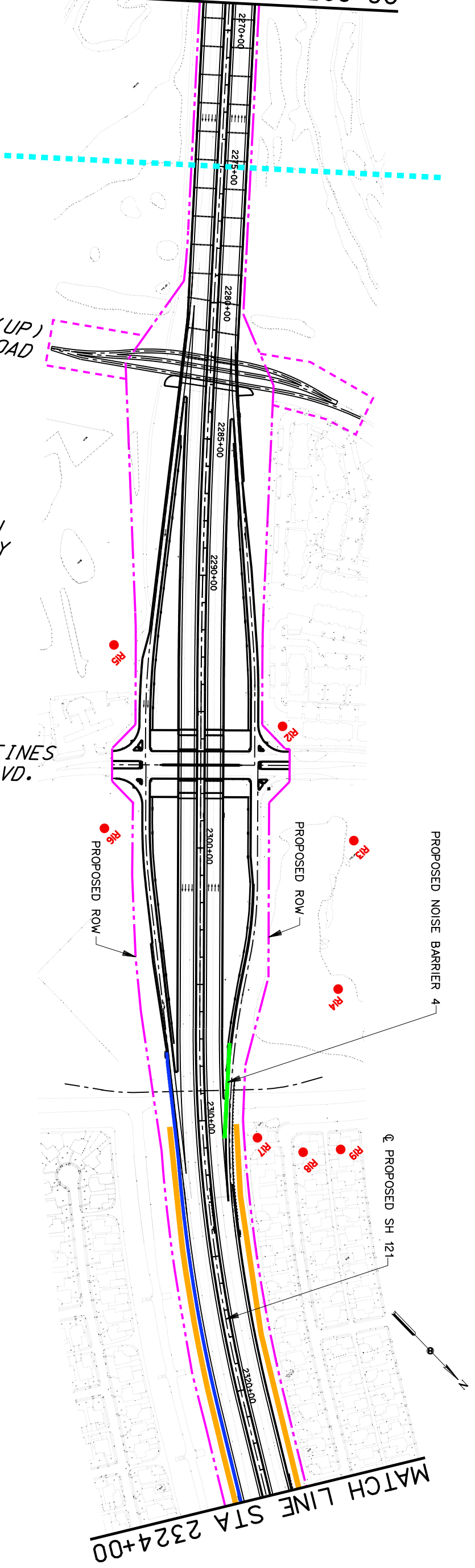

**LEGEND**

	PROPOSED ROW
	RETAINING WALL
	PROPOSED ETC GANTRY
	AIR RECEIVER LOCATION
	EXISTING NOISE BARRIER
	PROPOSED NOISE BARRIER
	NOISE RECEIVER

© 2005  
  
 Texas Department of Transportation  
 SH 121: FROM EAST OF  
 MACARTHUR BLVD.  
 TO  
 DALLAS NORTH TOLLWAY  
 CONCEPTUAL TOLL PLAN  
 CSJ: 0364-03-065 & 067 SHEET 2 OF 8

MATCH LINE STA 2370+00

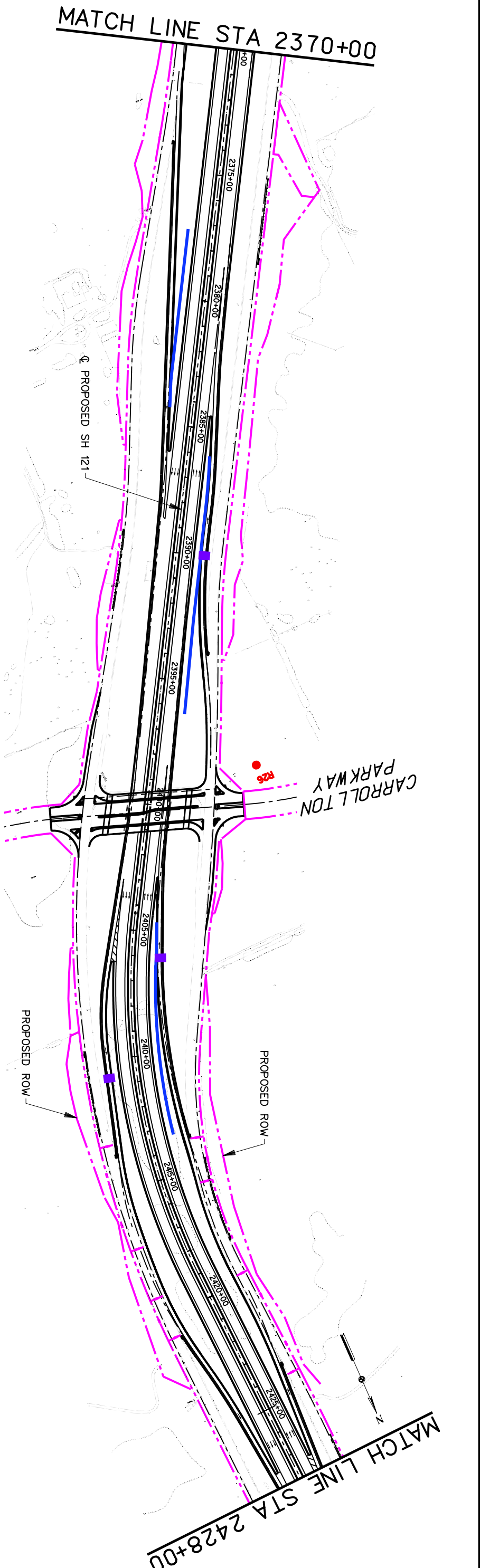

CARROLLTON PARKWAY

MATCH LINE STA 2428+00

MATCH LINE STA 2428+00

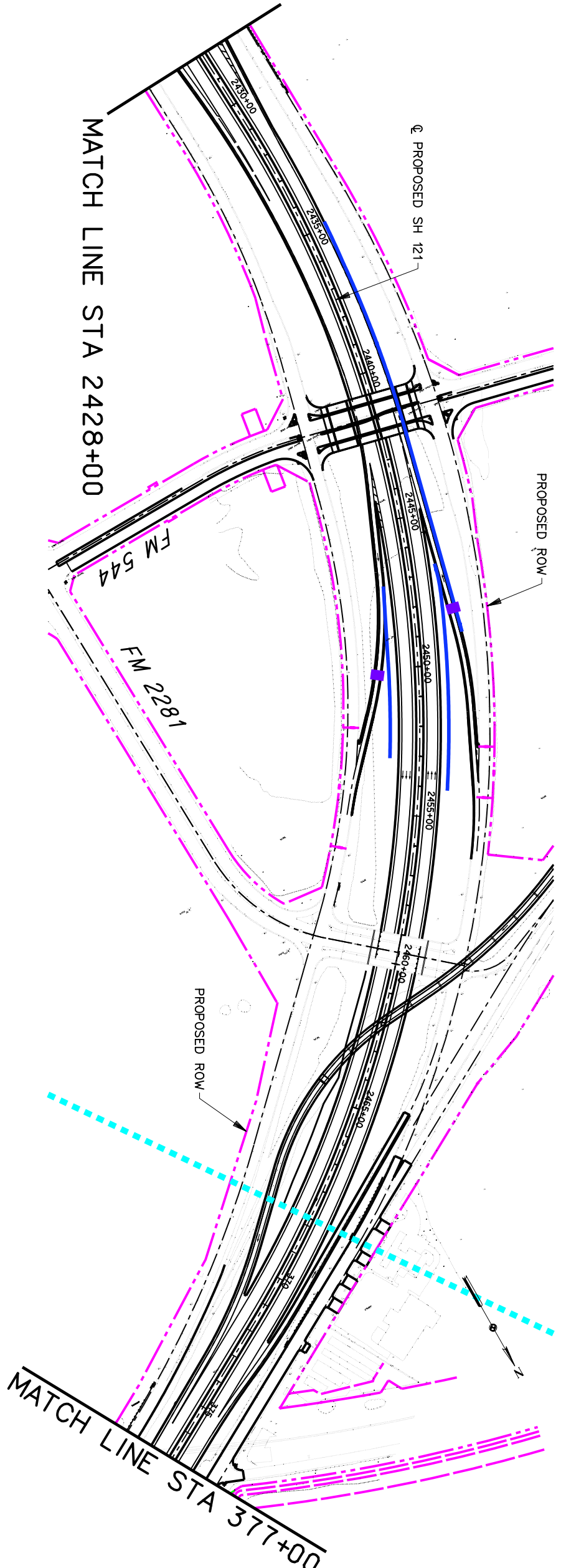

FM 544

FM 2281

MATCH LINE STA 377+00

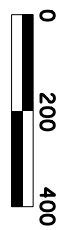

LEGEND

	PROPOSED ROW
	RETAINING WALL
	PROPOSED ETC GANTRY
	AIR RECEIVER LOCATION
	EXISTING NOISE BARRIER
	PROPOSED NOISE BARRIER
	NOISE RECEIVER

© 2005 Texas Department of Transportation

SH 121: FROM EAST OF  
MACARTHUR BLVD.  
TO  
DALLAS NORTH TOLLWAY  
CONCEPTUAL TOLL PLAN



MATCH LINE STA 433+00

MATCH LINE STA 377+00

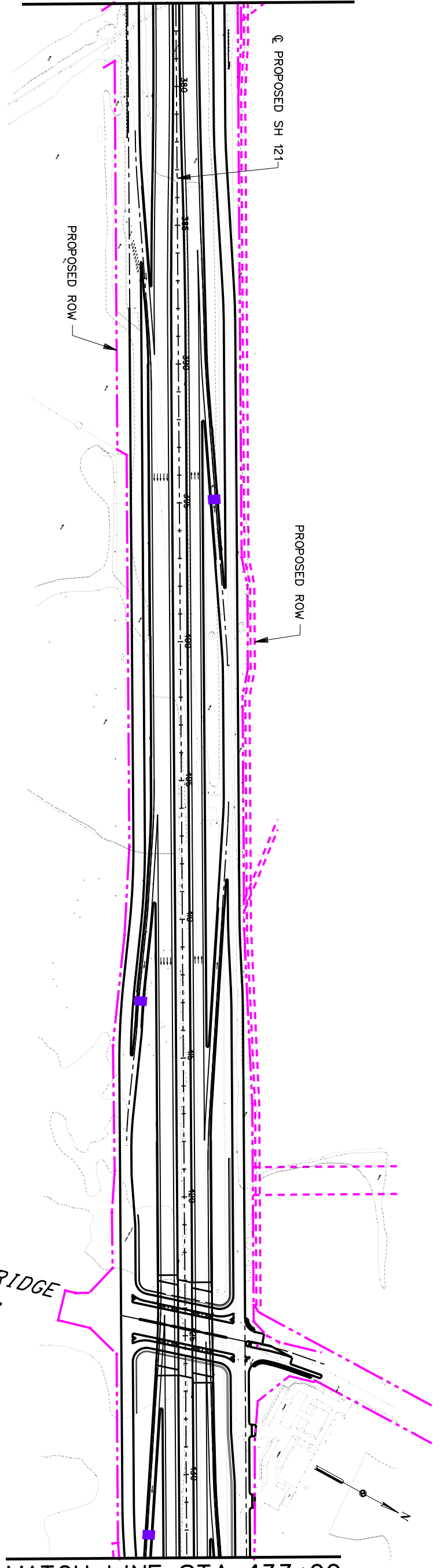
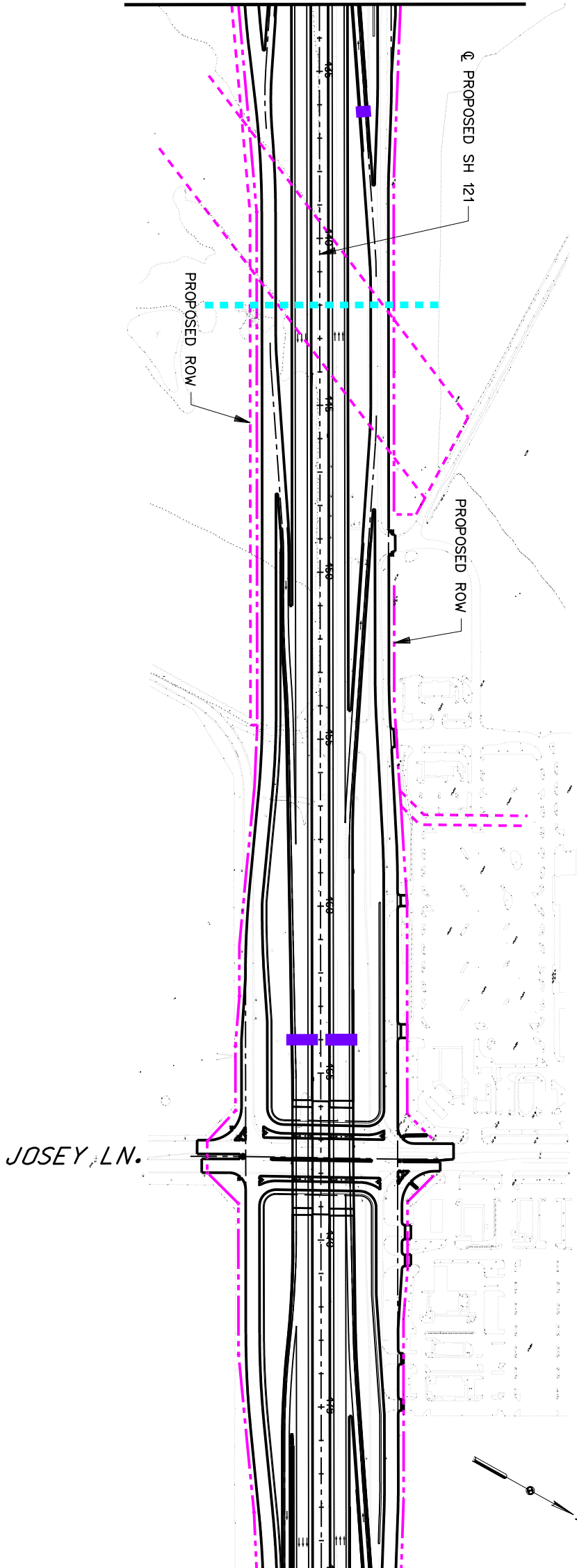

MATCH LINE STA 480+00

MATCH LINE STA 433+00

LEGEND

-  PROPOSED ROW
-  RETAINING WALL
-  PROPOSED ETC GANTRY
-  AIR RECEIVER LOCATION
-  EXISTING NOISE BARRIER
-  PROPOSED NOISE BARRIER
-  NOISE RECEIVER



© 2005  
 Texas Department of Transportation

SH 121 : FROM EAST OF  
 MACARTHUR BLVD.

TO

DALLAS NORTH TOLLWAY  
 CONCEPTUAL TOLL PLAN

MATCH LINE STA 536+00



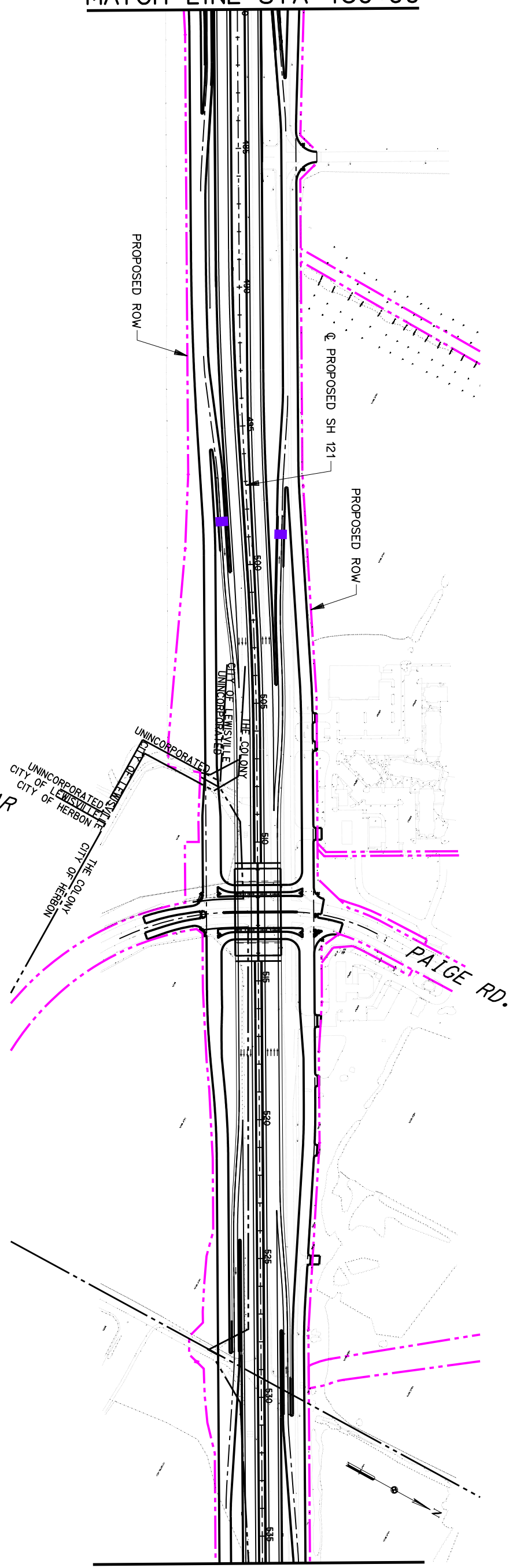
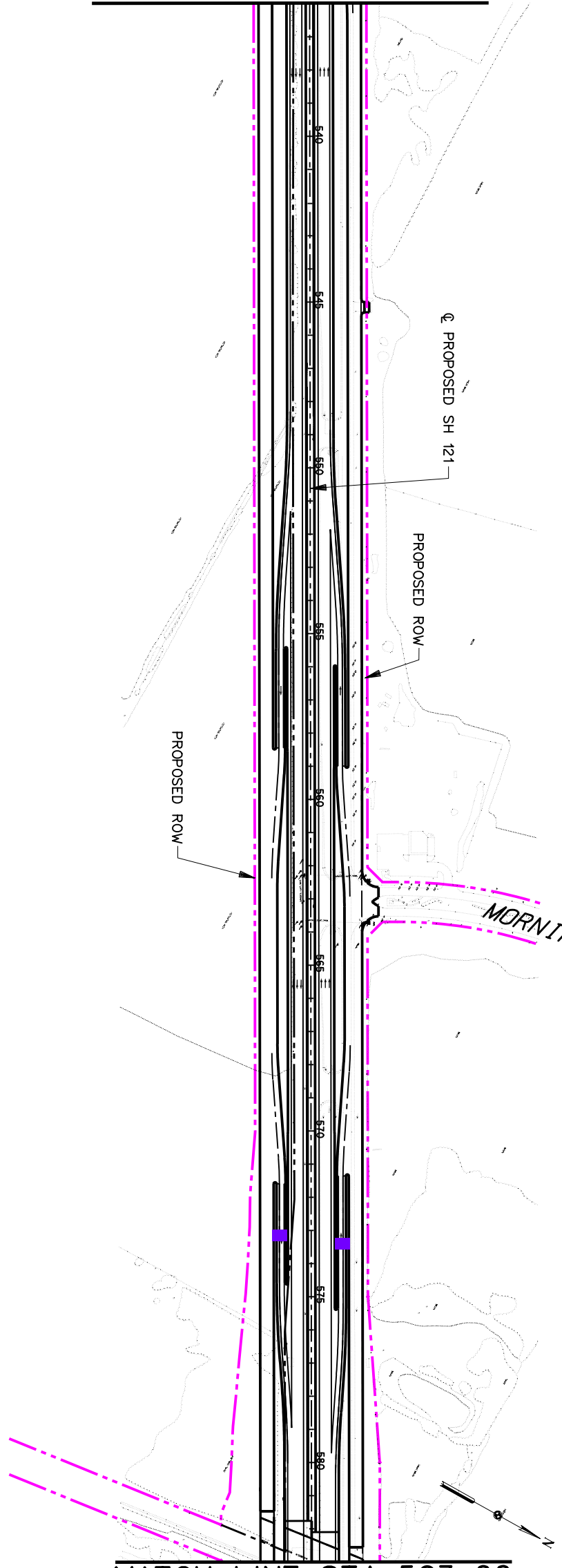

MATCH LINE STA 480+00



MATCH LINE STA 583+00

MATCH LINE STA 536+00

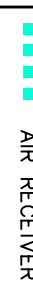
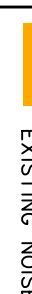
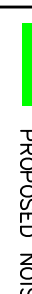
LEGEND

-  PROPOSED ROW
-  RETAINING WALL
-  PROPOSED ETC GANTRY
-  AIR RECEIVER LOCATION
-  EXISTING NOISE BARRIER
-  PROPOSED NOISE BARRIER
-  NOISE RECEIVER

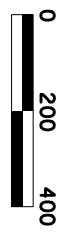

© 2005  
  
 Texas Department of Transportation

SH 121 : FROM EAST OF  
 MACARTHUR BLVD.  
 TO  
 DALLAS NORTH TOLLWAY  
 CONCEPTUAL TOLL PLAN

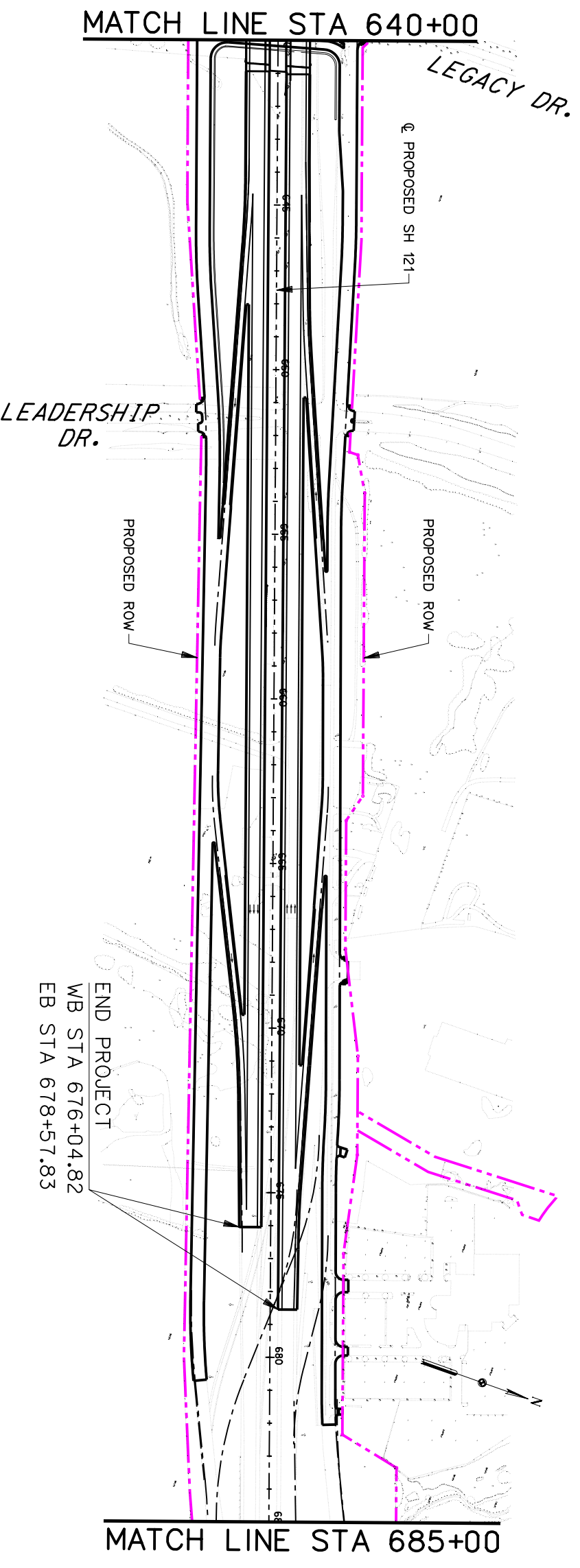

LEGEND

	PROPOSED ROW
	RETAINING WALL
	PROPOSED ETC GANTRY
	AIR RECEIVER LOCATION
	EXISTING NOISE BARRIER
	PROPOSED NOISE BARRIER
	NOISE RECEIVER





END PROJECT  
 WB STA 676+04.82  
 EB STA 678+57.83

© 2005 Texas Department of Transportation  
 SH 121: FROM EAST OF  
 MACARTHUR BLVD.  
 TO  
 DALLAS NORTH TOLLWAY  
 CONCEPTUAL TOLL PLAN

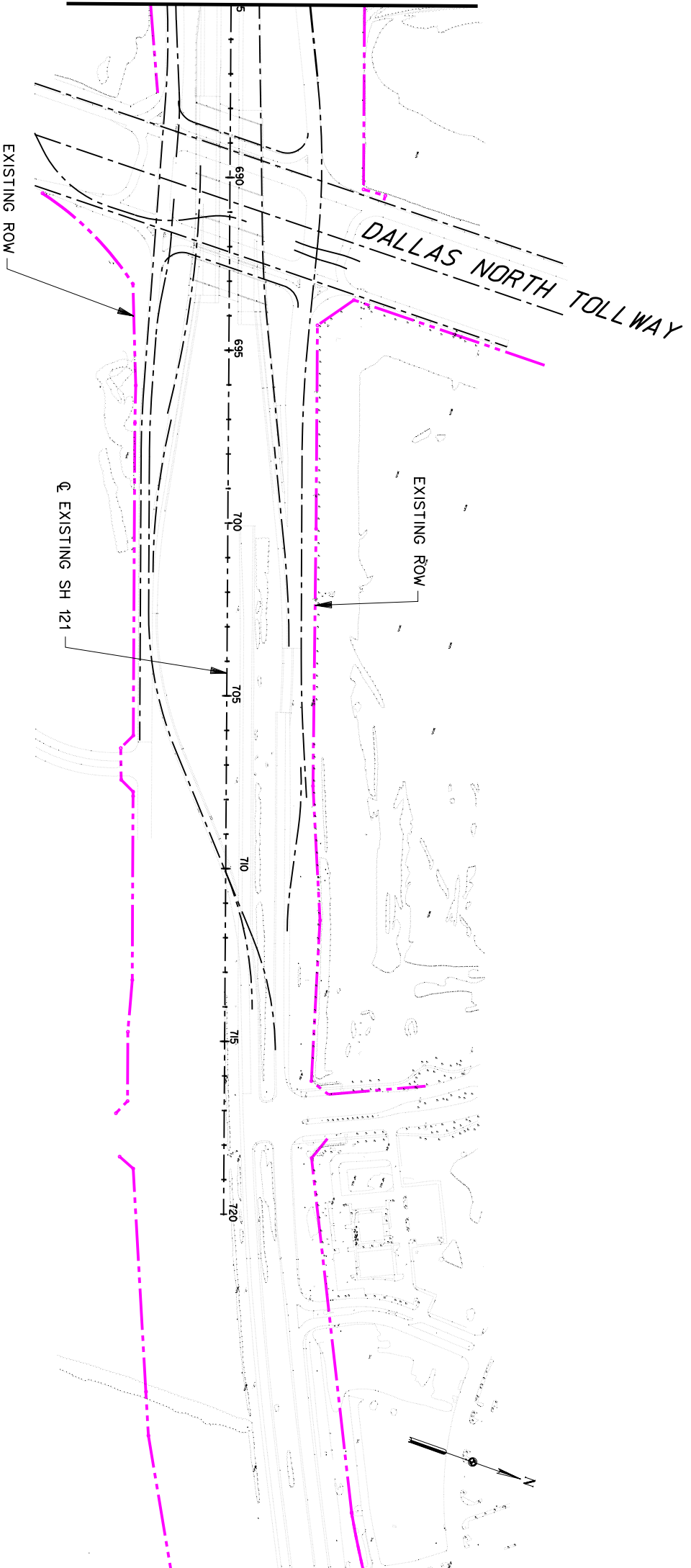
MATCH LINE STA 685+00

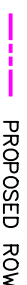
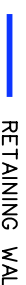
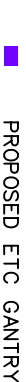
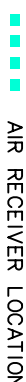
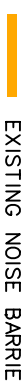
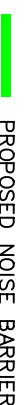

LEGEND

-  PROPOSED ROW
-  RETAINING WALL
-  PROPOSED ETC GANTRY
-  AIR RECEIVER LOCATION
-  EXISTING NOISE BARRIER
-  PROPOSED NOISE BARRIER
-  NOISE RECEIVER



© 2005  Texas Department of Transportation

SH 121 : FROM EAST OF  
MACARTHUR BLVD.  
TO

DALLAS NORTH TOLLWAY  
CONCEPTUAL TOLL PLAN



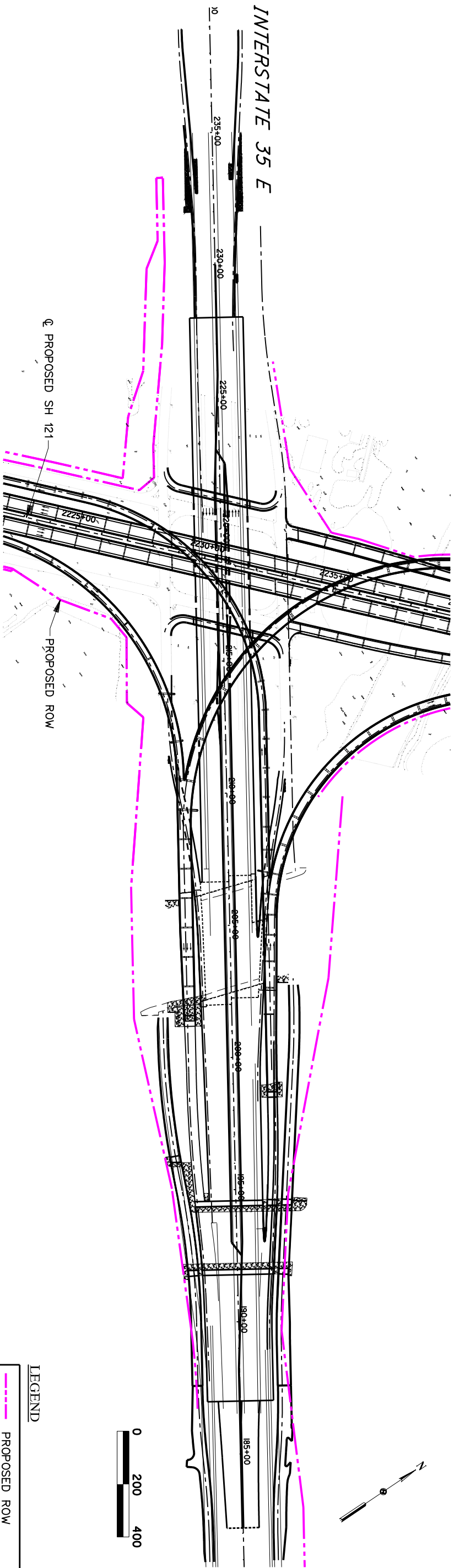

LEGEND

	PROPOSED ROW
	RETAINING WALL
	PROPOSED ETC GANTRY
	AIR RECEIVER LOCATION
	EXISTING NOISE BARRIER
	PROPOSED NOISE BARRIER
	NOISE RECEIVER

© 2005 Texas Department of Transportation

SH 121 : FROM EAST OF  
 MACARTHUR BLVD.  
 TO  
 DALLAS NORTH TOLLWAY  
 CONCEPTUAL TOLL PLAN

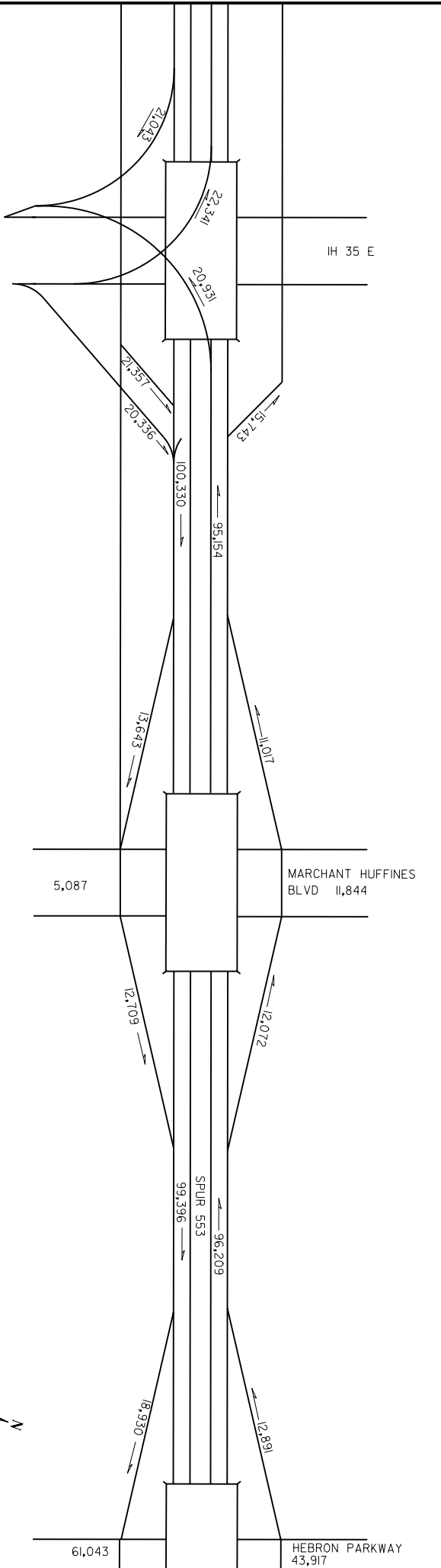

**SH 121 - 2025 NON TOLL**

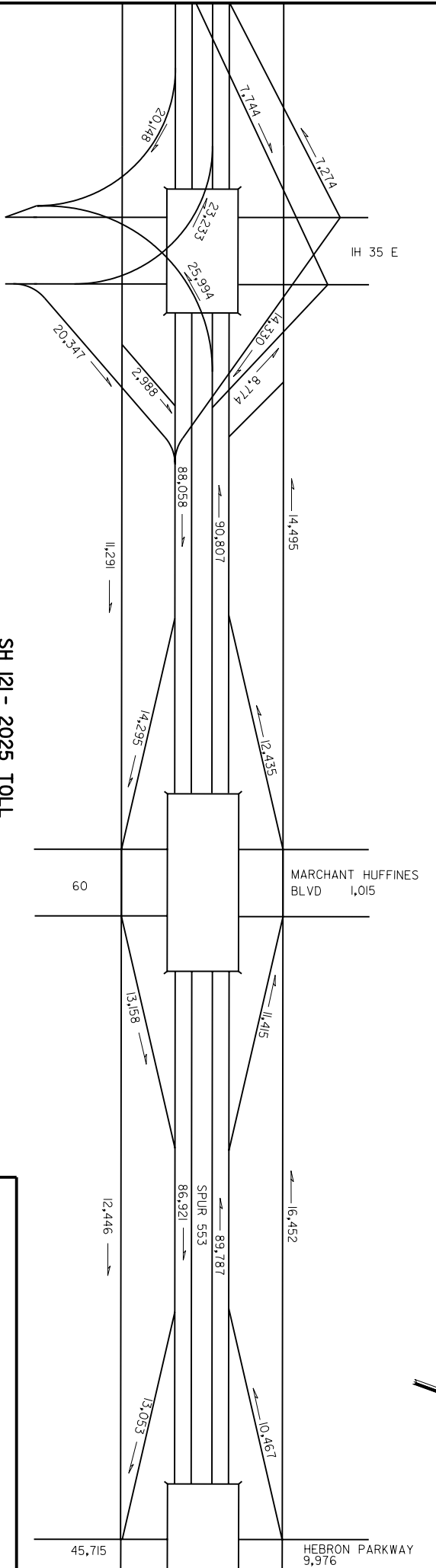

**SH 121 - 2025 TOLL**



SH 121 : FROM EAST OF  
 MACARTHUR BLVD.  
 TO  
 DALLAS NORTH TOLLWAY  
 2025 TRAFFIC VOLUMES

BASED UPON 2025 NCTCOG FINANCIALLY  
 CONSTRAINED TRAFFIC MODEL.

HEBRON PARKWAY  
43,917

← 6,576 → ← 24,993 → ← 18,877 → ← 25,186 →

← 18,817 → ← 6,116 → ← 12,694 → ← 58,323 →

← 64,901 → ← 64,901 → ← 71,017 → ← 74,347 →

← 64,796 → ← 64,796 → ← 61,006 → ← 61,006 →

← 15,670 → ← 9,551 → ← 13,341 → ← 13,341 →

← 8,119 → ← 23,789 → ← 14,238 → ← 20,166 →

← 45,150 →

MIDWAY ROAD  
19,114

← 19,114 →

← 19,114 →

← 19,114 →

← 19,114 →

← 19,114 →

← 19,114 →

← 19,114 →

**SH 121 - 2025 NON TOLL**

CORPORATE DRIVE  
19,833

← 19,833 →

← 19,833 →

← 19,833 →

← 19,833 →

← 19,833 →

← 19,833 →

← 19,833 →

HEBRON PARKWAY  
9,976

← 11,636 → ← 26,257 → ← 14,742 → ← 8,272 →

← 16,430 → ← 11,515 → ← 20,221 → ← 15,881 →

← 62,890 → ← 62,890 → ← 74,405 → ← 74,405 →

← 60,885 → ← 60,885 → ← 69,955 → ← 69,955 →

← 12,983 → ← 9,070 → ← 15,881 → ← 15,881 →

← 11,571 → ← 24,554 → ← 15,484 → ← 7,371 →

← 45,715 →

CORPORATE DRIVE  
7,301

← 7,301 →

← 7,301 →

← 7,301 →

← 7,301 →

← 7,301 →

← 7,301 →

← 7,301 →

MIDWAY ROAD  
10,044

← 10,044 →

← 10,044 →

← 10,044 →

← 10,044 →

← 10,044 →

← 10,044 →

← 10,044 →

**SH 121 - 2025 TOLL**

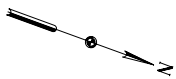

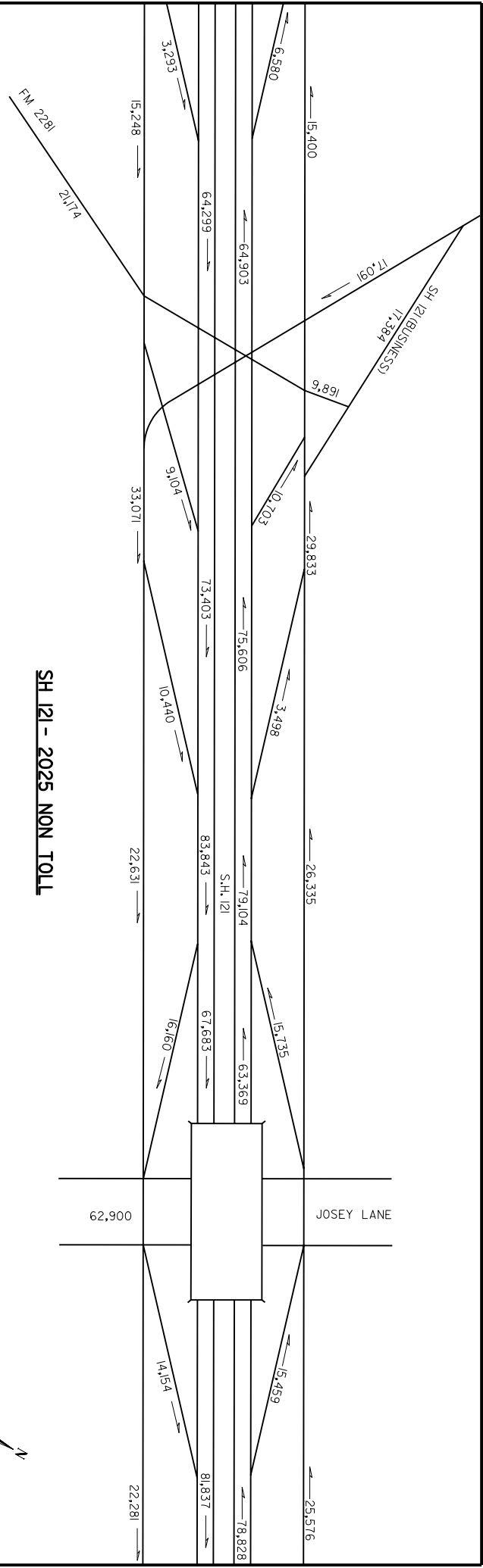

**SH 121 - 2025 NON TOLL**

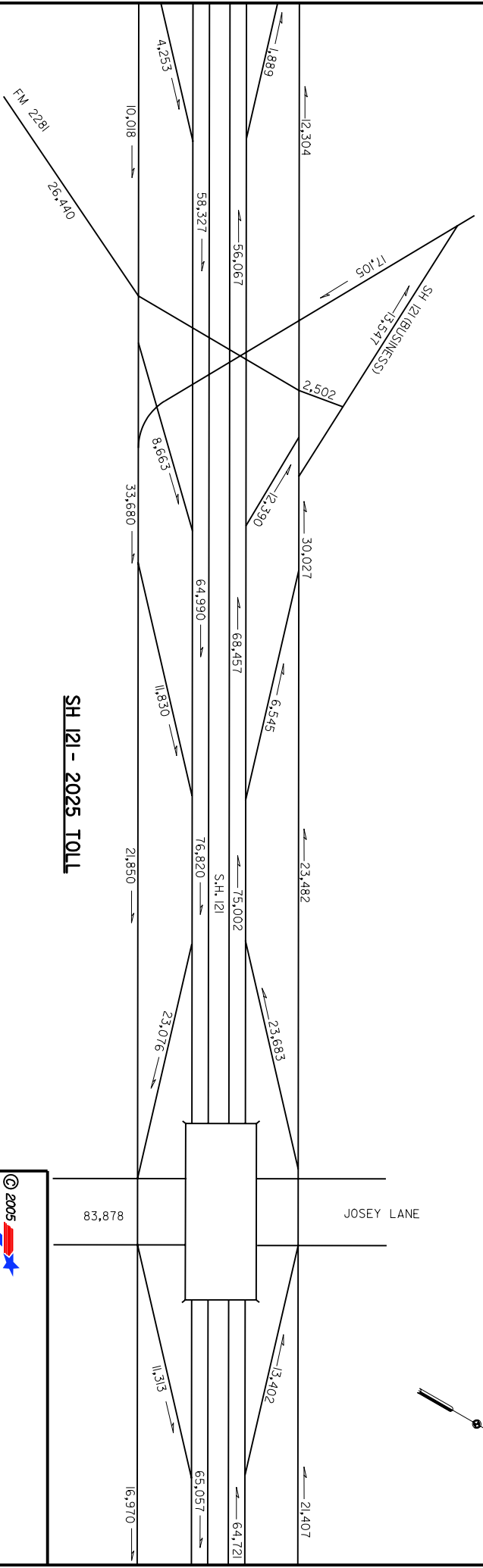

**SH 121 - 2025 TOLL**



  
 © 2005 Texas Department of Transportation

**SH 121 : FROM EAST OF  
 MACARTHUR BLVD.  
 TO  
 DALLAS NORTH TOLLWAY  
 2025 TRAFFIC VOLUMES**

CSJ: 0364-03-065 & 67 SHEET **3** OF **5**

BASED UPON 2025 NCTCOG FINANCIALLY  
 CONSTRAINED TRAFFIC MODEL.

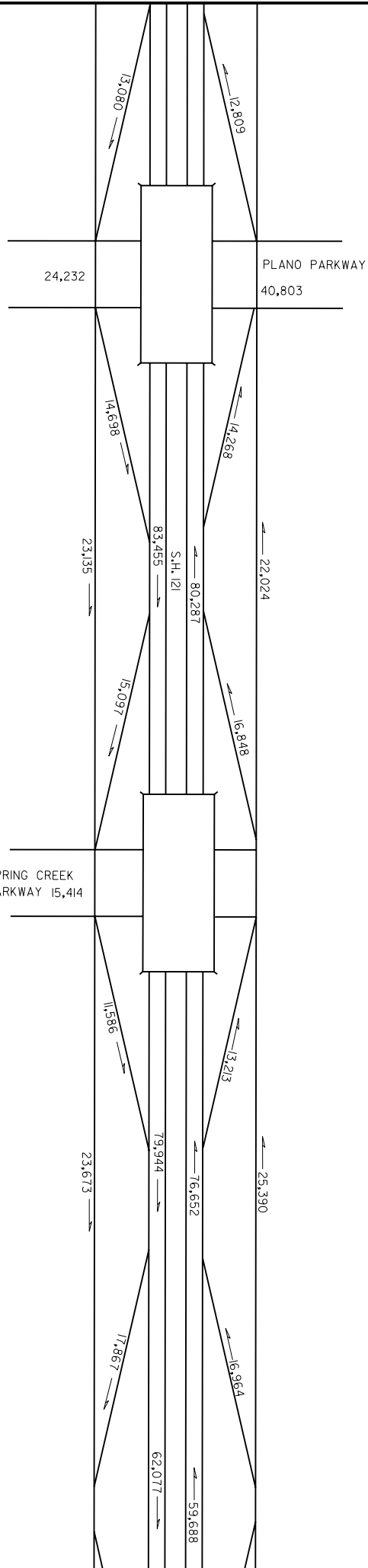



**SH 121 - 2025 NON TOLL**

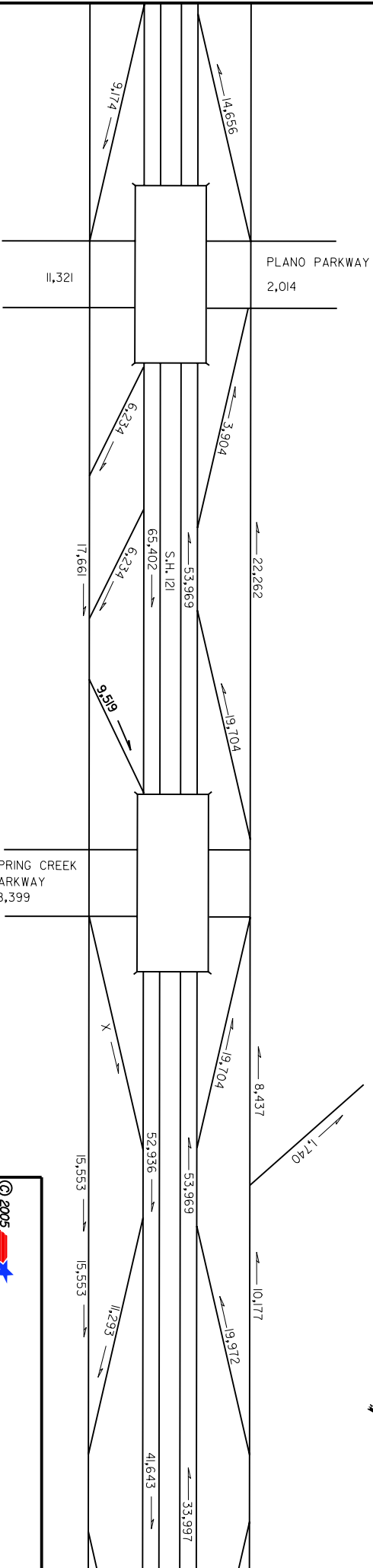

**SH 121 - 2025 TOLL**



BASED UPON 2025 NCTCOG FINANCIALLY  
CONSTRAINED TRAFFIC MODEL.

© 2005 Texas Department of Transportation

SH 121 : FROM EAST OF  
MACARTHUR BLVD.  
TO  
DALLAS NORTH TOLLWAY  
2025 TRAFFIC VOLUMES

CSJ: 0364-03-065 & 67 SHEET 4 OF 5

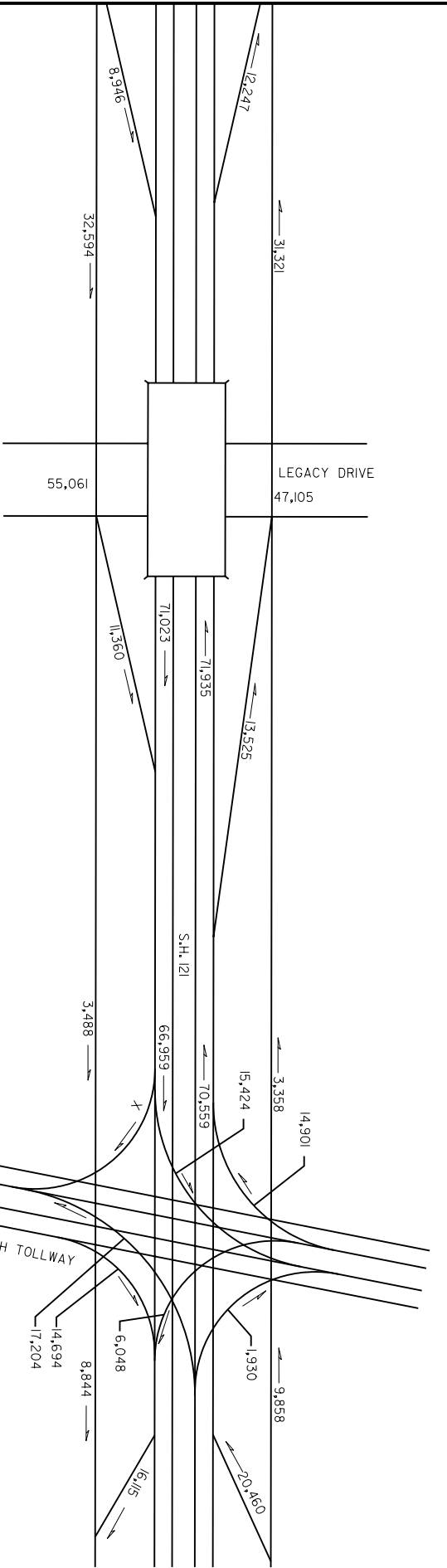

SH 121 - 2025 NON TOLL

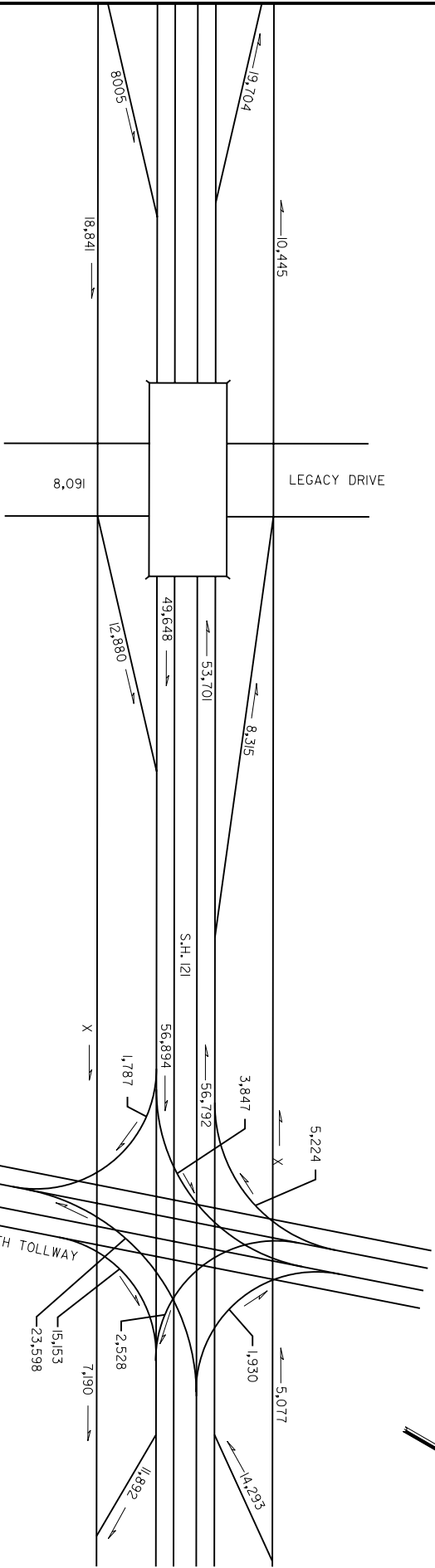

SH 121 - 2025 TOLL

DALLAS NORTH TOLLWAY

LEGACY DRIVE

LEGACY DRIVE

S.H. 121

S.H. 121



SH 121 : FROM EAST OF  
MACARTHUR BLVD.  
TO  
DALLAS NORTH TOLLWAY  
2025 TRAFFIC VOLUMES

BASED UPON 2025 NCTCOG FINANCIALLY  
CONSTRAINED TRAFFIC MODEL.