

TEXAS DEPARTMENT OF TRANSPORTATION
 DALLAS DISTRICT
 DESIGN SCHEMATIC
 MOHAMED K. BUR, P.E., DALLAS DISTRICT ENGINEER
 COLLIN COUNTY

PROJECT LIMIT: EAST OF LAVON PARKWAY
 TO BROWN STREET
 CONTROL:
 2679-03-015 LENGTH 1.117 MILES (5,900.00 FT),
 2679-03-016 LENGTH 2.226 MILES (11,753.33 FT)

FUNCTIONAL CLASS: URBAN COLLECTOR
 PROJECT LENGTH = 3.343 MILES (17,652.33 FT.)
 DESIGN SPEED: 45 MPH



REVISIONS:
 1. REVISED JUNE 2018
 ROLL 1 OF 5
 © 2018 BY TEXAS DEPARTMENT OF TRANSPORTATION
 ALL RIGHTS RESERVED

TEXAS DEPARTMENT OF TRANSPORTATION
 DALLAS DISTRICT
 DESIGN SCHEMATIC
 MOHAMED K. BUR, P.E., DALLAS DISTRICT ENGINEER
 COLLIN COUNTY

PROJECT LIMIT: EAST OF LAVON PARKWAY
 TO BROWN STREET
 CONTROL:
 2679-03-015 LENGTH 1.117 MILES (5,900.00 FT),
 2679-03-016 LENGTH 2.226 MILES (11,753.33 FT)

FUNCTIONAL CLASS: URBAN COLLECTOR
 PROJECT LENGTH = 3.343 MILES (17,652.33 FT.)
 DESIGN SPEED: 45 MPH



REVISIONS:
 1. REVISED JUNE 2018
 ROLL 1 OF 5
 © 2018 BY TEXAS DEPARTMENT OF TRANSPORTATION
 ALL RIGHTS RESERVED

TEXAS DEPARTMENT OF TRANSPORTATION
 DALLAS DISTRICT
 DESIGN SCHEMATIC
 MOHAMED K. BUR, P.E., DALLAS DISTRICT ENGINEER
 COLLIN COUNTY

PROJECT LIMIT: EAST OF LAVON PARKWAY
 TO BROWN STREET
 CONTROL:
 2679-03-015 LENGTH 1.117 MILES (5,900.00 FT),
 2679-03-016 LENGTH 2.226 MILES (11,753.33 FT)

FUNCTIONAL CLASS: URBAN COLLECTOR
 PROJECT LENGTH = 3.343 MILES (17,652.33 FT.)
 DESIGN SPEED: 45 MPH



REVISIONS:
 1. REVISED JUNE 2018
 ROLL 1 OF 5
 © 2018 BY TEXAS DEPARTMENT OF TRANSPORTATION
 ALL RIGHTS RESERVED

TEXAS DEPARTMENT OF TRANSPORTATION
 DALLAS DISTRICT
 DESIGN SCHEMATIC
 MOHAMED K. BUR, P.E., DALLAS DISTRICT ENGINEER
 COLLIN COUNTY

PROJECT LIMIT: EAST OF LAVON PARKWAY
 TO BROWN STREET
 CONTROL:
 2679-03-015 LENGTH 1.117 MILES (5,900.00 FT),
 2679-03-016 LENGTH 2.226 MILES (11,753.33 FT)

FUNCTIONAL CLASS: URBAN COLLECTOR
 PROJECT LENGTH = 3.343 MILES (17,652.33 FT.)
 DESIGN SPEED: 45 MPH



REVISIONS:
 1. REVISED JUNE 2018
 ROLL 1 OF 5
 © 2018 BY TEXAS DEPARTMENT OF TRANSPORTATION
 ALL RIGHTS RESERVED

TEXAS DEPARTMENT OF TRANSPORTATION
 DALLAS DISTRICT
 DESIGN SCHEMATIC
 MOHAMED K. BUR, P.E., DALLAS DISTRICT ENGINEER
 COLLIN COUNTY

PROJECT LIMIT: EAST OF LAVON PARKWAY
 TO BROWN STREET
 CONTROL:
 2679-03-015 LENGTH 1.117 MILES (5,900.00 FT),
 2679-03-016 LENGTH 2.226 MILES (11,753.33 FT)

FUNCTIONAL CLASS: URBAN COLLECTOR
 PROJECT LENGTH = 3.343 MILES (17,652.33 FT.)
 DESIGN SPEED: 45 MPH















NOTES

- EXISTING FEATURES WERE NOT FIELD SURVEYED. SCHEMATICS ARE BASED ON SURVEY INFORMATION DATED MARCH 2015 AND RECORD PLANS.
- FINAL LOCATION OF MEDIAN OPENINGS WILL BE DETERMINED IN THE PS&E DEVELOPMENT PHASE IN COORDINATION WITH THE LOCAL GOVERNMENTS.
- SUPERELEVATION AXIS OF ROTATION IS ABOUT THE PGL.
- DIMENSIONS ARE TO THE EDGE OF PAVEMENT OR NOMINAL FACE OF CURB, MAIL, BARRIER, OR WALL UNLESS NOTED OTHERWISE.
- NO AREAS OF THE PROJECT ARE WITHIN 100 YEAR FLOODPLAIN LIMITS BASED UPON FEMA FLOOD INSURANCE RATE MAP 48085C0420.
- OWNERSHIP INFORMATION SHOWN ON SCHEMATIC OBTAINED FROM COLLIN COUNTY APPRAISAL DISTRICT NOVEMBER 2016.
- EXISTING CULVERT LOCATIONS, SIZE, AND ELEVATIONS OBTAINED FROM RECORD DOCUMENTS AND FIELD SURVEY.
- ADA RAMP AND SIDEWALKS ARE DIAGRAMMATIC ONLY AND WILL BE DESIGNED DURING PS&E. SIDEWALKS ARE SHOWN ON TYPICAL SECTIONS.
- EXISTING DRIVEWAYS WILL REMAIN UNLESS IT IS DETERMINED IN COORDINATION WITH THE LOCAL GOVERNMENT THAT THE DRIVEWAY IS A SAFETY HAZARD AND/OR IS LOCATED WITHIN ACCESS DENIAL LIMITS SHOWN.
- BUILDINGS ARE SHOWN AS POTENTIAL DISPLACEMENT IF THE PROPOSED ROW PHYSICALLY INTERSECTS THE EXISTING BUILDING STRUCTURE.
- CURBS ARE TYPE II (8") UNLESS NOTED OTHERWISE.
- CONVENTIONAL ROADWAY SIGNAGE (SMALL SIGNS) ARE NOT SHOWN AND WILL BE DEVELOPED DURING THE PS&E PHASE OF THE PROJECT.

LEGEND

- PARKER
- DIRECTION OF TRAFFIC
- CENTERLINE
- EXISTING ROW
- PROPOSED ROW
- CITY LIMITS
- PROPOSED PROPERTY LINE
- PAVEMENT REMOVAL
- PROPOSED DRAINAGE STRUCTURE
- EXISTING DRAINAGE STRUCTURE
- PROPOSED DITCH FLOW LINE
- EXISTING DITCH FLOW LINE
- DRAINAGE ROW EASEMENT
- CONSTRUCTION EASEMENT
- EXISTING WATER LINE
- EXISTING WASTEWATER FORCE MAIN
- EXISTING WASTEWATER LINE
- EXISTING GAS LINE
- EXISTING FIBER OPTIC LINE
- EXISTING OVERHEAD ELECTRIC LINE
- PROPOSED RETAINING WALL FILL
- PROPOSED NOISE WALL

TRAFFIC DIAGRAM












CURVE DATA

CURVE	PI STATION	DELTA	RADIUS	TANGENT	CHORD LENGTH	CHORD BEARING	PC STATION	PT STATION	
PARKER-1	529+76.78	23° 23' 12" (RT)	825.55	1,293.59	5.45° 42' 22" E	1,163.56	531+91.22	544+44.81	
PARKER-2	570+68.71	47° 10' 45" (RT)	3,120.00	178.50	5° 2' 45" W	336.41	574+64.81	577+86.74	
PARKER-3	592+00.89	5° 20' 48" (LT)	1,050.00	329.18	5° 3' 21" W	651.65	588+71.71	595+29.40	
PARKER-4	615+31.11	60° 40' 55" (LT)	800.00	466.25	67° 28' 39" W	808.23	610+42.86	619+10.14	
PARKER-5	620+84.42	61° 22' 16" (RT)	850.00	504.40	5° 29' 18" E	887.55	637+00.01	630+09.47	
PARKER-6	646+29.48	91° 11' 48" (LT)	835.00	852.62	1,329.05	5° 44' 13" E	1,193.13	637+76.64	651+05.89
PARKER-7	669+09.63	89° 15' 23" (RT)	824.23	1,300.78	5° 45' 11" E	1,175.18	660+45.40	673+86.18	
PARKER-8	688+58.62	11° 33' 31" (RT)	29,377.00	408.29	5° 0' 13" W	816.31	684+12.42	692+43.76	
PARKER-9	693+86.76	2° 31' 45" (LT)	5,000.00	110.37	220.7	5° 0' 15" E	220.69	692+86.39	695+09.09
PARKER-10	696+26.45	2° 41' 21" (RT)	5,000.00	117.36	234.67	5° 0' 11" E	234.65	695+09.09	697+43.76
SPHAL	2+10.86	55° 36' 10" (RT)	109.00	57.47	105.78	61° 49' 55" E	101.68	1+53.99	2+19.16
PARKER-11	674+38.38	68° 52' 21" (LT)	109.00	73.58	129.44	5° 33' 58" W	121.97	671+41.61	1+40.74
PARKER-12	5+83.74	88° 40' 19" (LT)	210.00	205.19	325.00	5° 44' 43" E	293.52	3+78.55	7+53.55
PARKER-13	9+80.47	68° 17' 55" (LT)	109.00	73.94	129.93	5° 56' 47" E	122.37	9+06.53	10+36.46

SUPERELEVATION AND SPLIT PROFILE DATA

PARKER SUPERELEVATION AND SPLIT PROFILE DATA - RIGHT SIDE				PARKER SUPERELEVATION AND SPLIT PROFILE DATA - LEFT SIDE			
MATCH EX ROAD	BASELINE	PROFITE	STATION	STATION	STATION	STATION	STATION
END NORMAL CROWN/BEGIN TRANSITION	no change	no change	548+60.00	548+60.00	END NORMAL CROWN/BEGIN TRANSITION	no change	548+60.00
END TRANSITION/BEGIN FULL SUPER	no change	no change	551+00.00	551+00.00	END TRANSITION/BEGIN FULL SUPER	no change	551+00.00
END FULL SUPER/BEGIN TRANSITION	no change	no change	554+00.00	554+00.00	END FULL SUPER/BEGIN TRANSITION	no change	554+00.00
END TRANSITION/BEGIN NORMAL CROWN	no change	no change	567+40.00	567+40.00	END TRANSITION/BEGIN NORMAL CROWN	no change	567+40.00
END CL PROF/BEGIN SPLIT NB-SB PROFILES	no change	no change	613+00.00	613+00.00	END CL PROF/BEGIN SPLIT NB-SB PROFILES	no change	613+00.00
END NB-SB PROFILES/BEGIN CL PROFILE	no change	no change	623+00.00	623+00.00	END NB-SB PROFILES/BEGIN CL PROFILE	no change	623+00.00
END CL PROF/BEGIN SPLIT NB-SB PROFILES	no change	no change	625+00.00	625+00.00	END CL PROF/BEGIN SPLIT NB-SB PROFILES	no change	625+00.00
END NB-SB PROFILES/BEGIN CL PROFILE	no change	no change	630+00.00	630+00.00	END NB-SB PROFILES/BEGIN CL PROFILE	no change	630+00.00
END FULL SUPER/BEGIN TRANSITION	no change	no change	630+70.00	630+70.00	END FULL SUPER/BEGIN TRANSITION	no change	630+70.00
END TRANSITION/BEGIN NORMAL CROWN	no change	no change	632+00.00	632+00.00	END TRANSITION/BEGIN NORMAL CROWN	no change	632+00.00
END NORMAL CROWN/BEGIN FULL SUPER	no change	no change	633+00.00	633+00.00	END NORMAL CROWN/BEGIN FULL SUPER	no change	633+00.00
END FULL SUPER/BEGIN TRANSITION	no change	no change	633+70.00	633+70.00	END FULL SUPER/BEGIN TRANSITION	no change	633+70.00
END TRANSITION/BEGIN NORMAL CROWN	no change	no change	634+00.00	634+00.00	END TRANSITION/BEGIN NORMAL CROWN	no change	634+00.00
END NORMAL CROWN/BEGIN FULL SUPER	no change	no change	634+70.00	634+70.00	END NORMAL CROWN/BEGIN FULL SUPER	no change	634+70.00
END FULL SUPER/BEGIN TRANSITION	no change	no change	635+00.00	635+00.00	END FULL SUPER/BEGIN TRANSITION	no change	635+00.00
END TRANSITION/BEGIN NORMAL CROWN	no change	no change	635+70.00	635+70.00	END TRANSITION/BEGIN NORMAL CROWN	no change	635+70.00
END NORMAL CROWN/BEGIN FULL SUPER	no change	no change	636+00.00	636+00.00	END NORMAL CROWN/BEGIN FULL SUPER	no change	636+00.00
END FULL SUPER/BEGIN TRANSITION	no change	no change	636+70.00	636+70.00	END FULL SUPER/BEGIN TRANSITION	no change	636+70.00
END TRANSITION/BEGIN NORMAL CROWN	no change	no change	637+00.00	637+00.00	END TRANSITION/BEGIN NORMAL CROWN	no change	637+00.00
END NORMAL CROWN/BEGIN FULL SUPER	no change	no change	637+70.00	637+70.00	END NORMAL CROWN/BEGIN FULL SUPER	no change	637+70.00
END FULL SUPER/BEGIN TRANSITION	no change	no change	638+00.00	638+00.00	END FULL SUPER/BEGIN TRANSITION	no change	638+00.00
END TRANSITION/BEGIN NORMAL CROWN	no change	no change	638+70.00	638+70.00	END TRANSITION/BEGIN NORMAL CROWN	no change	638+70.00
END NORMAL CROWN/BEGIN FULL SUPER	no change	no change	639+00.00	639+00.00	END NORMAL CROWN/BEGIN FULL SUPER	no change	639+00.00
END FULL SUPER/BEGIN TRANSITION	no change	no change	639+70.00	639+70.00	END FULL SUPER/BEGIN TRANSITION	no change	639+70.00
END TRANSITION/BEGIN NORMAL CROWN	no change	no change	640+00.00	640+00.00	END TRANSITION/BEGIN NORMAL CROWN	no change	640+00.00
END NORMAL CROWN/BEGIN FULL SUPER	no change	no change	640+70.00	640+70.00	END NORMAL CROWN/BEGIN FULL SUPER	no change	640+70.00
END FULL SUPER/BEGIN TRANSITION	no change	no change	641+00.00	641+00.00	END FULL SUPER/BEGIN TRANSITION	no change	641+00.00
END TRANSITION/BEGIN NORMAL CROWN	no change	no change	641+70.00	641+70.00	END TRANSITION/BEGIN NORMAL CROWN	no change	641+70.00
END NORMAL CROWN/BEGIN FULL SUPER	no change	no change	642+00.00	642+00.00	END NORMAL CROWN/BEGIN FULL SUPER	no change	642+00.00
END FULL SUPER/BEGIN TRANSITION	no change	no change	642+70.00	642+70.00	END FULL SUPER/BEGIN TRANSITION	no change	642+70.00
END TRANSITION/BEGIN NORMAL CROWN	no change	no change	643+00.00	643+00.00	END TRANSITION/BEGIN NORMAL CROWN	no change	643+00.00
END NORMAL CROWN/BEGIN FULL SUPER	no change	no change	643+70.00	643+70.00	END NORMAL CROWN/BEGIN FULL SUPER	no change	643+70.00
END FULL SUPER/BEGIN TRANSITION	no change	no change	644+00.00	644+00.00	END FULL SUPER/BEGIN TRANSITION	no change	644+00.00
END TRANSITION/BEGIN NORMAL CROWN	no change	no change	644+70.00	644+70.00	END TRANSITION/BEGIN NORMAL CROWN	no change	644+70.00
END NORMAL CROWN/BEGIN FULL SUPER	no change	no change	645+00.00	645+00.00	END NORMAL CROWN/BEGIN FULL SUPER	no change	645+00.00
END FULL SUPER/BEGIN TRANSITION	no change	no change	645+70.00	645+70.00	END FULL SUPER/BEGIN TRANSITION	no change	645+70.00
END TRANSITION/BEGIN NORMAL CROWN	no change	no change	646+00.00	646+00.00	END TRANSITION/BEGIN NORMAL CROWN	no change	646+00.00
END NORMAL CROWN/BEGIN FULL SUPER	no change	no change	646+70.00	646+70.00	END NORMAL CROWN/BEGIN FULL SUPER	no change	646+70.00
END FULL SUPER/BEGIN TRANSITION	no change	no change	647+00.00	647+00.00	END FULL SUPER/BEGIN TRANSITION	no change	647+00.00
END TRANSITION/BEGIN NORMAL CROWN	no change	no change	647+70.00	647+70.00	END TRANSITION/BEGIN NORMAL CROWN	no change	647+70.00
END NORMAL CROWN/BEGIN FULL SUPER	no change	no change	648+00.00	648+00.00	END NORMAL CROWN/BEGIN FULL SUPER	no change	648+00.00
END FULL SUPER/BEGIN TRANSITION	no change	no change	648+70.00	648+70.00	END FULL SUPER/BEGIN TRANSITION	no change	648+70.00
END TRANSITION/BEGIN NORMAL CROWN	no change	no change	649+00.00	649+00.00	END TRANSITION/BEGIN NORMAL CROWN	no change	649+00.00
END NORMAL CROWN/BEGIN FULL SUPER	no change	no change	649+70.00	649+70.00	END NORMAL CROWN/BEGIN FULL SUPER	no change	649+70.00
END FULL SUPER/BEGIN TRANSITION	no change	no change	650+00.00	650+00.00	END FULL SUPER/BEGIN TRANSITION	no change	650+00.00
END TRANSITION/BEGIN NORMAL CROWN	no change	no change	650+70.00	650+70.00	END TRANSITION/BEGIN NORMAL CROWN	no change	650+70.00
END NORMAL CROWN/BEGIN FULL SUPER	no change	no change	651+00.00	651+00.00	END NORMAL CROWN/BEGIN FULL SUPER	no change	651+00.00
END FULL SUPER/BEGIN TRANSITION	no change	no change	651+70.00	651+70.00	END FULL SUPER/BEGIN TRANSITION	no change	651+70.00
END TRANSITION/BEGIN NORMAL CROWN	no change	no change	652+00.00	652+00.00	END TRANSITION/BEGIN NORMAL CROWN	no change	652+00.00
END NORMAL CROWN/BEGIN FULL SUPER	no change	no change	652+70.00	652+70.00	END NORMAL CROWN/BEGIN FULL SUPER	no change	652+70.00
END FULL SUPER/BEGIN TRANSITION	no change	no change	653+00.00	653+00.00	END FULL SUPER/BEGIN TRANSITION	no change	653+00.00
END TRANSITION/BEGIN NORMAL CROWN	no change	no change	653+70.00	653+70.00	END TRANSITION/BEGIN NORMAL CROWN	no change	653+70.00
END NORMAL CROWN/BEGIN FULL SUPER	no change	no change	654+00.00	654+00.00	END NORMAL CROWN/BEGIN FULL SUPER	no change	654+00.00
END FULL SUPER/BEGIN TRANSITION</							

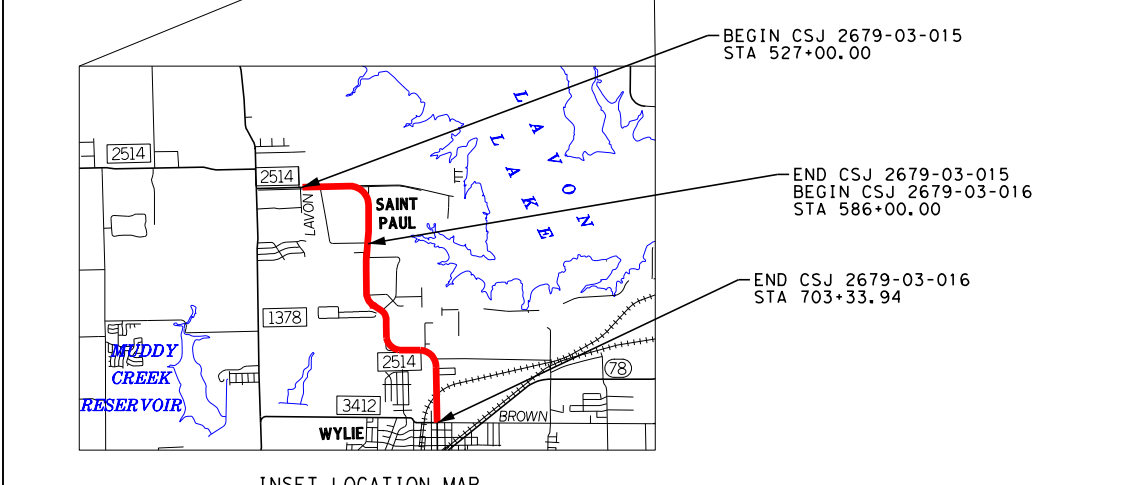
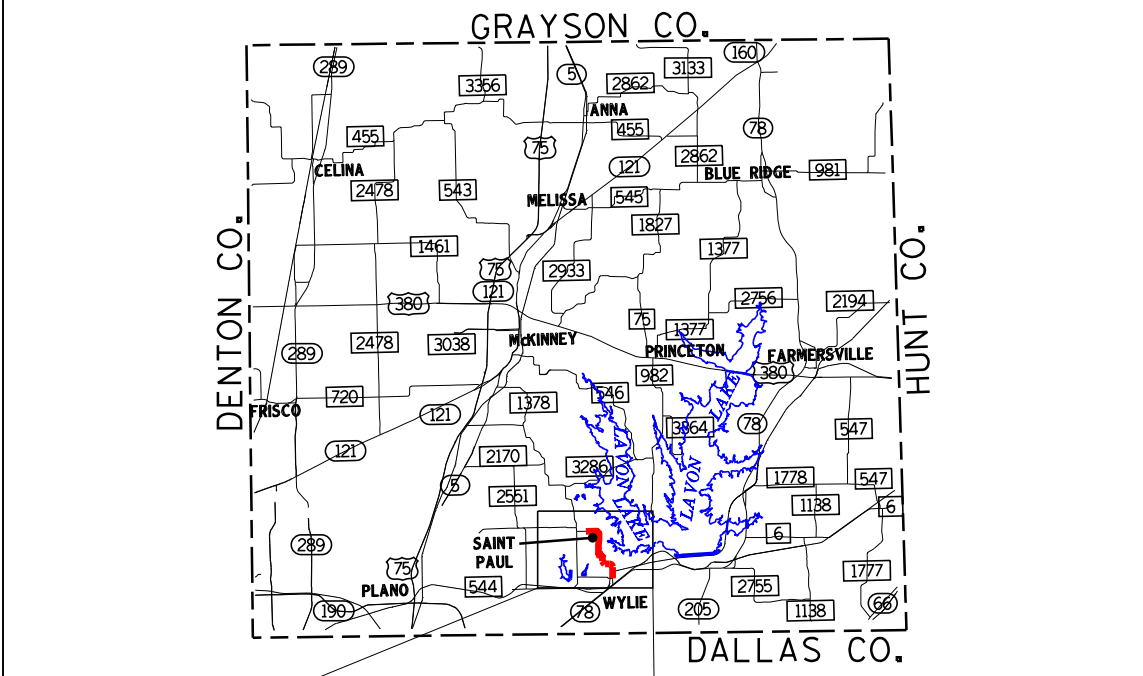

LOCATION MAP
 PRELIMINARY FOR REVIEW ONLY
 THESE DOCUMENTS ARE FOR REVIEW AND NOT INTENDED FOR BIDDING OR CONSTRUCTION PURPOSES. THEY WERE PREPARED BY OR UNDER THE SUPERVISION OF:

- NOTES**
- EXISTING FEATURES WERE NOT FIELD SURVEYED. SCHEMATICS ARE BASED ON SURVEY INFORMATION DATED MARCH 2015 AND RECORD PLANS.
 - FINAL LOCATION OF THE MEDIAN OPENINGS WILL BE DETERMINED IN THE PS&E DEVELOPMENT PHASE IN COORDINATION WITH THE LOCAL GOVERNMENT.
 - SUPERELEVATION AXIS OF ROTATION IS ABOUT THE PGL.
 - DIMENSIONS ARE TO THE EDGE OF PAVEMENT OR NOMINAL FACE OF CURB, RAIL, BARRIER, OR WALL UNLESS NOTED OTHERWISE.
 - NO AREAS OF THE PROJECT ARE WITHIN 10 YEAR FLOODPLAIN LIMITS BASED UPON FEMA FLOOD INSURANCE RATE MAP 88083C020J.
 - OWNERSHIP INFORMATION SHOWN ON SCHEMATIC OBTAINED FROM COLLIN COUNTY APPRAISAL DISTRICT NOVEMBER 2016.
 - EXISTING CULVERT LOCATIONS, SIZE, AND ELEVATIONS OBTAINED FROM RECORD DOCUMENTS AND FIELD SURVEY.
 - ADA RAMP AND SIDEWALK ARE DIAGRAMMED AND WILL BE DESIGNED DURING PS&E. SIDEWALKS ARE SHOWN ON TYPICAL SECTIONS.
 - EXISTING DRIVEWAYS WILL REMAIN UNLESS IT IS DETERMINED IN COORDINATION WITH THE LOCAL GOVERNMENT THAT THE DRIVEWAY IS A SAFETY ISSUE AND/OR IS LOCATED WITHIN ACCESS DENIAL LIMITS SHOWN.
 - BUILDINGS ARE SHOWN AS POTENTIAL DISPLACEMENT IF THE PROPOSED ROW PHYSICALLY INTERSECTS THE EXISTING BUILDING STRUCTURE.
 - CURBS ARE TYPE 11 (8") UNLESS NOTED OTHERWISE.
 - CONVENTIONAL ROADWAY SIGNAGE (SMALL SIGNS) ARE NOT SHOWN AND WILL BE DEVELOPED DURING THE PS&E PHASE OF THE PROJECT.

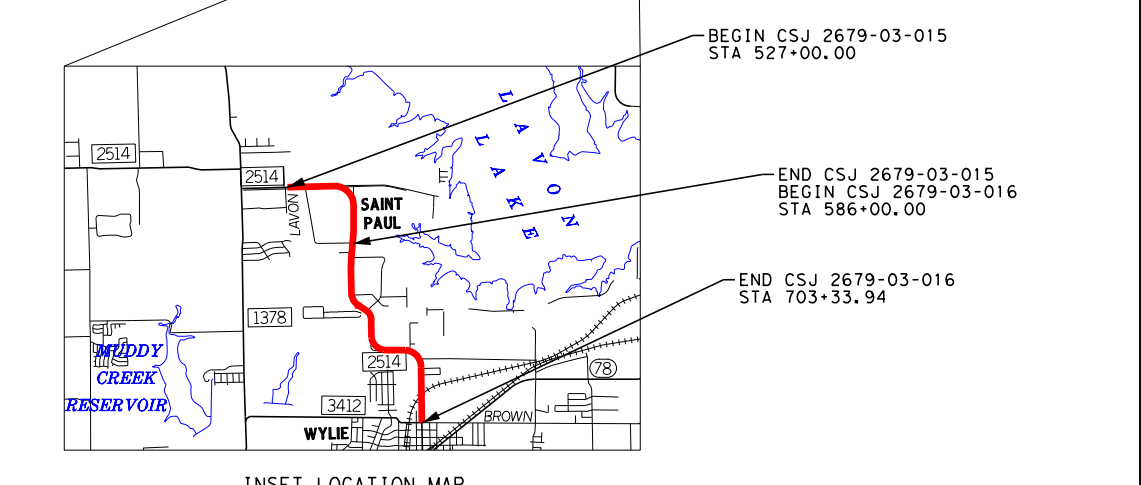
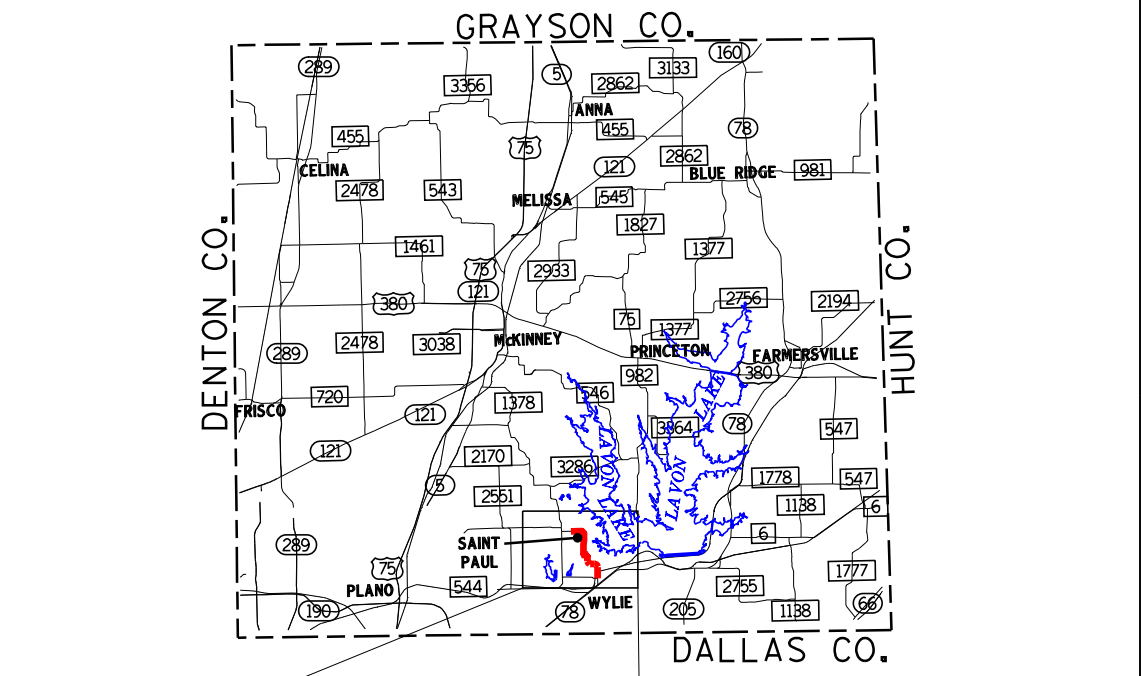
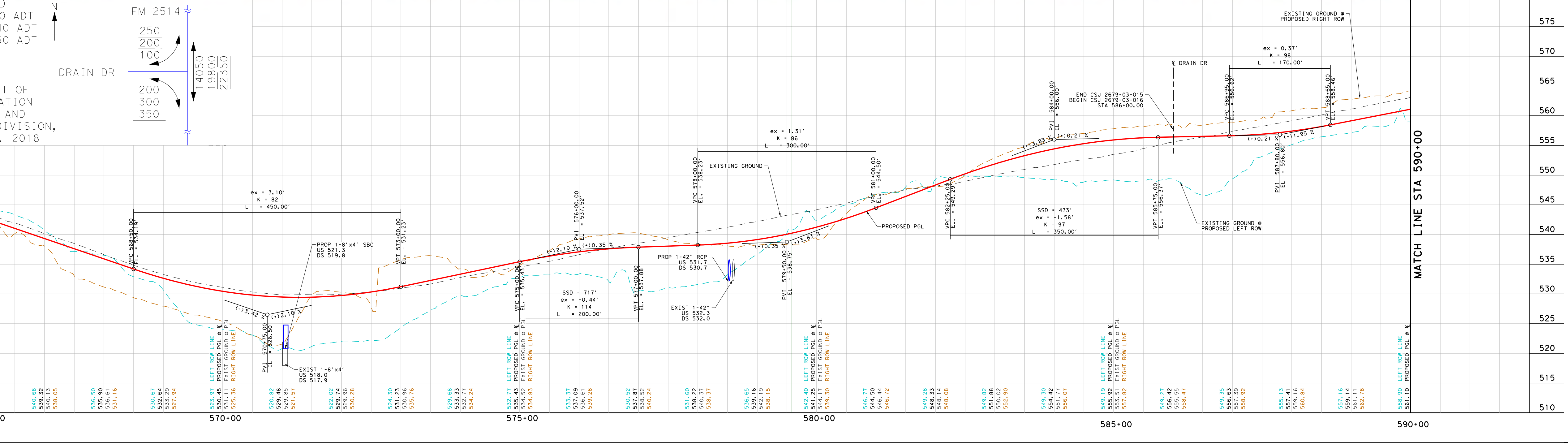
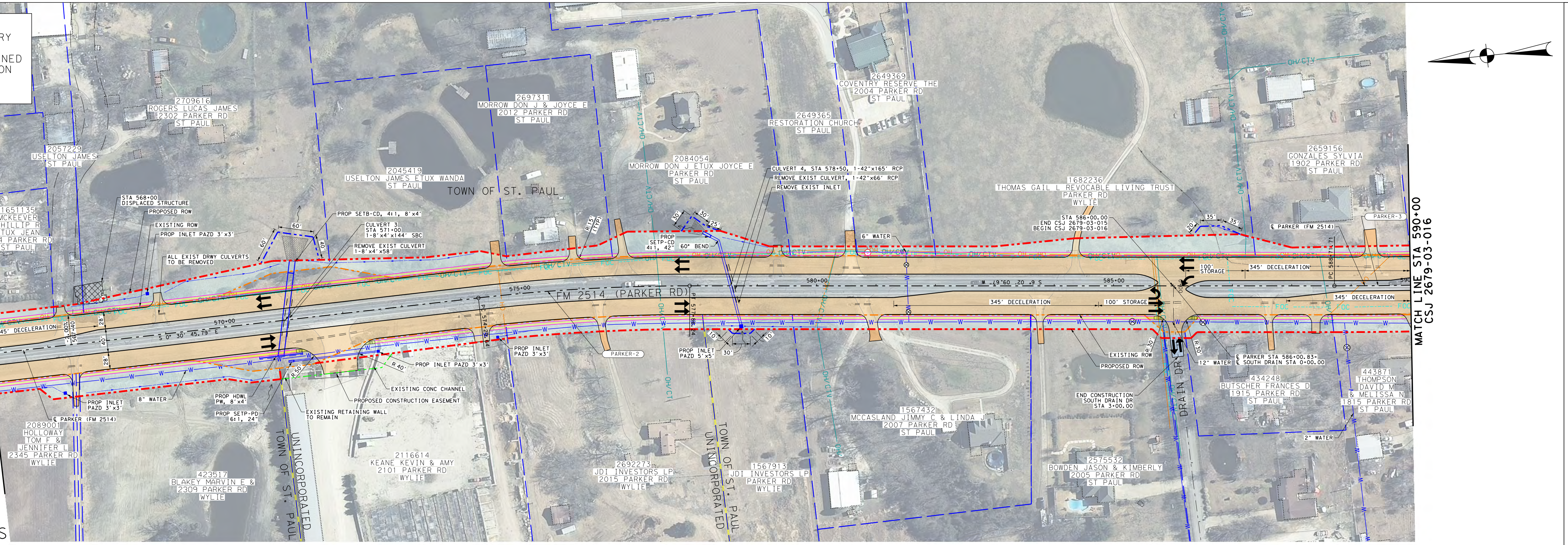
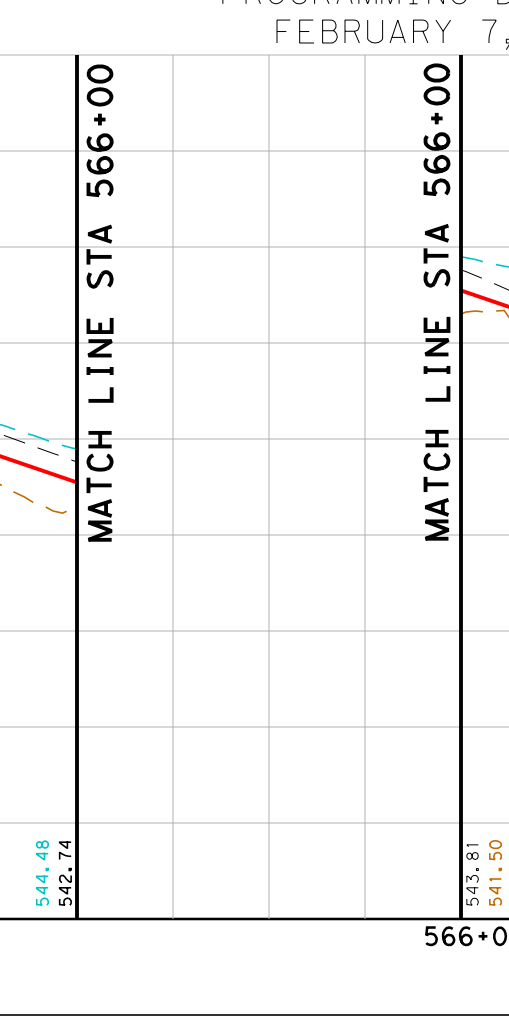
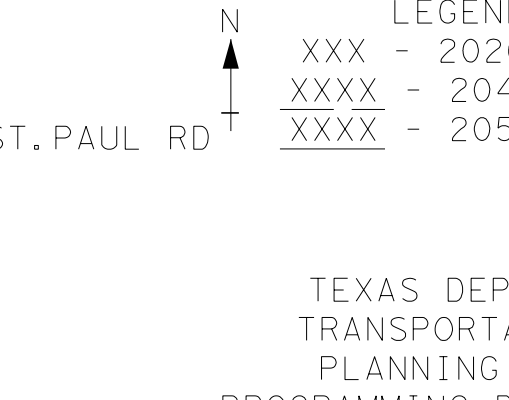
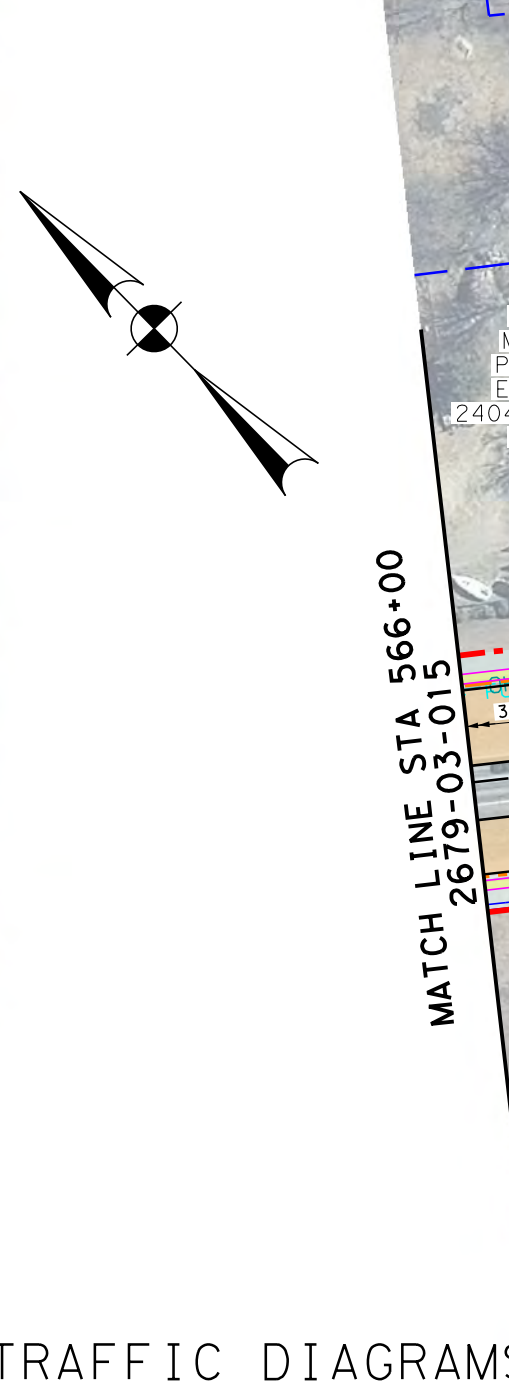
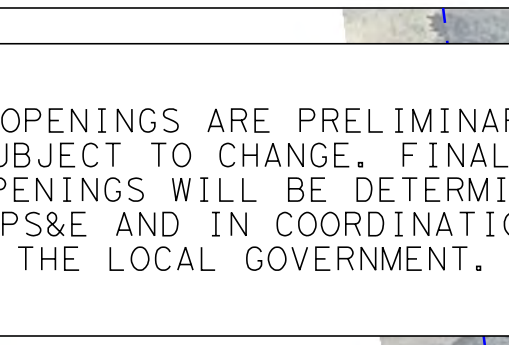
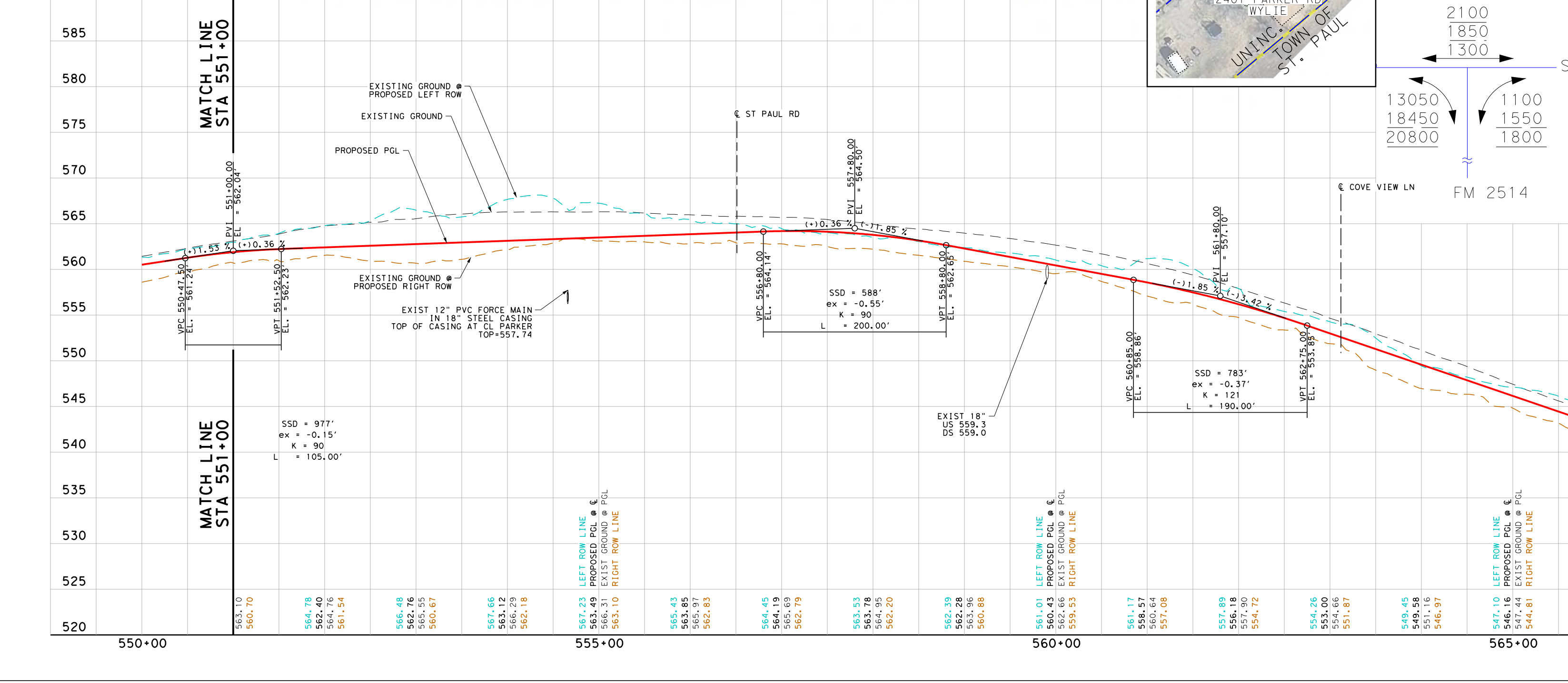
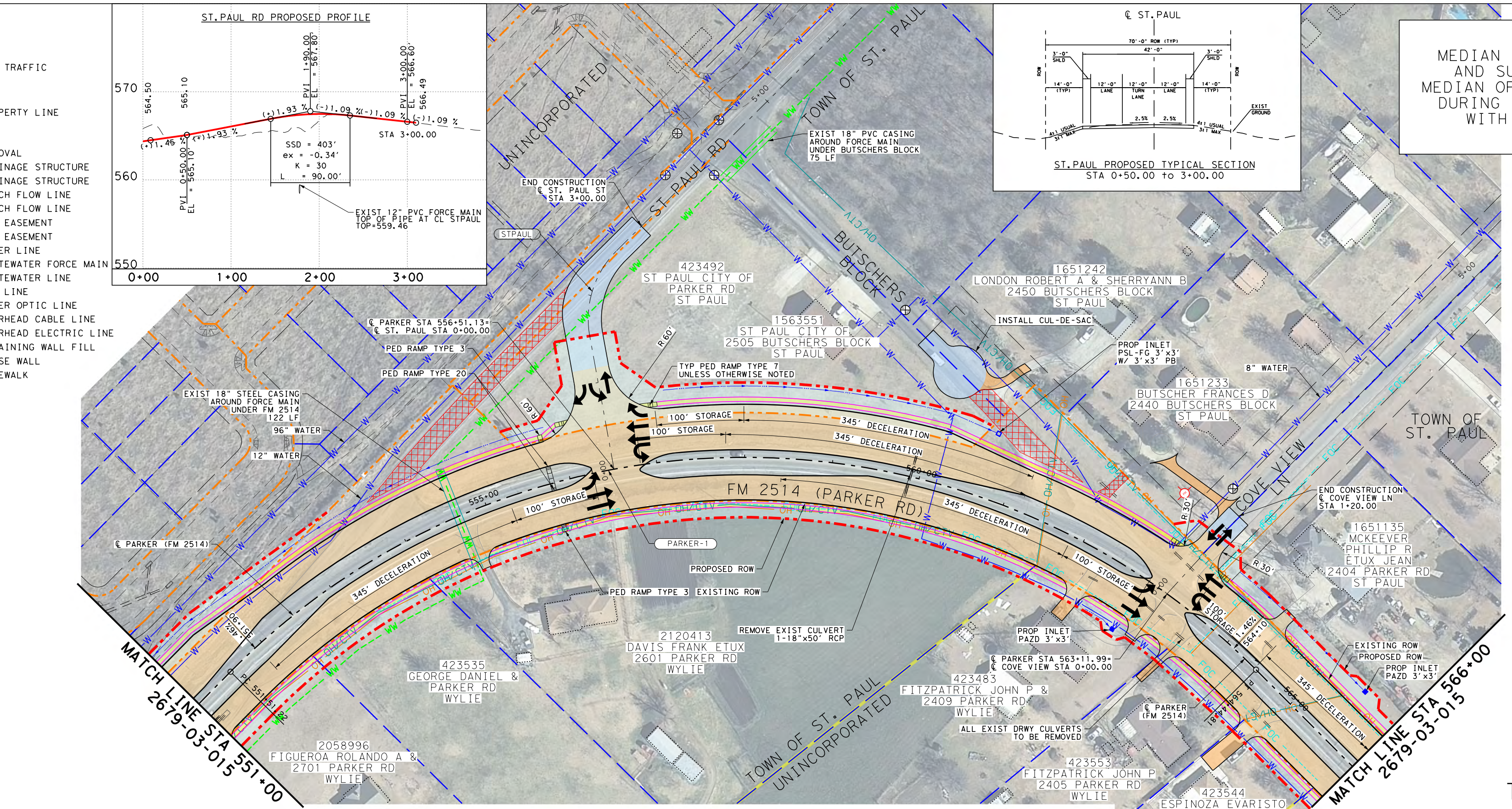
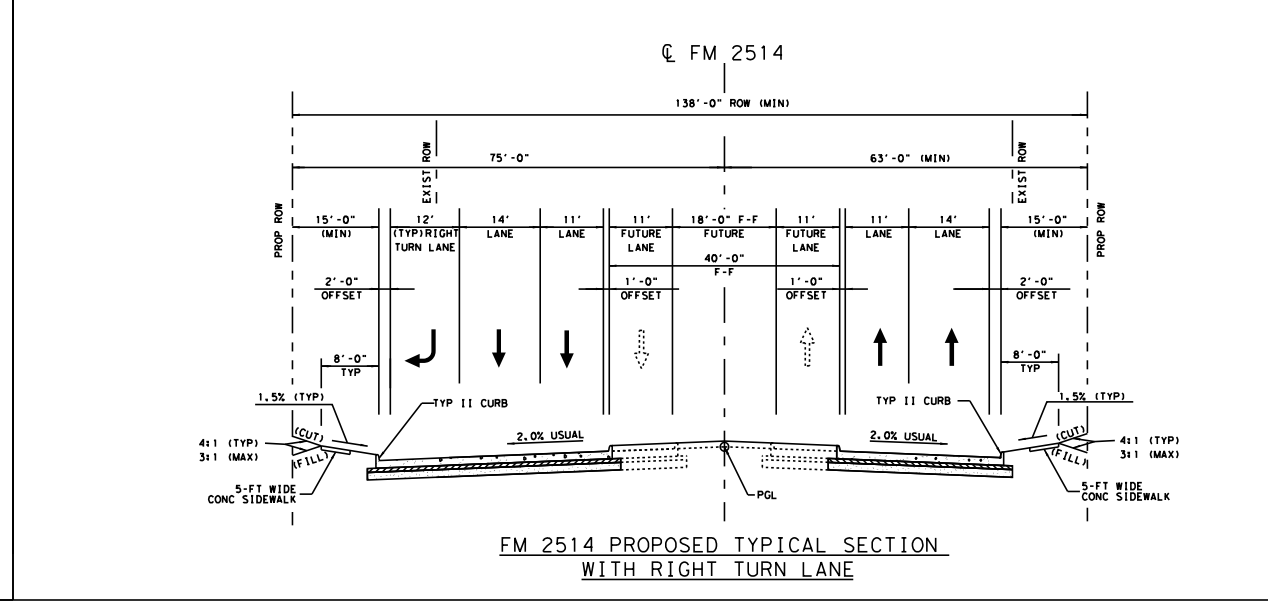
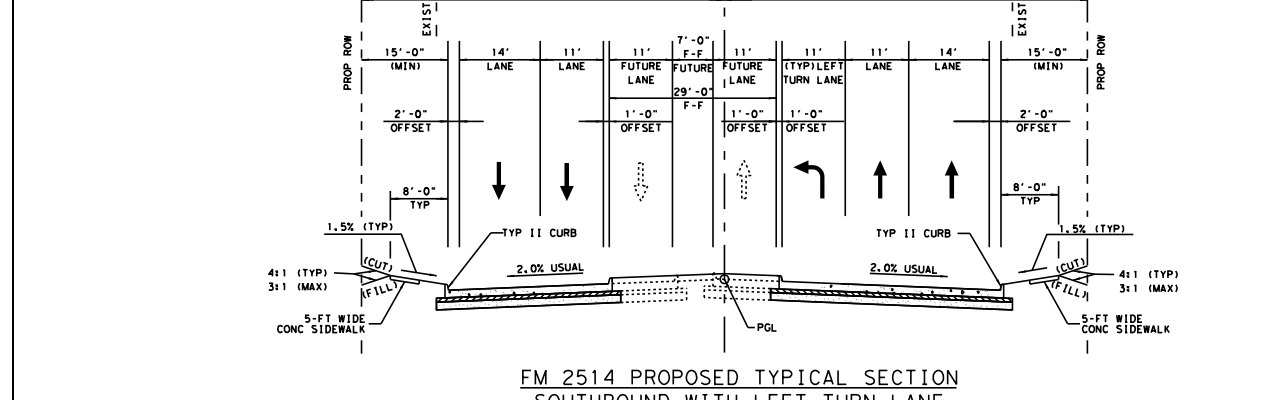
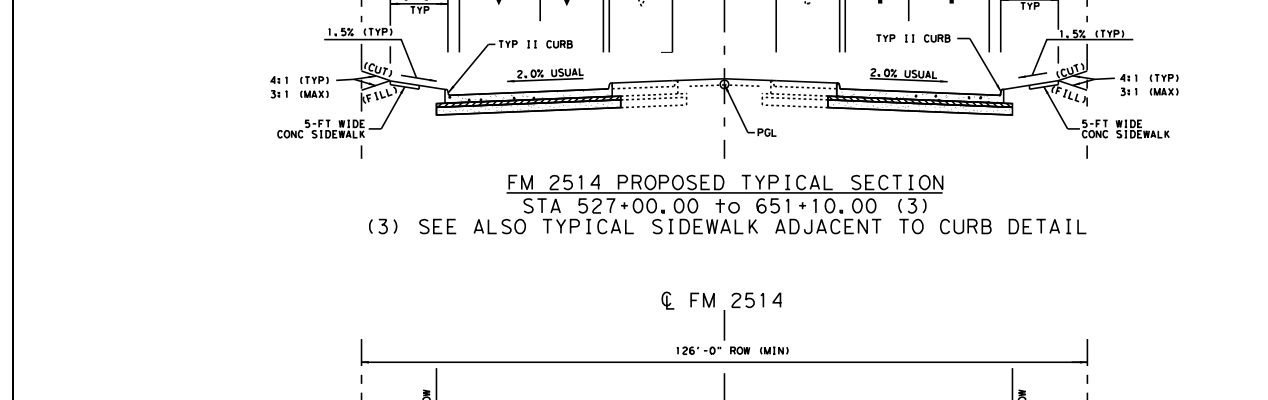
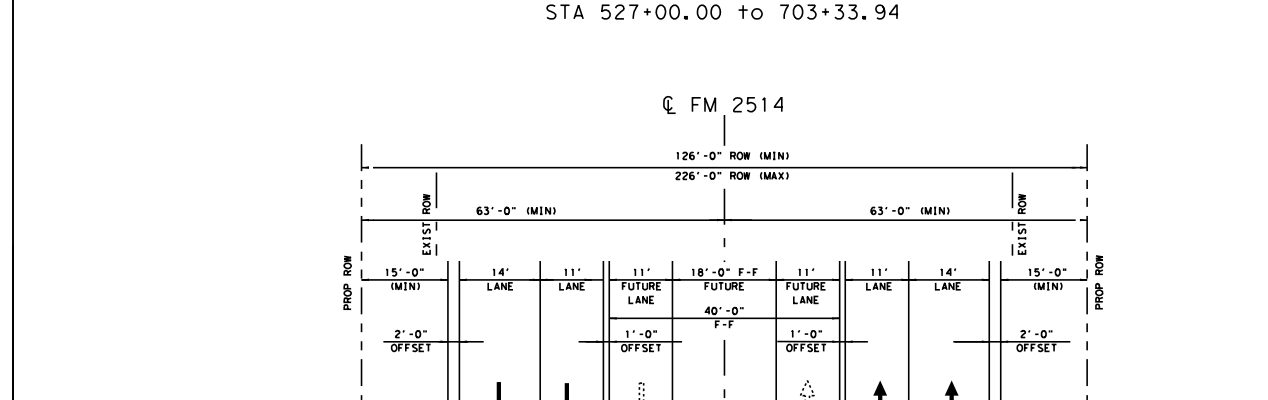
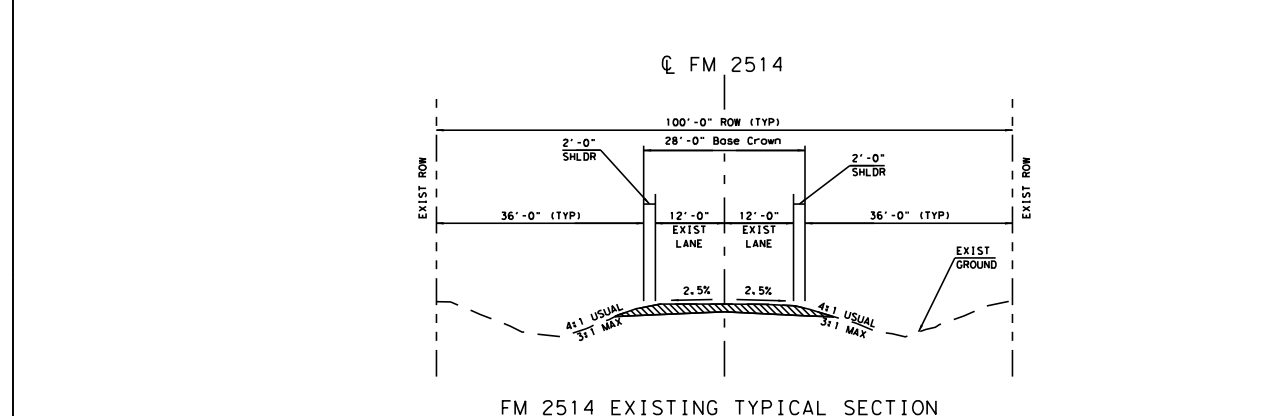

LOCATION MAP
 PRELIMINARY FOR REVIEW ONLY
 THESE DOCUMENTS ARE FOR REVIEW AND NOT INTENDED FOR BIDDING OR CONSTRUCTION PURPOSES. THEY WERE PREPARED BY OR UNDER THE SUPERVISION OF:

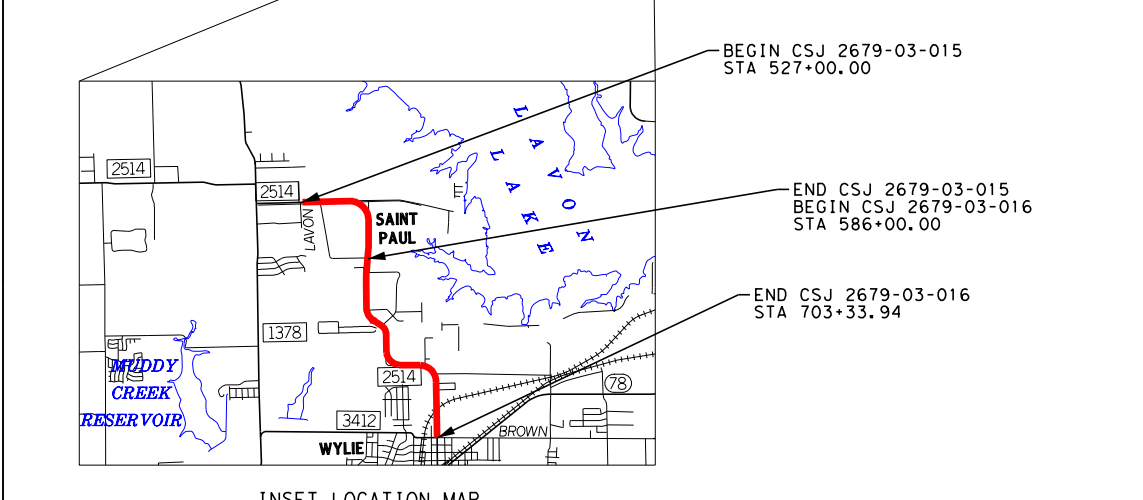
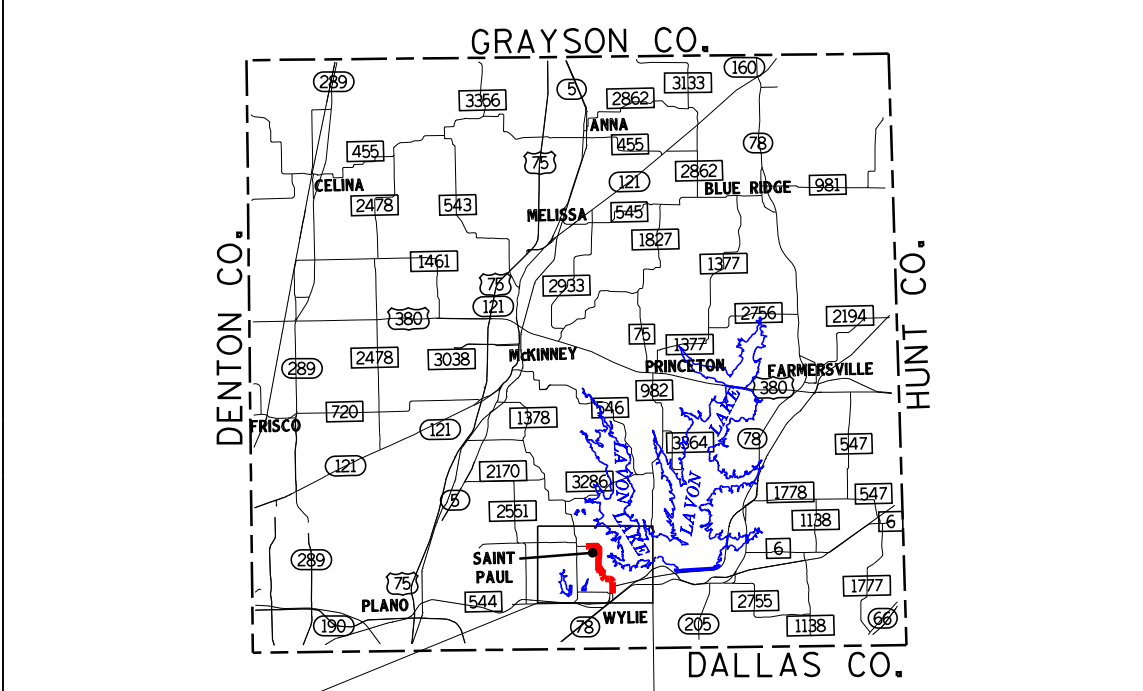

LOCATION MAP
 SCALE: 1"=10,000'

PRELIMINARY FOR REVIEW ONLY
 THESE DOCUMENTS ARE FOR REVIEW AND NOT INTENDED FOR BIDDING OR CONSTRUCTION PURPOSES. THEY WERE PREPARED BY OR UNDER THE SUPERVISION OF:
 ARON TANTER 05733
 NAME P.E. NO. DATE

LEGEND

- PARKING
- CURVE NUMBER
- DIRECTION OF TRAFFIC
- CENTERLINE
- EXISTING PROPERTY LINE
- CITY LIMITS
- PROPOSED ROW
- PAVEMENT REMOVAL
- PROPOSED DRAINAGE STRUCTURE
- EXISTING DRAINAGE STRUCTURE
- PROPOSED DITCH FLOW LINE
- EXISTING DITCH FLOW LINE
- DRAINAGE ROW EASEMENT
- CONSTRUCTION GASMAIN
- EXISTING WATER LINE
- EXISTING WASTEWATER FORCE MAIN
- EXISTING WASTEWATER LINE
- EXISTING GAS LINE
- EXISTING FIBER OPTIC LINE
- EXISTING OVERHEAD CABLE LINE
- EXISTING OVERHEAD ELECTRIC LINE
- PROPOSED RETAINING WALL FILL
- PROPOSED NOISE WALL
- PROPOSED SIDEWALK

- NOTES**
- EXISTING FEATURES WERE NOT FIELD SURVEYED. SCHEMATICS ARE BASED ON SURVEY INFORMATION DATED MARCH 2015 AND RECORD PLANS.
 - FINAL LOCATION OF MEDIAN OPENINGS WILL BE DETERMINED IN THE PS&E DEVELOPMENT PHASE IN COORDINATION WITH THE LOCAL GOVERNMENT.
 - SUPERELEVATION AXIS OF ROTATION IS ABOUT THE P.O.L.
 - DIMENSIONS ARE TO THE EDGE OF PAVEMENT OR NOMINAL FACE OF CURB, RAIL, BARRIER, OR WALL UNLESS NOTED OTHERWISE.
 - NO AREAS OF THE PROJECT ARE WITHIN 100 YEAR FLOODPLAIN LIMITS BASED UPON FEMA FLOOD INSURANCE RATE MAP #808030020.
 - OWNERSHIP INFORMATION SHOWN ON SCHEMATIC OBTAINED FROM COLLIN COUNTY APPRAISAL DISTRICT NOVEMBER 2016.
 - EXISTING CULVERT LOCATIONS, SIZES, AND ELEVATIONS OBTAINED FROM RECORD DOCUMENTS AND FIELD SURVEY.
 - ADA RAMP AND SIDEWALKS ARE DIAGRAMMATIC ONLY AND WILL BE DEVELOPED DURING PS&E. SIDEWALKS ARE SHOWN ON TYPICAL SECTIONS.
 - EXISTING DRIVEWAYS WILL REMAIN UNLESS IT IS DETERMINED IN COORDINATION WITH THE LOCAL GOVERNMENT THAT THE DRIVEWAY IS A SAFETY ISSUE AND/OR IS LOCATED WITHIN ACCESS DENIAL LIMITS SHOWN.
 - BUILDINGS ARE SHOWN AS POTENTIAL DISPLACEMENT IF THE PROPOSED ROW PHYSICALLY INTERSECTS THE EXISTING BUILDING STRUCTURE.
 - CURBS ARE TYPE 11 (8") UNLESS NOTED OTHERWISE.
 - CONVENTIONAL ROADWAY SIGNAGE (SMALL SIGNS) ARE NOT SHOWN AND WILL BE DEVELOPED DURING THE PS&E PHASE OF THE PROJECT.

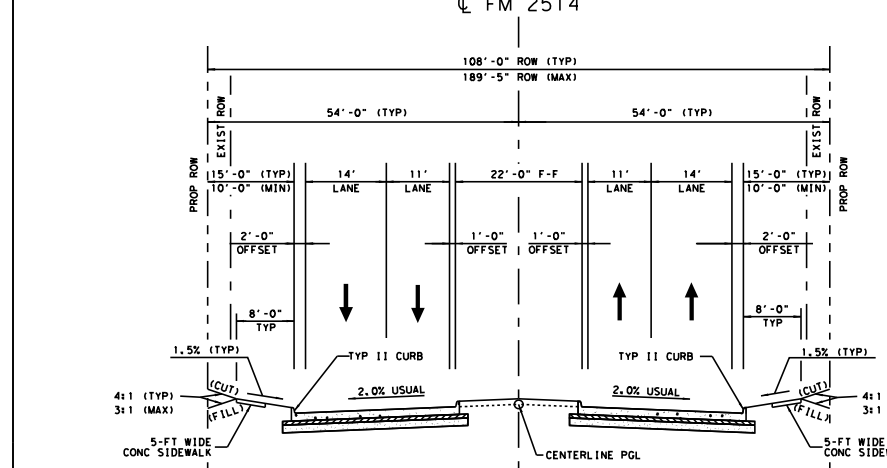
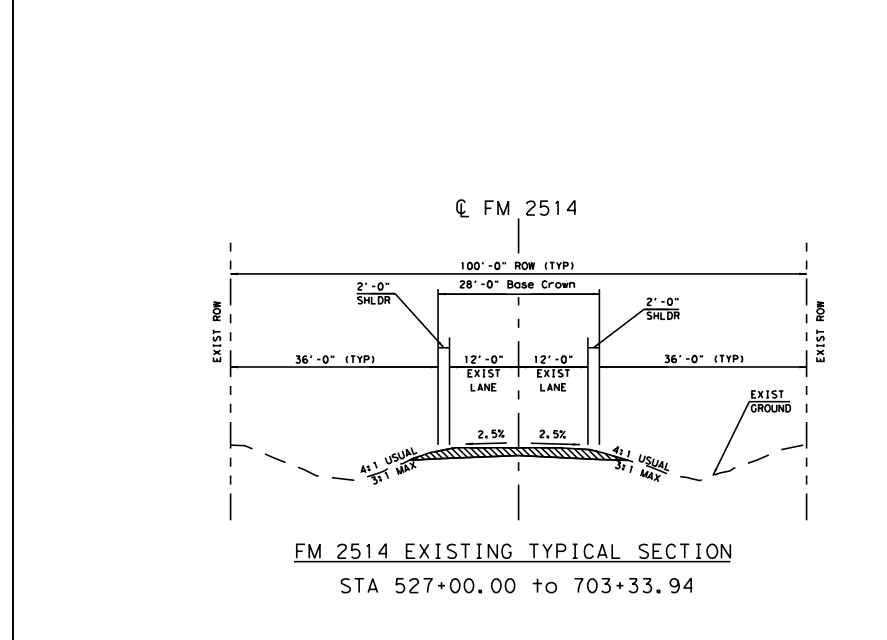

FM 2514 PROPOSED TYPICAL SECTION STA 656+10.00 TO 685+75.00 (1)
 (1) SEE ALSO TYPICAL RETAINING WALL DETAIL
 (2) SEE ALSO TYPICAL NOISE WALL DETAIL

