

# Conceptual Renderings of Noise Walls

## Between N. Pecan Parkway and Cleveland-Gibbs Road

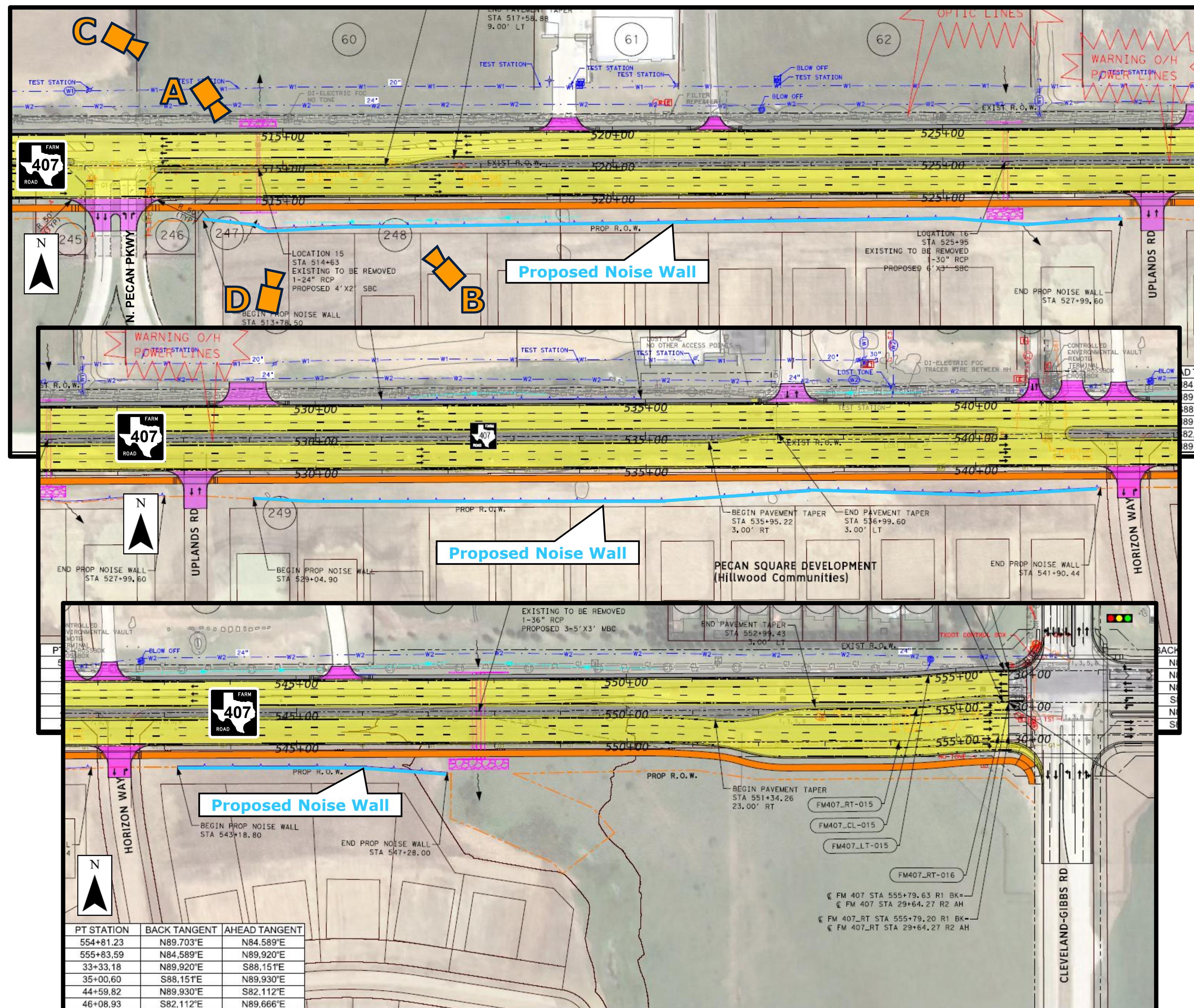

**Note:** Once a new roadway alignment is constructed, the existing FM roadway becomes a local road and will be maintained by the local government.



A) Ground View: Front of Noise Wall

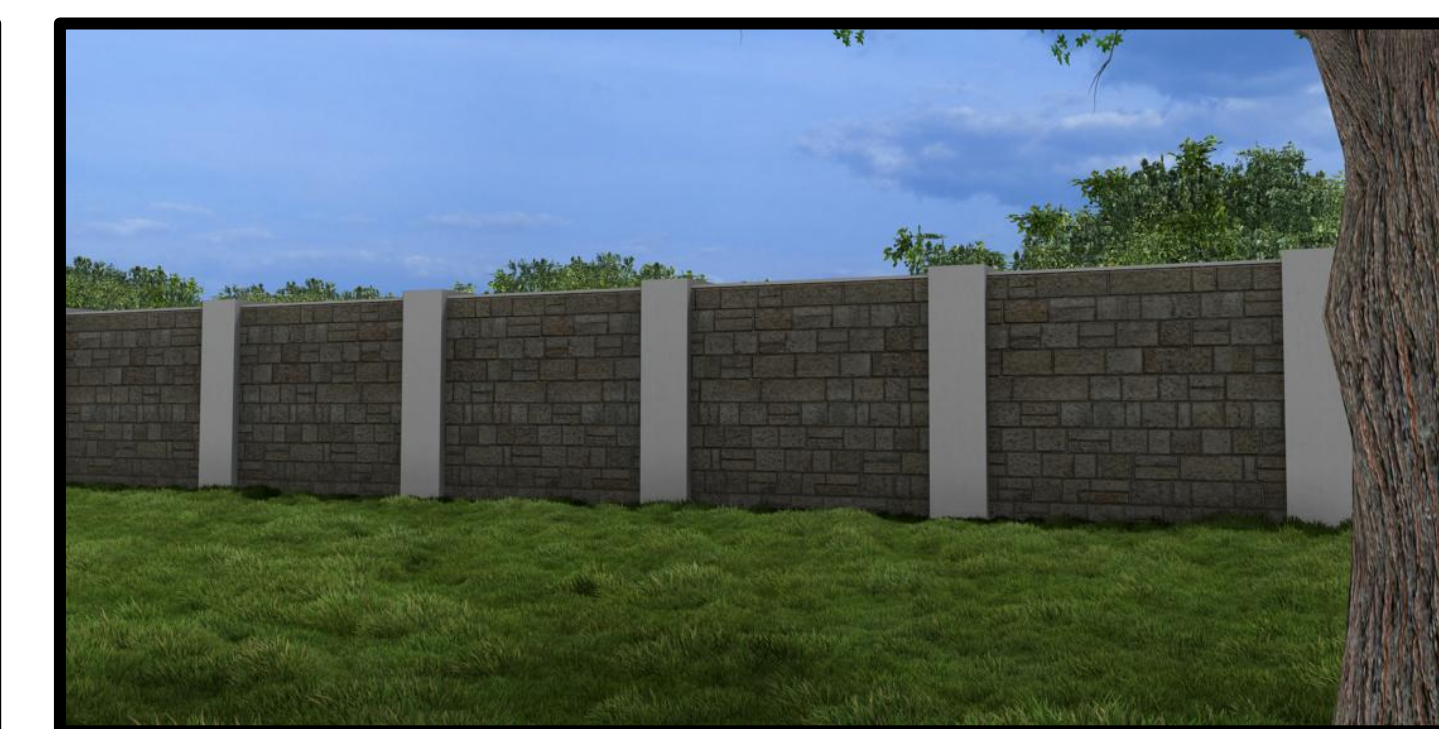

B) Ground View: Back of Noise Wall

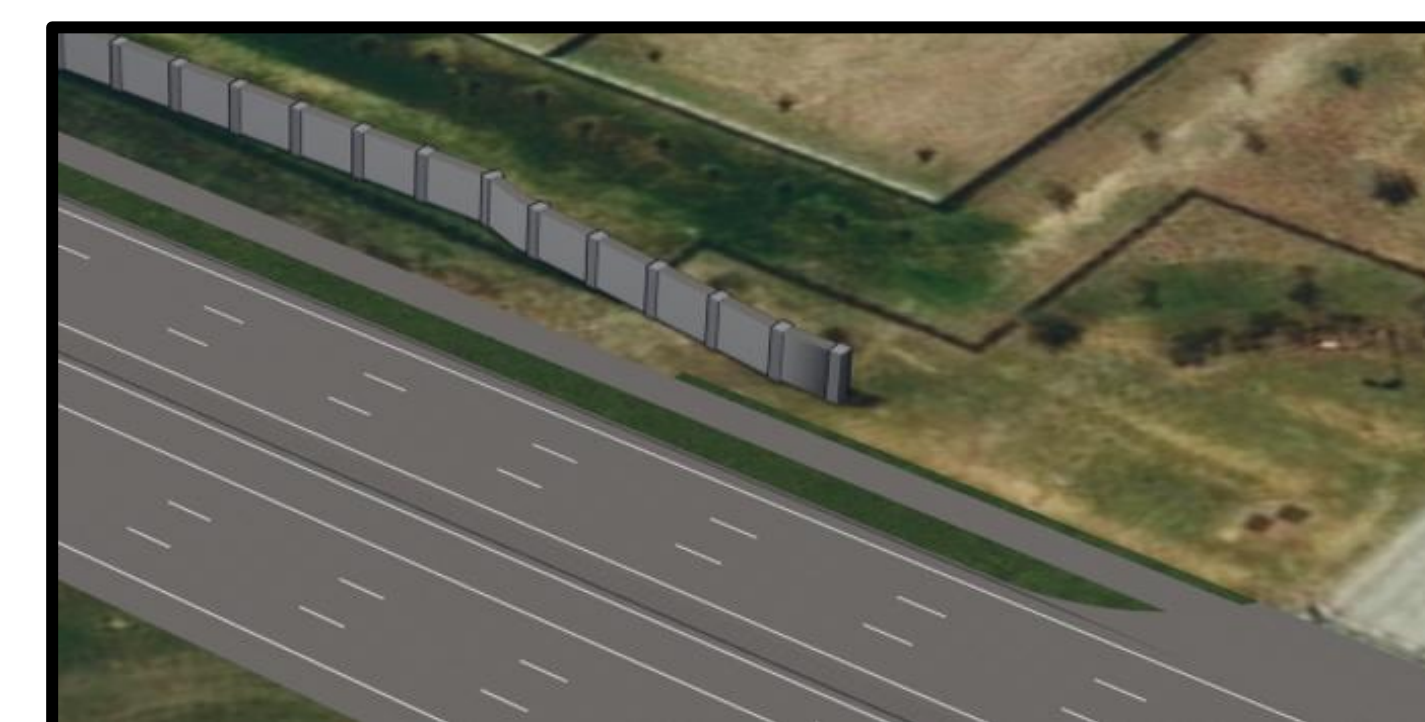

C) Birdseye View: Front of Noise Wall

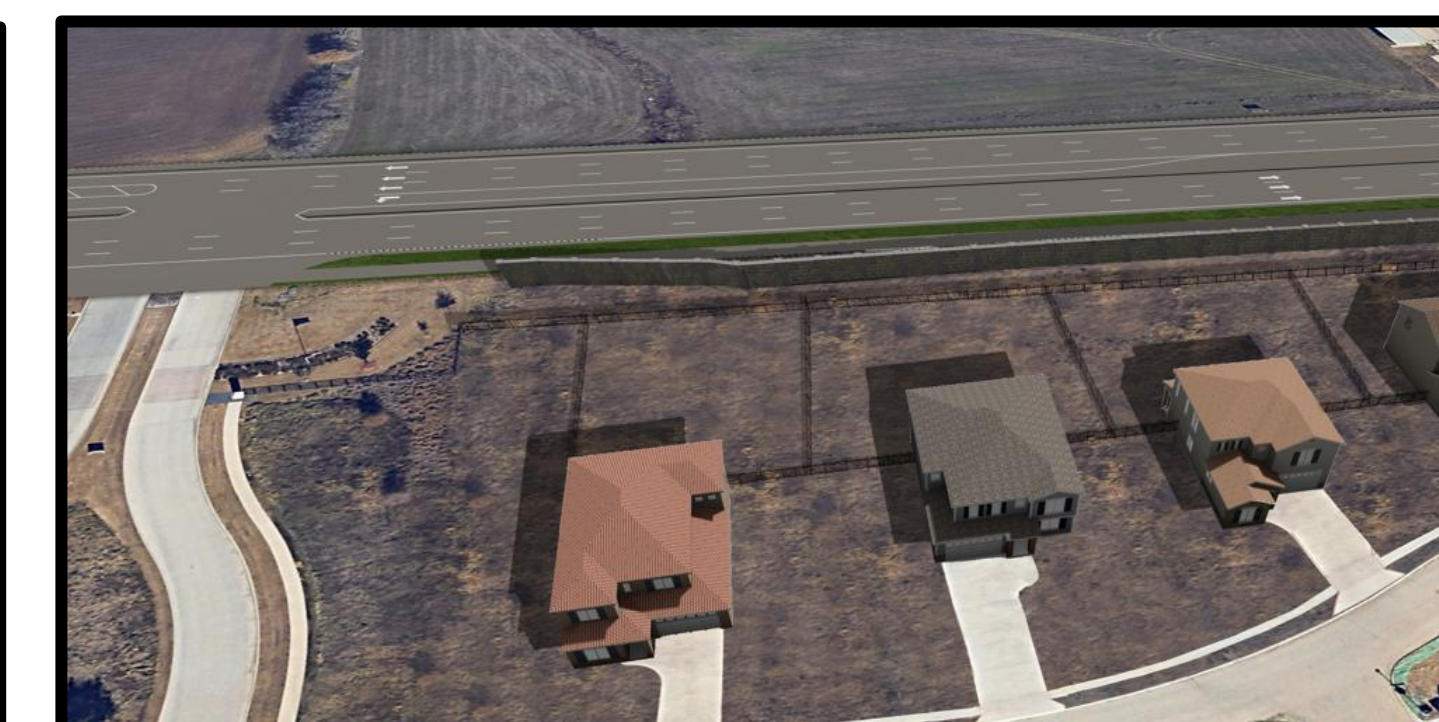

D) Birdseye View: Back of Noise Wall