

WILLIAM L. HALE, P.E. DISTRICT ENGINEER

DESIGN SCHEMATIC
SH 114

FROM: 1.236 MI E OF INTERNATIONAL PKY
TO: SH 183

NET LENGTH OF PROJECT = 11.63 MI
CSI: 0353-04-056 FROM 1.236 MI E OF INTERNATIONAL PKY TO SPUR 348
CSI: 0353-04-084 TURN AT SH 161
CSI: 0353-06-025 FROM SPUR 348 TO 0.087 MILES EAST OF ROCHELLE
CSI: 0353-06-050 FROM 0.087 MI E OF ROCHELLE TO 0.203 MI W OF TOM BRANIFF
CSI: 0353-06-054 FROM 0.203 MI W OF TOM BRANIFF TO SH 183
CSI: 0581-02-121 FROM TEXAS PLAZA TO LP 12/1H-35E SPLIT

Dallas County
HIGHWAY CLASSIFICATION
URBAN FREEWAY
MAY 2009
Design Speeds
MANAGED HOV LINES = 70 MPH
RAMP = 50 MPH
DIRECT CONNECTORS = 50 MPH
FRONTAGE ROADS = 45 MPH
CROSS STREETS = 45 MPH
MANAGED HOV LANES = 70 MPH (MAINLANES), 50 MPH (RAMPS)

Average Daily Traffic 2008 (2028)
SH 121 TO SH 161: 149,400 (224,200)
SH 161 TO SH 348: 194,000 (231,000)
SPUR 348 TO LOOP 12: 147,300 (221,000)
LOOP 12 TO SH 183: 116,700 (175,000)
HIGHWAY VOLUMES INCLUDE MAIN AND MANAGED HOV LINES ONLY
SOURCE: NORTH CENTRAL TEXAS COUNCIL OF GOVERNMENTS

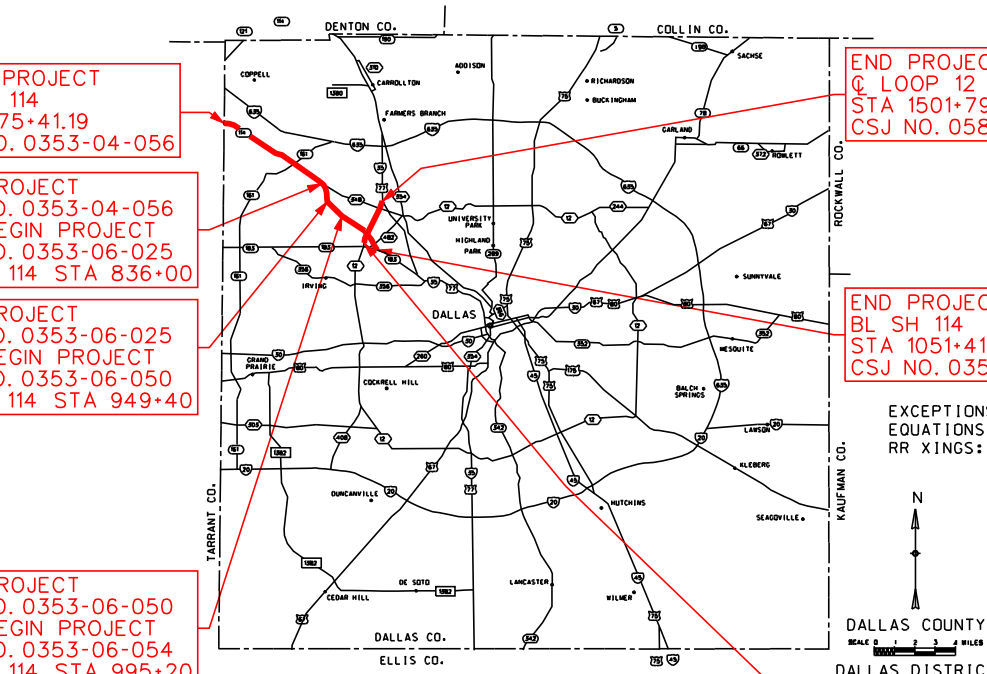

© 2009 BY TEXAS DEPARTMENT OF TRANSPORTATION. ALL RIGHTS RESERVED.
DART CITY OF IRVING

PREPARED BY BRIDGEFARMER & ASSOCIATES, INC. UNDER THE SUPERVISION OF
STERLING C. FORSYTHE, III SHAHRIAR AZAD WEIYH TEE
P.E. NO. 57339 DATE: 05/11/09 P.E. NO. 91682 DATE: 05/11/09 P.E. NO. 98478 DATE: 05/11/09

BRIDGEFARMER & ASSOCIATES, INC. CONSULTING ENGINEERS
12801 NORTH CENTRAL EXPRESSWAY, 4TH FLOOR
DALLAS, TEXAS 75243
TEL: (972) 231-8800 FAX: (972) 231-5900

Roll: 20 of 23
DATE APPROVED [] DATE SUBMITTED []
DESIGN SCHEMATIC NOT INTENDED FOR CONSTRUCTION, BIDDING, OR PERMIT PURPOSES.
DATE REVISD []

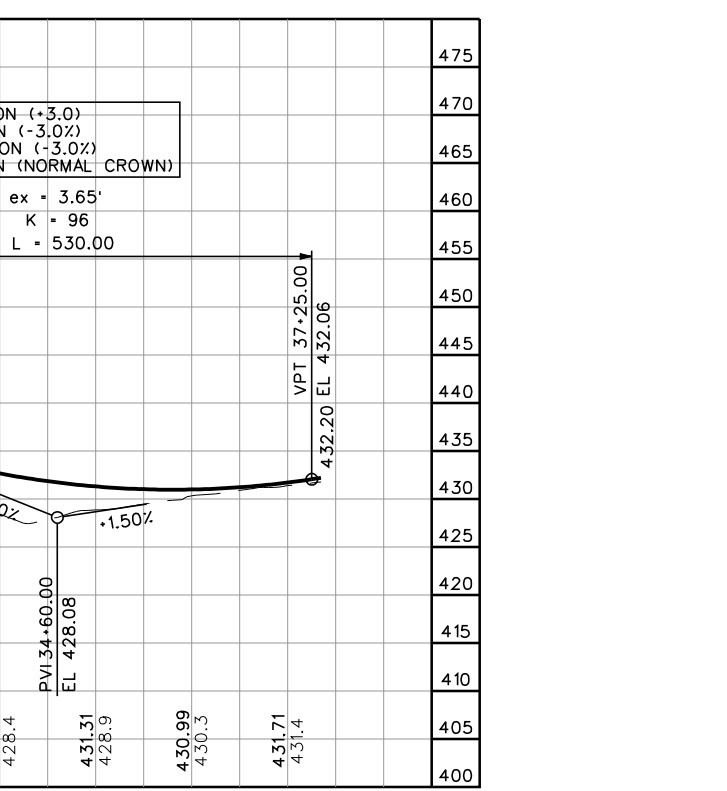
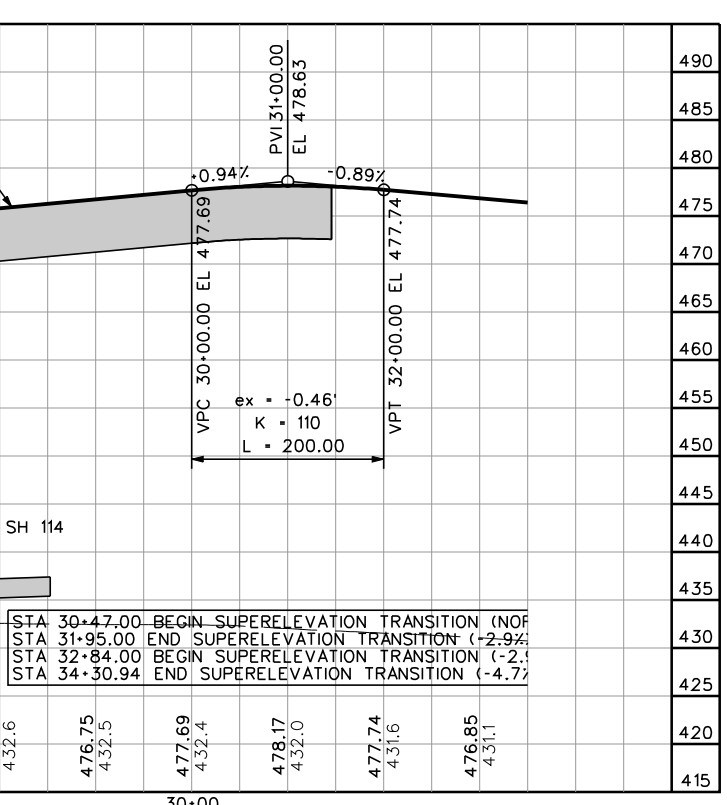
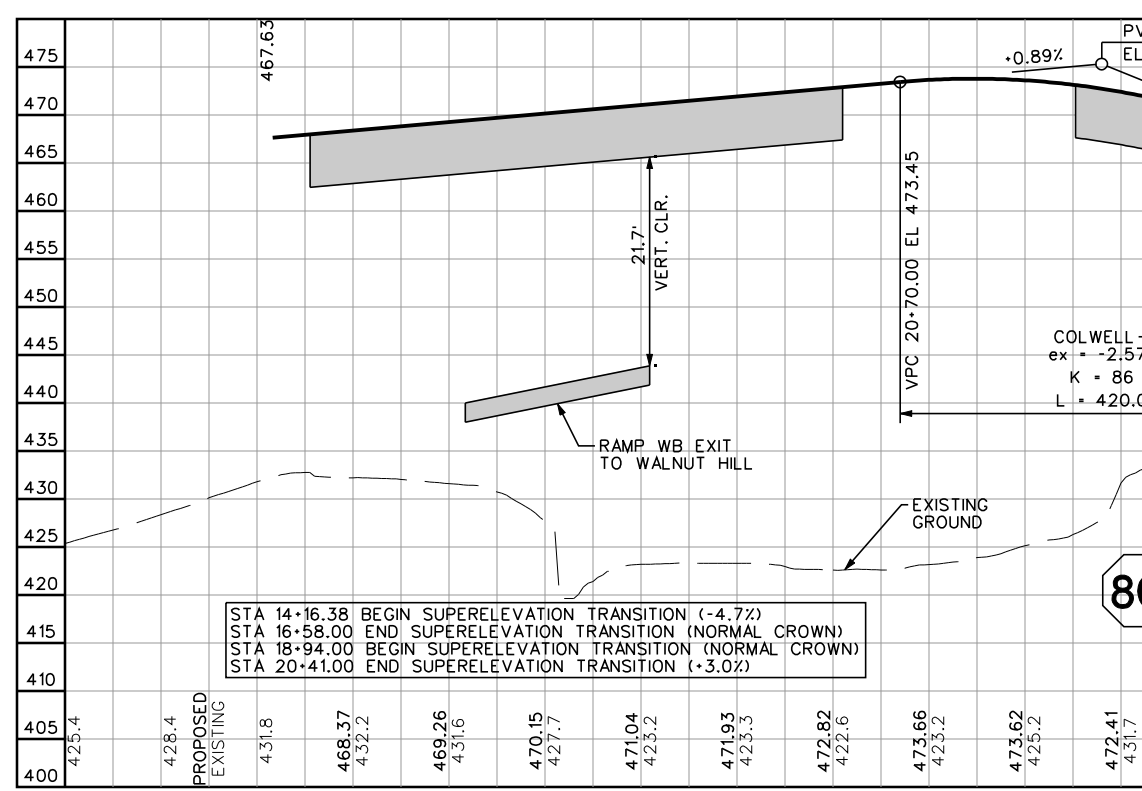
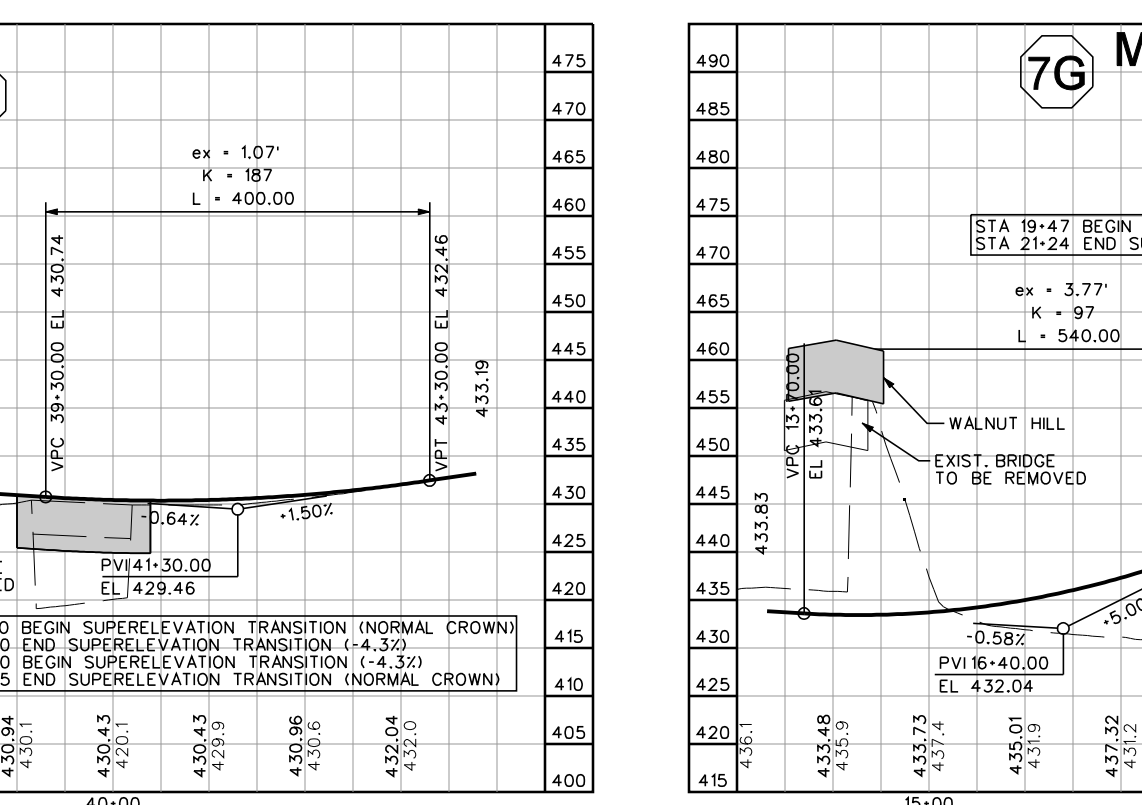
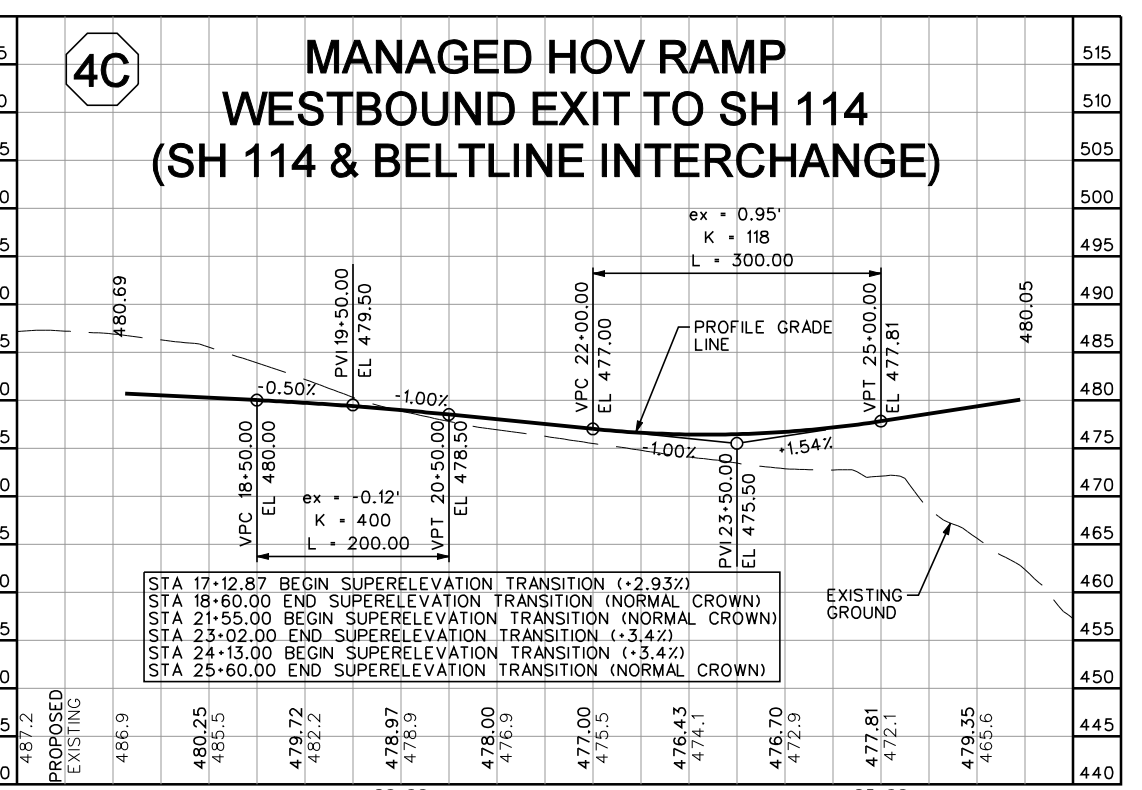
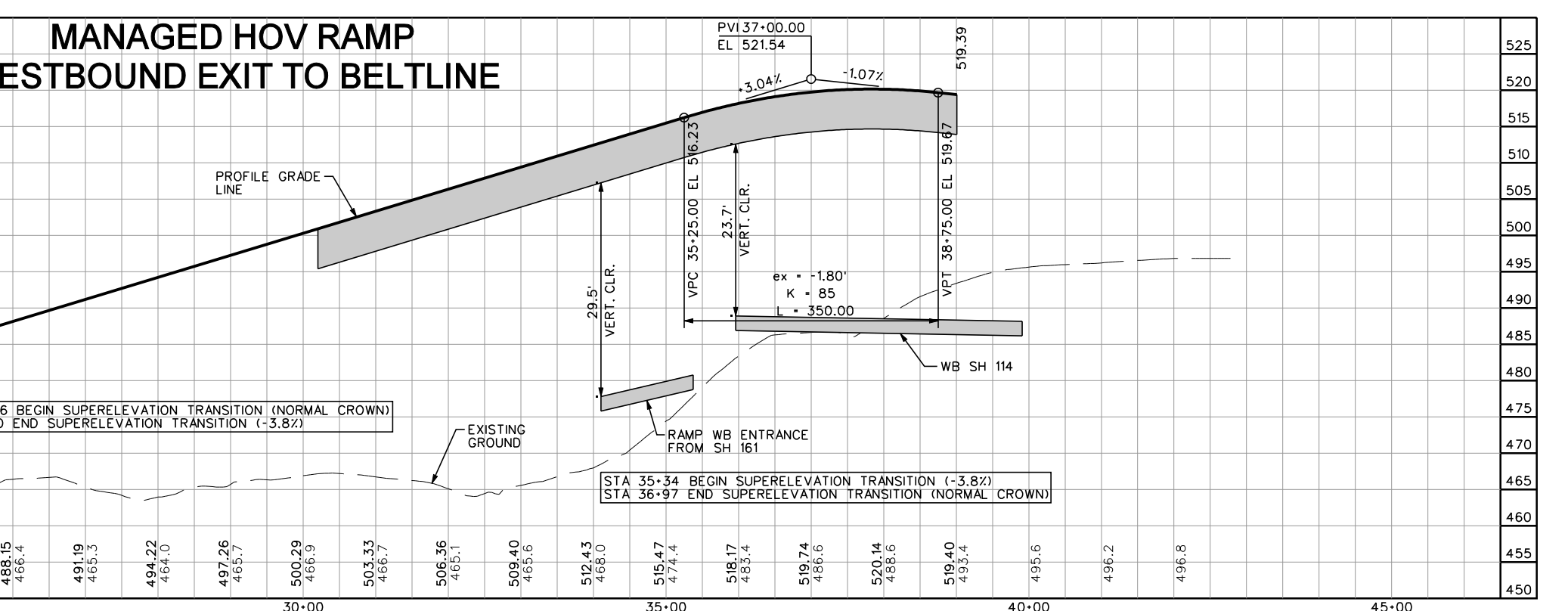
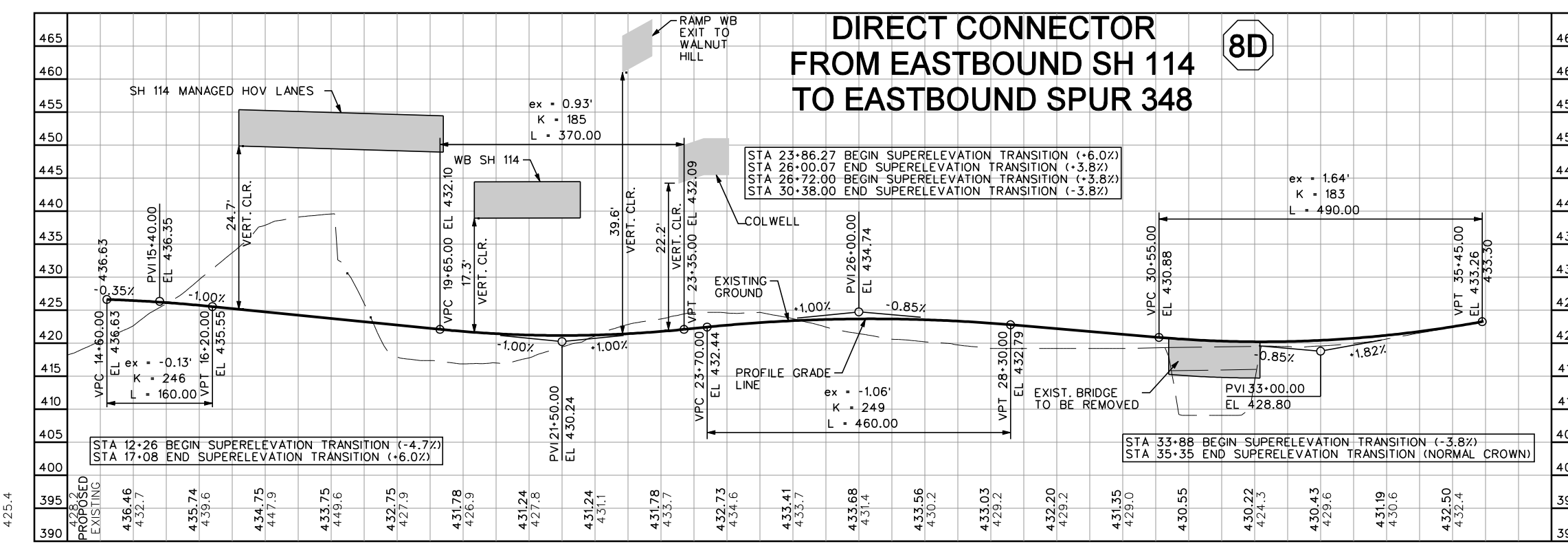
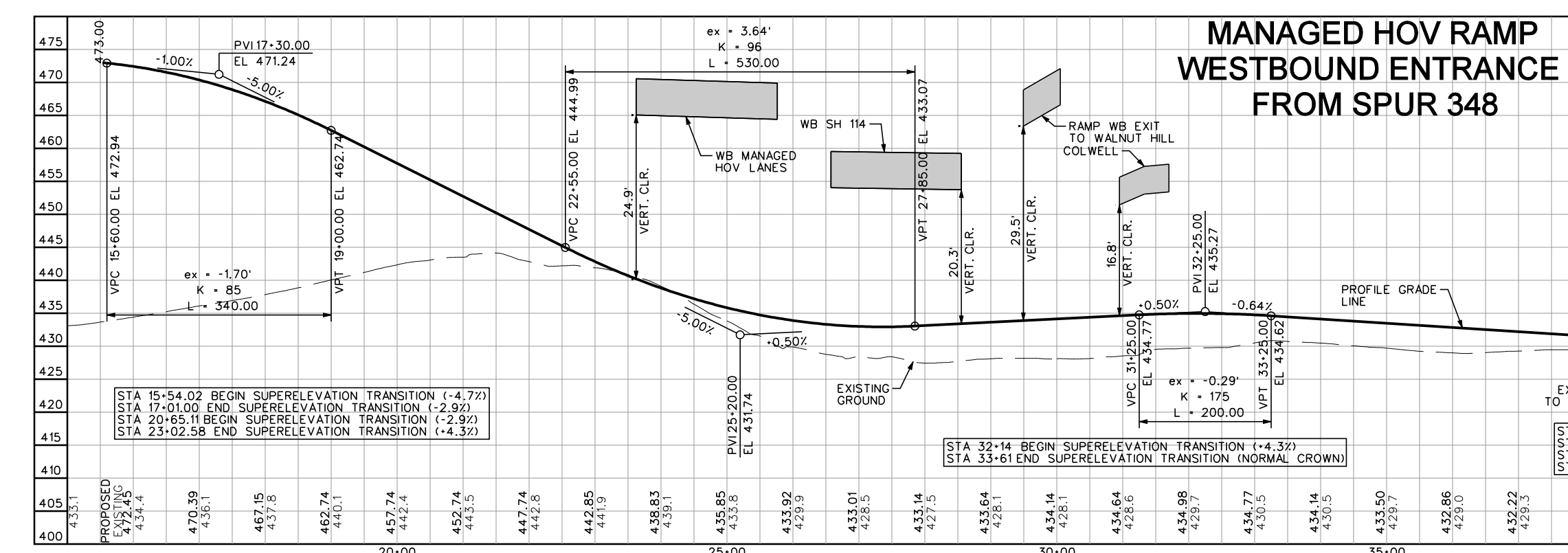
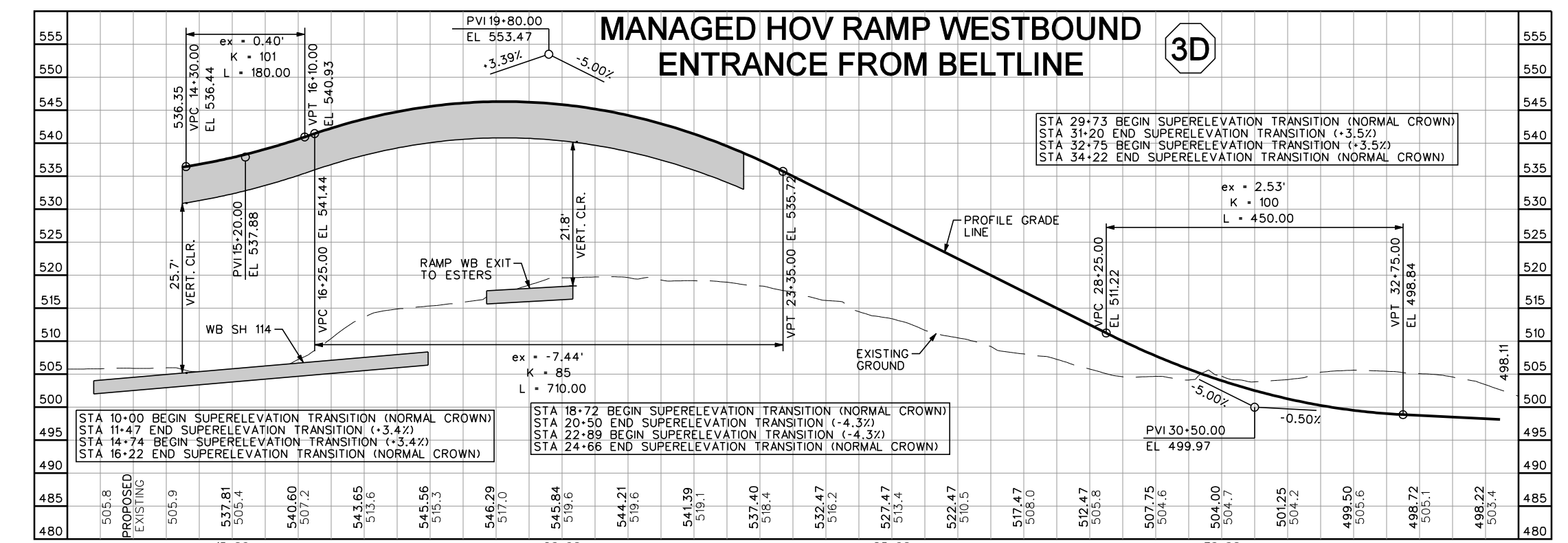
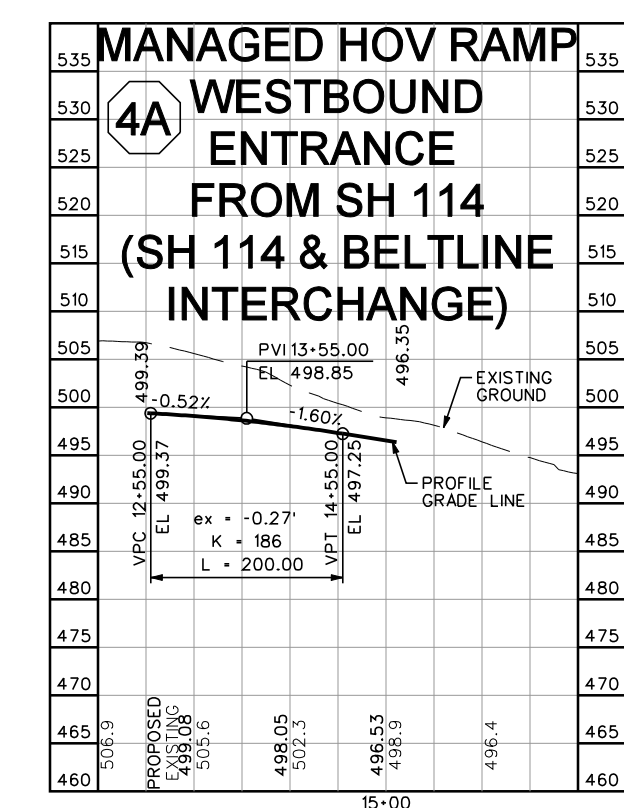

WILLIAM L. HALE, P.E. DISTRICT ENGINEER

DESIGN SCHEMATIC
SH 114

FROM: 1.236 MI E OF INTERNATIONAL PKY
TO: SH 183

NET LENGTH OF PROJECT = 11.63 MI
CSI: 0353-04-056 FROM 1.236 MI E OF INTERNATIONAL PKY TO SPUR 348
CSI: 0353-04-084 TURN AT SH 161
CSI: 0353-06-025 FROM SPUR 348 TO 0.087 MILES EAST OF ROCHELLE
CSI: 0353-06-050 FROM 0.087 MI E OF ROCHELLE TO 0.203 MI W OF TOM BRANIFF
CSI: 0353-06-054 FROM 0.203 MI W OF TOM BRANIFF TO SH 183
CSI: 0581-02-121 FROM TEXAS PLAZA TO LP 12/1H-35E SPLIT

Dallas County
HIGHWAY CLASSIFICATION
URBAN FREEWAY
MAY 2009
Design Speeds
MANAGED HOV LINES = 70 MPH
RAMP = 50 MPH
DIRECT CONNECTORS = 50 MPH
FRONTAGE ROADS = 45 MPH
CROSS STREETS = 45 MPH
MANAGED HOV LANES = 70 MPH (MAINLANES), 50 MPH (RAMPS)

Average Daily Traffic 2008 (2028)
SH 121 TO SH 161: 149,400 (224,200)
SH 161 TO SH 348: 194,000 (231,000)
SPUR 348 TO LOOP 12: 147,300 (221,000)
LOOP 12 TO SH 183: 116,700 (175,000)
HIGHWAY VOLUMES INCLUDE MAIN AND MANAGED HOV LINES ONLY
SOURCE: NORTH CENTRAL TEXAS COUNCIL OF GOVERNMENTS

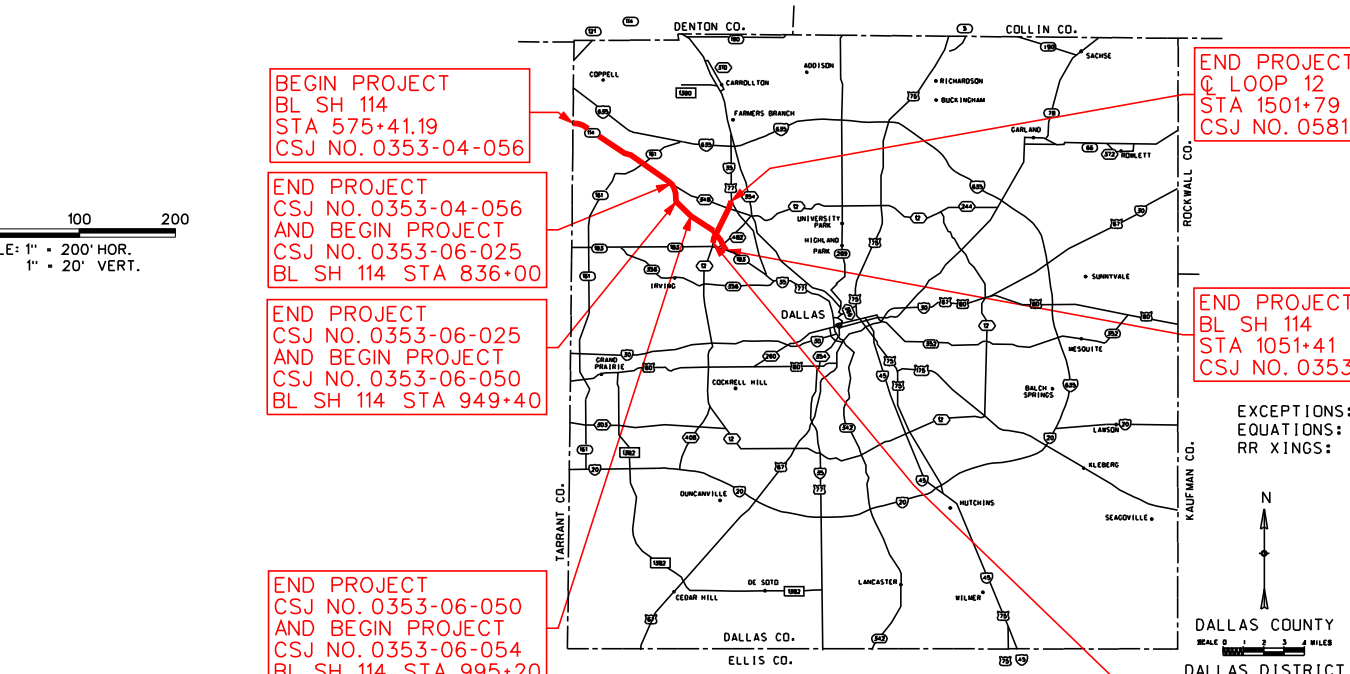

© 2009 BY TEXAS DEPARTMENT OF TRANSPORTATION. ALL RIGHTS RESERVED.
DART CITY OF IRVING

PREPARED BY BRIDGEFARMER & ASSOCIATES, INC. UNDER THE SUPERVISION OF
STERLING C. FORSYTHE, III SHAHRIAR AZAD WEIYH TEE
P.E. NO. 57339 DATE: 05/11/09 P.E. NO. 91682 DATE: 05/11/09 P.E. NO. 98478 DATE: 05/11/09

BRIDGEFARMER & ASSOCIATES, INC. CONSULTING ENGINEERS
12801 NORTH CENTRAL EXPRESSWAY, 4TH FLOOR
DALLAS, TEXAS 75243
TEL: (972) 231-8800 FAX: (972) 231-5900

Roll: 20 of 23
DATE APPROVED [] DATE SUBMITTED []
DESIGN SCHEMATIC NOT INTENDED FOR CONSTRUCTION, BIDDING, OR PERMIT PURPOSES.
DATE REVISD []