

- CSJ: 0353-04-056 FROM 1.236 MI E OF INTERNATIONAL PKY TO SPUR 348
CSJ: 0353-04-084 TURN AT SH 114
CSJ: 0353-06-025 FROM SPUR 348 TO 0.087 MILES EAST OF ROCHELLE
CSJ: 0353-06-050 FROM 0.087 MI E OF ROCHELLE TO 0.203 MI W OF TOM BRANIFF
CSJ: 0353-06-054: FROM 0.203 MI W OF TOM BRANIFF TO SH 183
CSJ: 0581-02-121 FROM TEXAS PLAZA TO LP 12/1H-35E SPLIT

HIGHWAY CLASSIFICATION

URBAN FREEWAY

MAY 2009

Design Speeds

- MAIN LANES - 70 MPH
RAMPS - 50 MPH
DIRECT CONNECTORS - 50 MPH
FRONTAGE ROADS - 45 MPH
CROSS STREETS - 45 MPH
MANAGED HOV LANES - 70 MPH (MAIN LANES), 50 MPH (RAMPS)

Average Daily Traffic 2008 (2028)

- SH 121 TO SH 161: 149,400 (224,200)
SH 161 TO SH 348: 194,000 (231,000)
SPUR 348 TO LOOP 12: 147,300 (221,000)
LOOP 12 TO SH 183: 116,700 (175,000)
HIGHWAY VOLUMES INCLUDE MAIN AND MANAGED HOV LANES ONLY

SOURCE: NORTH CENTRAL TEXAS COUNCIL OF GOVERNMENTS

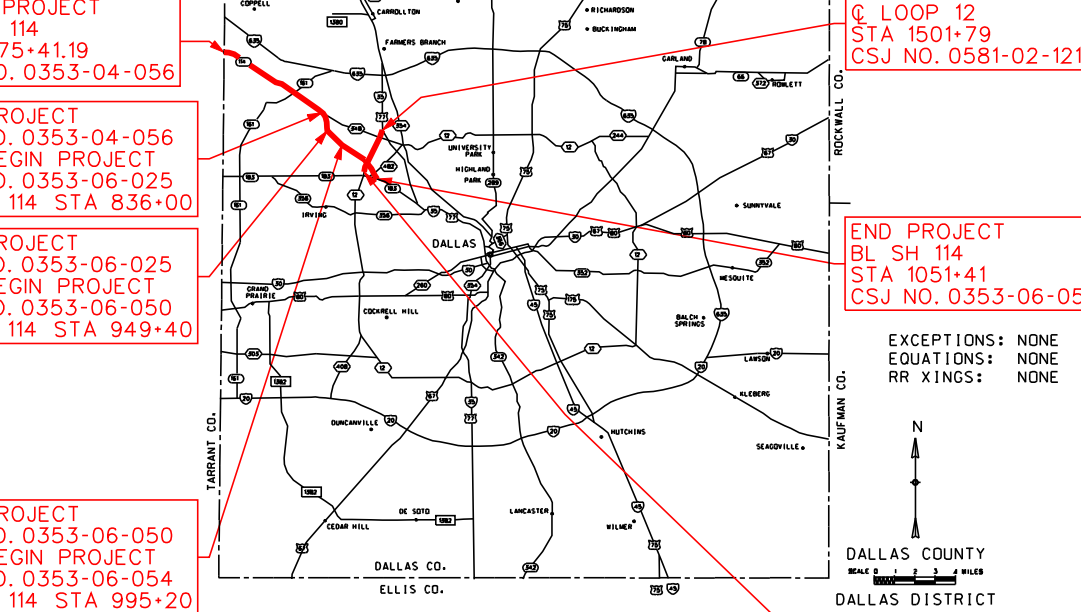

© 2009 BY TEXAS DEPARTMENT OF TRANSPORTATION: ALL RIGHTS RESERVED



PREPARED BY BRIDGEFARMER & ASSOCIATES, INC. UNDER THE SUPERVISION OF

STERLING C. FORSYTHE, III SHAHRIAR AZAD WEIYH TEE

P.E. NO. 57339 DATE: 05/11/09 P.E. NO. 91682 DATE: 05/11/09 P.E. NO. 98478 DATE: 05/11/09

BRIDGEFARMER & ASSOCIATES, INC. CONSULTING ENGINEERS TBPE REGISTRATION NO. 284 12801 NORTH CENTRAL EXPRESSWAY, 4TH FLOOR DALLAS, TEXAS 75243 TEL: (972) 231-8800 FAX: (972) 231-5900

Roll: 23 of 23
DATE APPROVED
DESIGN SCHEMATIC NOT INTENDED FOR CONSTRUCTION, BIDDING, OR PERMIT PURPOSES.
DATE SUBMITTED
DATE REVISED

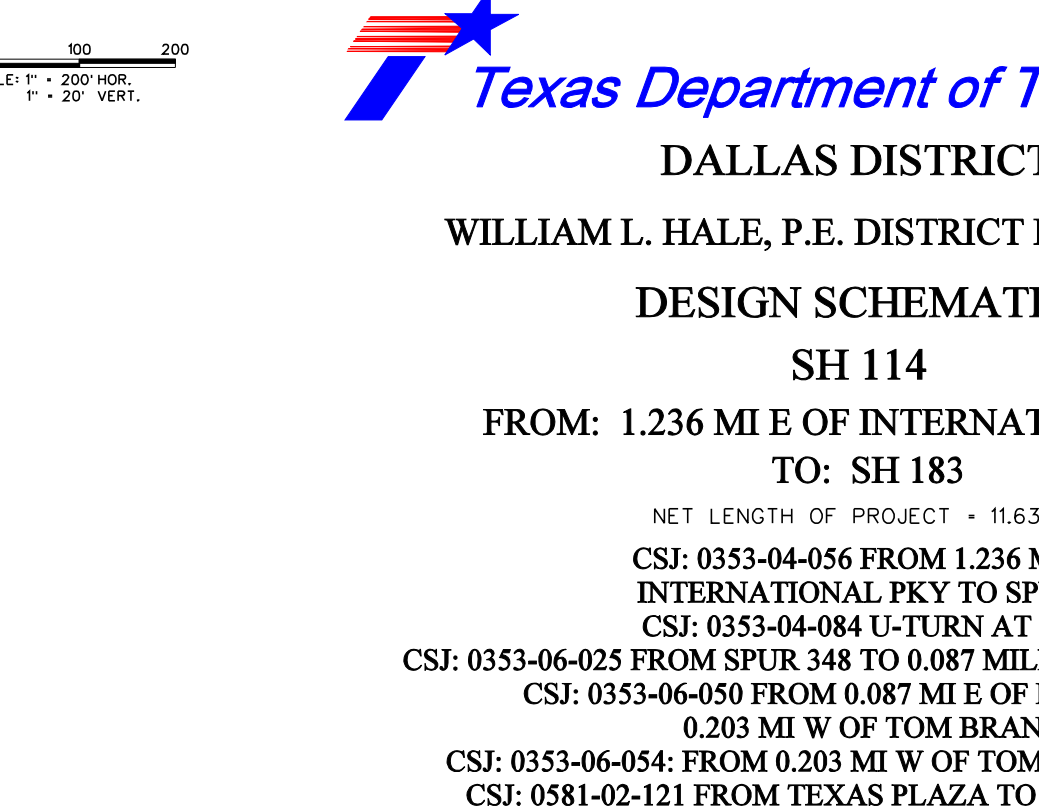
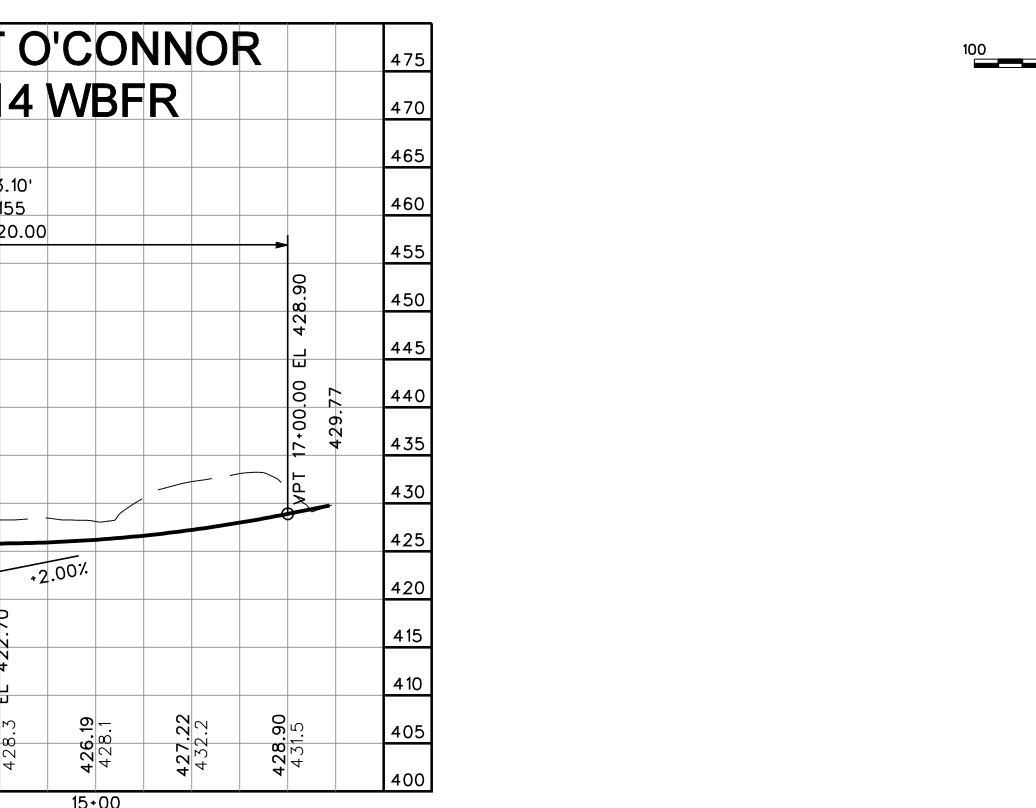
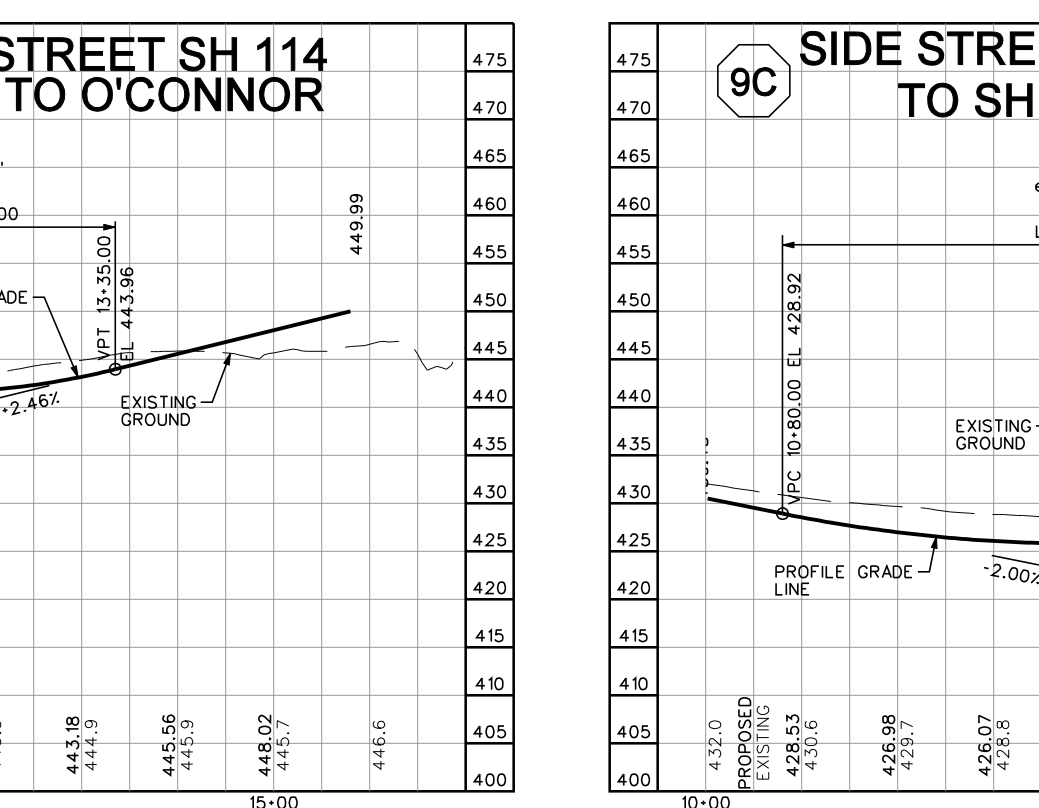
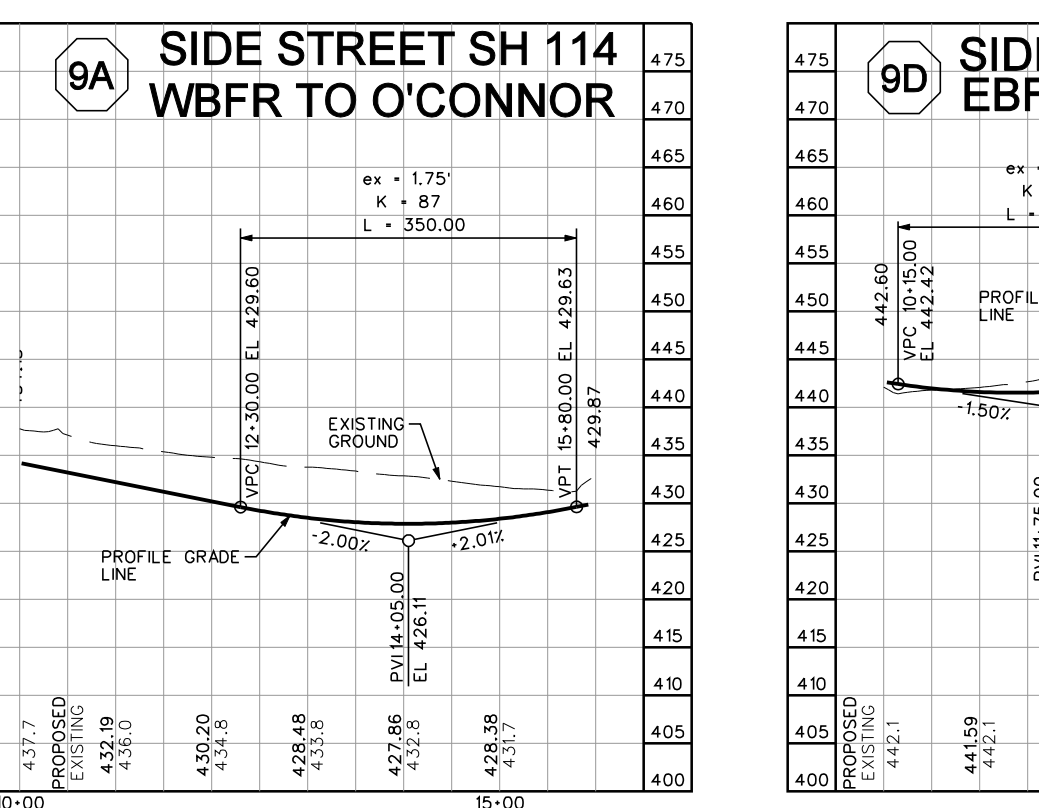
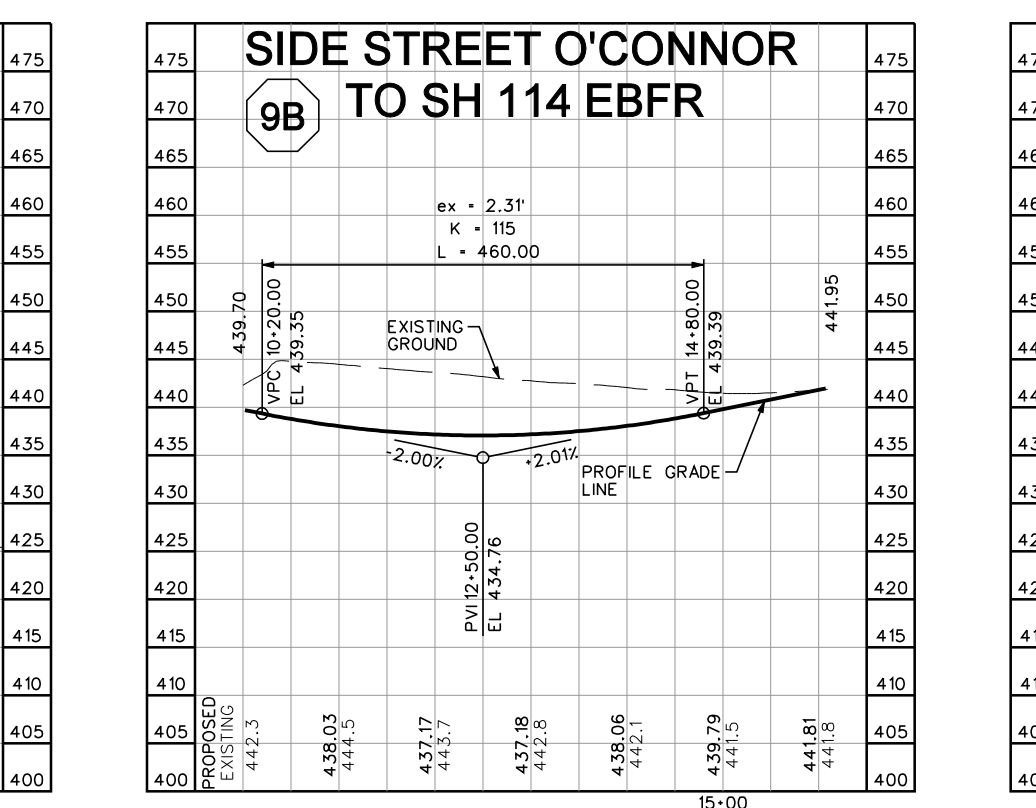
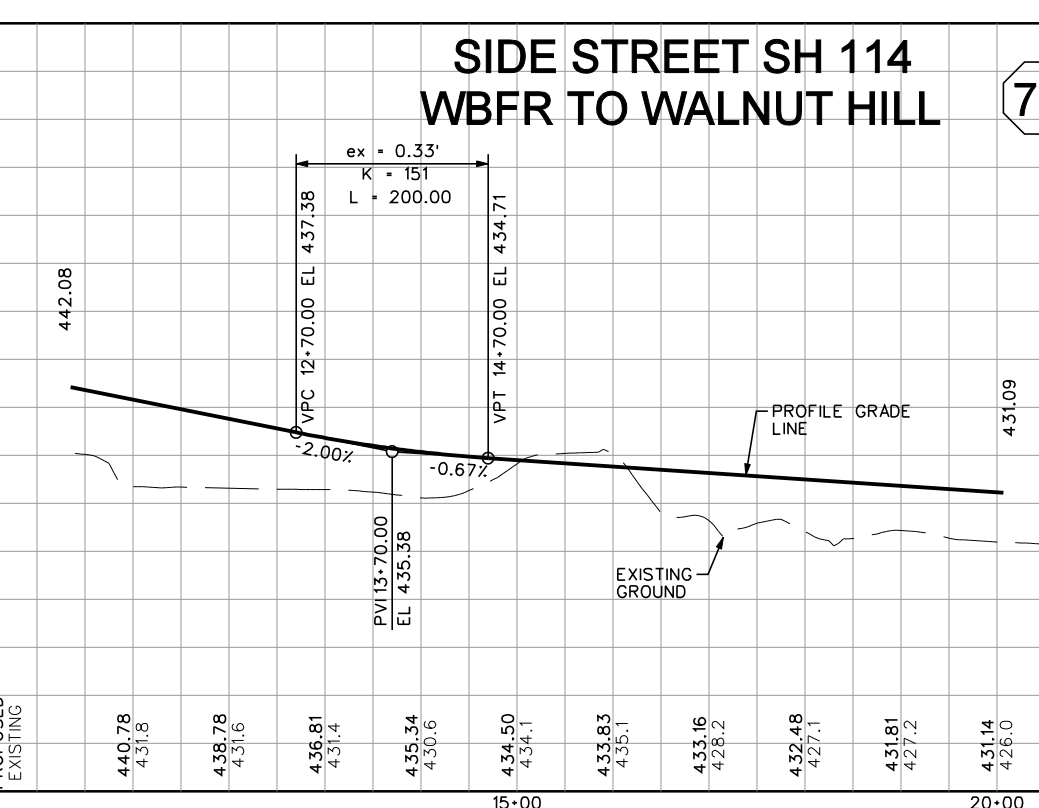
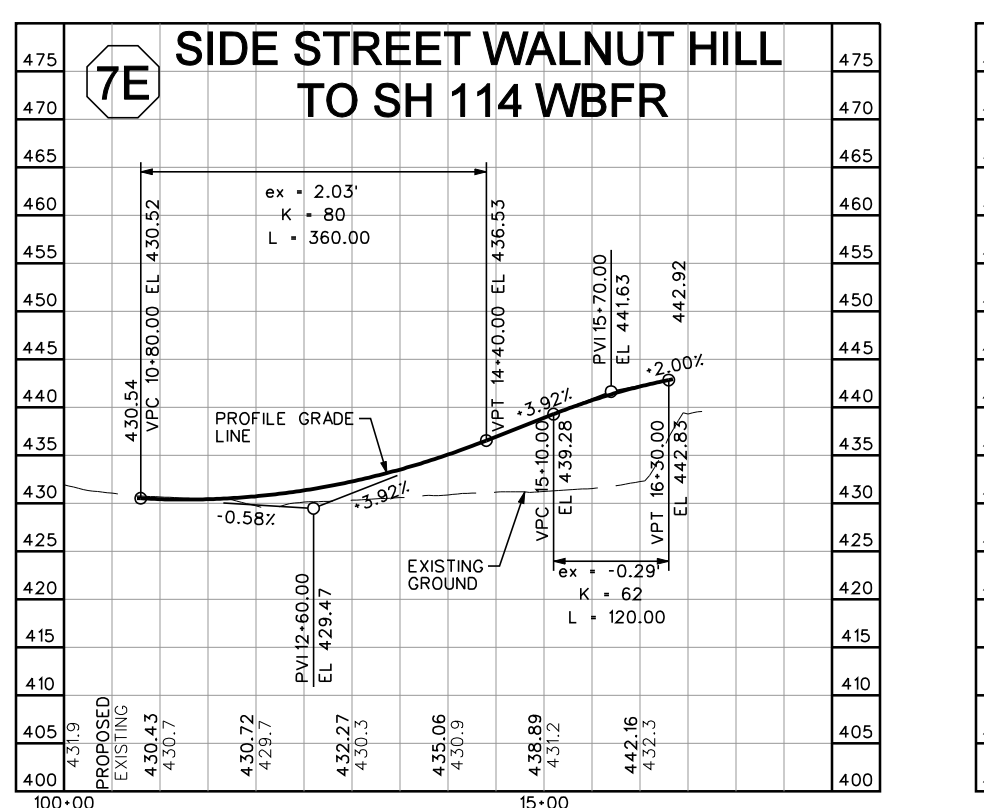
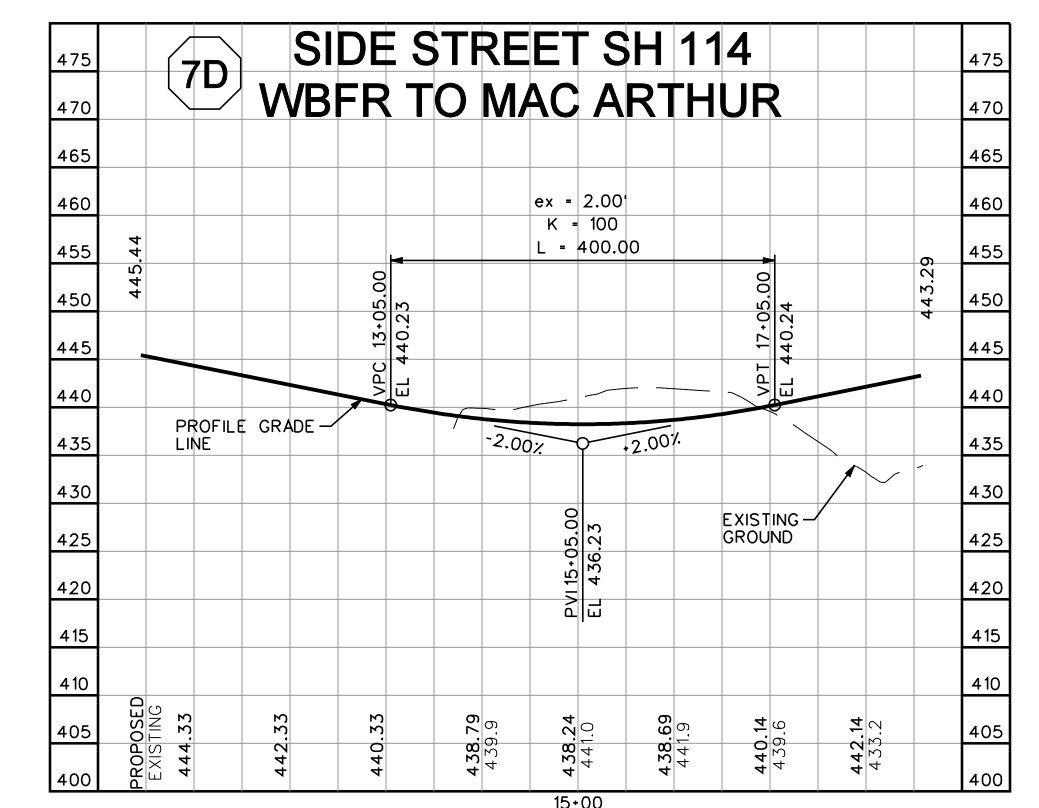

- CSJ: 0353-04-056 FROM 1.236 MI E OF INTERNATIONAL PKY TO SPUR 348
CSJ: 0353-04-084 TURN AT SH 114
CSJ: 0353-06-025 FROM SPUR 348 TO 0.087 MILES EAST OF ROCHELLE
CSJ: 0353-06-050 FROM 0.087 MI E OF ROCHELLE TO 0.203 MI W OF TOM BRANIFF
CSJ: 0353-06-054: FROM 0.203 MI W OF TOM BRANIFF TO SH 183
CSJ: 0581-02-121 FROM TEXAS PLAZA TO LP 12/1H-35E SPLIT

HIGHWAY CLASSIFICATION

URBAN FREEWAY

MAY 2009

Design Speeds

- MAIN LANES - 70 MPH
RAMPS - 50 MPH
DIRECT CONNECTORS - 50 MPH
FRONTAGE ROADS - 45 MPH
CROSS STREETS - 45 MPH
MANAGED HOV LANES - 70 MPH (MAIN LANES), 50 MPH (RAMPS)

Average Daily Traffic 2008 (2028)

- SH 121 TO SH 161: 149,400 (224,200)
SH 161 TO SH 348: 194,000 (231,000)
SPUR 348 TO LOOP 12: 147,300 (221,000)
LOOP 12 TO SH 183: 116,700 (175,000)
HIGHWAY VOLUMES INCLUDE MAIN AND MANAGED HOV LANES ONLY

SOURCE: NORTH CENTRAL TEXAS COUNCIL OF GOVERNMENTS

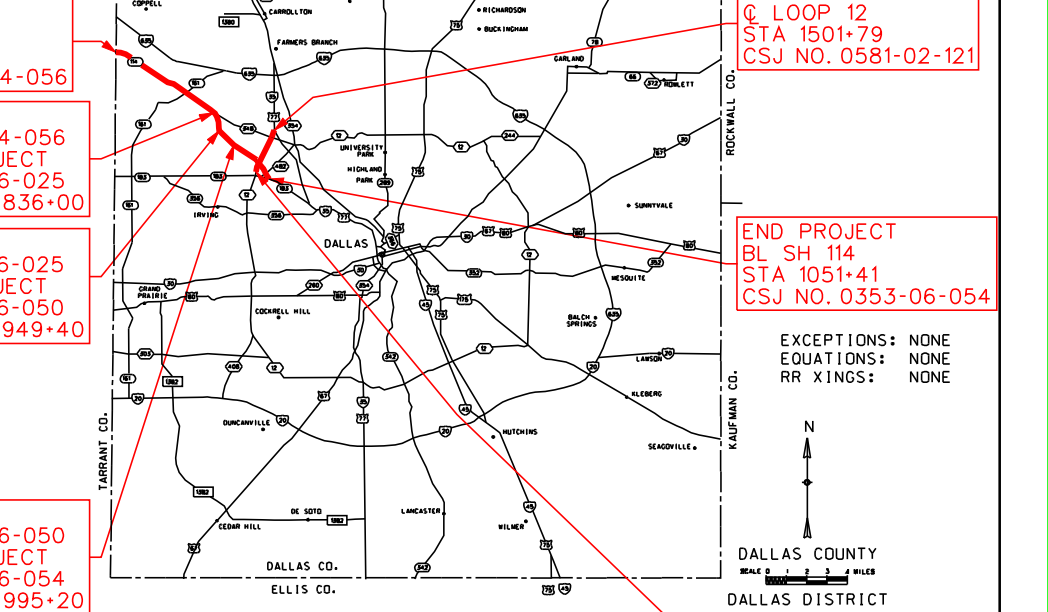

© 2009 BY TEXAS DEPARTMENT OF TRANSPORTATION: ALL RIGHTS RESERVED



PREPARED BY BRIDGEFARMER & ASSOCIATES, INC. UNDER THE SUPERVISION OF

STERLING C. FORSYTHE, III SHAHRIAR AZAD WEIYH TEE

P.E. NO. 57339 DATE: 05/11/09 P.E. NO. 91682 DATE: 05/11/09 P.E. NO. 98478 DATE: 05/11/09

BRIDGEFARMER & ASSOCIATES, INC. CONSULTING ENGINEERS TBPE REGISTRATION NO. 284 12801 NORTH CENTRAL EXPRESSWAY, 4TH FLOOR DALLAS, TEXAS 75243 TEL: (972) 231-8800 FAX: (972) 231-5900

Roll: 23 of 23
DATE APPROVED
DESIGN SCHEMATIC NOT INTENDED FOR CONSTRUCTION, BIDDING, OR PERMIT PURPOSES.
DATE SUBMITTED
DATE REVISED

